

## Datasheet of ESR 170 Air grinding spindle

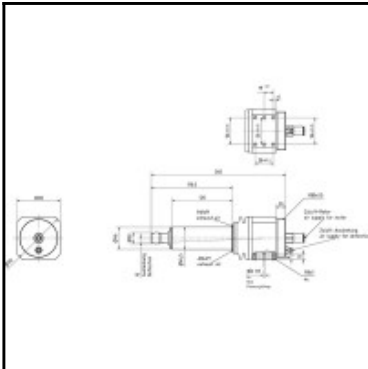

### Description

15.000 min<sup>-1</sup>, 800 Watt, for most powerful deburring tasks

- Large revolution speed and power ranges for different deburring tasks
- Easy to mount horizontally or vertically onto a tool stand due to cuboid housing
- Easy to mount to a robot arm by thread connection
- Highest true running accuracy, load capability and best deburring results due to paired ball bearings

All data related to 6.3 bar working pressure.

### Details

Idling speed rpm:	15000
Air supply:	lubricated
Power in kW:	800
Radial deflection:	+/- 4°
Direction of rotation:	Rotating clockwise
Exhaust Air:	to front
ER collet in mm:	8
Fully variable force of compliance in N:	25 - 110
Force of compliance max.* in N:	200
Noise level in dB(A):	82
Air consumption in l/s:	15
Accessories supplied:	Wrench
Anschluss Zuluftschlauch (Blitz) ø mm, innen \ außen:	6 \ 8
Item number:	60032405
Weight in kg:	5,15

### Dimensions