

## Datasheet of MRD 55-50 Air motor

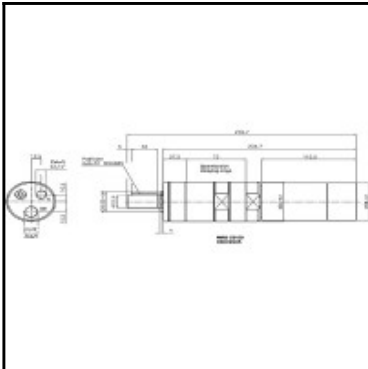

### Description

Air motor, rotating clockwise, speed under load 50 rpm, torque 118 Nm, start torque 177 Nm

The robustness distinguishes the air motor as unproblematic drive engine. It is well utilised in industrial sectors where accuracy and longevity are required. Its high starting torque and the wide torque range qualifies it for many needs in the drive section. All data related to 6.3 bar working pressure.

### Details

Speed under load in rpm:	50
Torque in Nm:	118
Start torque in Nm:	177
Idling speed rpm:	100
Non-lubricated:	No
Torque in Nm:	118
Power in kW:	0,62
Maximum torque in Nm:	236
Air consumption in l/s:	14,6
Shaft load Fr max. in N:	3900
Shaft load Fa max. in N:	1800
Direction of rotation:	Rotating clockwise
Resistant to stalling:	Yes
ATEX available:	Yes
Brake:	No
Material:	Stainless steel
Weight in kg:	5,5
Item number:	60009997

### Dimensions

Hose Inner diameter in mm:	10
----------------------------	----