

## Datasheet of MRD 55-300 F77 Air motor

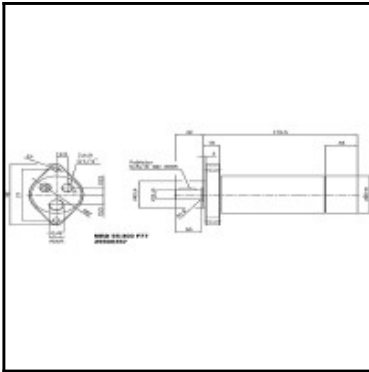

### Description

Air motor, rotating clockwise, speed under load 300 rpm, torque 20 Nm, start torque 30 Nm

The robustness distinguishes the air motor as unproblematic drive engine. It is well utilised in industrial sectors where accuracy and longevity are required. Its high starting torque and the wide torque range qualifies it for many needs in the drive section. All data related to 6.3 bar working pressure.

### Details

Speed under load in rpm:	300
Torque in Nm:	20
Start torque in Nm:	30
Idling speed rpm:	600
Non-lubricated:	No
Torque in Nm:	20
Power in kW:	0,62
Maximum torque in Nm:	39
Air consumption in l/s:	14,2
Shaft load Fr max. in N:	2100
Shaft load Fa max. in N:	1500
Direction of rotation:	Rotating clockwise
Resistant to stalling:	Yes
ATEX available:	Yes
Brake:	No
Material:	Stainless steel
Weight in kg:	1,8
Item number:	29906367

### Dimensions

Hose Inner diameter in mm:	10
----------------------------	----