

## Datasheet of 7995 10 17 Non-return valve

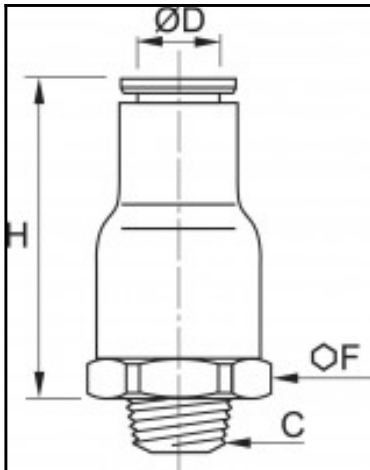

### Description

Non-return valves, exhaust-Non-return valve in-line, 10 mm - R3/8

Non-return valve with push-in connection, R-threads (exhaust flow):

- allow air to pass in one direction while blocking flow in the other direction
- Perfect sealing, compact and light weight, supply version

### Details

ØD:	10 mm
C:	R3/8"
F:	23
H:	42
Maximum working pressure in bar:	10
Seal coating:	PTFE
Material seal:	NBR
Material body:	Engineered polymer
Material threaded fitting:	Brass nickel plated
Material toothed washer:	Stainless steel
max. temperature in °C:	70
RoHS compliant:	Yes
Weight in kg:	0,048

### Dimensions

ØD:	10 mm
C:	R3/8"
F:	23
H:	42