

Datasheet of 7995 06 10 Non-return valve

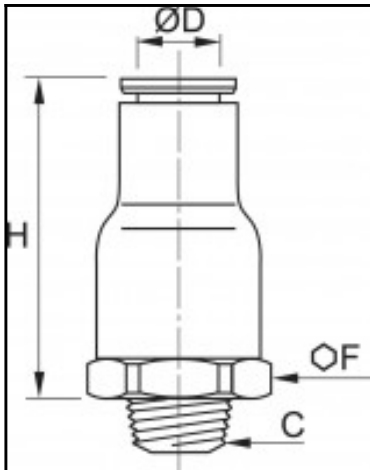

Description

Non-return valves, exhaust-Non-return valve in-line, 6 mm - R1/8

Non-return valve with push-in connection, R-threads (exhaust flow):

- allow air to pass in one direction while blocking flow in the other direction
- Perfect sealing, compact and light weight, supply version

Details

ØD:	6 mm
C:	R1/8"
F:	16
H:	30,5
Maximum working pressure in bar:	10
Seal coating:	PTFE
Material seal:	NBR
Material body:	Engineered polymer
Material threaded fitting:	Brass nickel plated
Material toothed washer:	Stainless steel
max. temperature in °C:	70
RoHS compliant:	Yes
Weight in kg:	0,016

Dimensions

ØD:	6 mm
C:	R1/8"
F:	16
H:	30,5