

Datasheet of 7822 00 21 Flow regulator



Description

Metal regulators, regulator in-line made of stainless steel, bi-directional, G1/2 - G1/2

throttle valve, threaded, made of stainless steel, bi-directional:

- for line installation
- Large adjustment screw and lock nut guaranteeing stability of adjustment
- Throttling of air supply and exhaust, no non-return function.
- ideally suited for aggressive atmospheres or environments submitted to severe chemical or mechanical constraints
- for all pneumatic applications or to convey fluids compatible with FKM and PTFE seals

Details

C:	G1/2"
H min:	76
H max:	87
H1:	40
K:	30
L:	60
L1:	30
N:	42
T:	30
Flow rate in l/min:	97
Bore in mm:	12
Maximum working pressure in bar:	40
Material seal:	FKM
Material adjusting spindle:	Stainless steel 316l
Material body:	Stainless steel 316l
Material seat seal:	PTFE
Material lever:	Stainless steel 316l
Material stem:	Stainless steel 316l
min. temperature in °C:	-15
max. temperature in °C:	120
RoHS compliant:	Yes
Weight in kg:	0,266

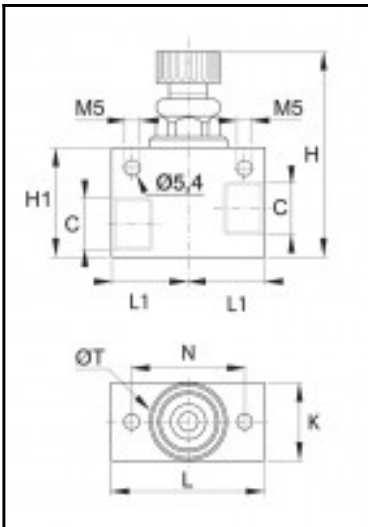

Dimensions

C:	G1/2"
H min:	76
H max:	87
H1:	40
K:	30
L:	60
L1:	30
N:	42
T:	30