

## Datasheet of 7822 00 10 Flow regulator



### Description

Metal regulators, regulator in-line made of stainless steel, bi-directional, G1/8 - G1/8

throttle valve, threaded, made of stainless steel, bi-directional:

- for line installation
- Large adjustment screw and lock nut guaranteeing stability of adjustment
- Throttling of air supply and exhaust, no non-return function.
- ideally suited for aggressive atmospheres or environments submitted to severe chemical or mechanical constraints
- for all pneumatic applications or to convey fluids compatible with FKM and PTFE seals

### Details

C:	G1/8"
H min:	48
H max:	52,5
H1:	30
K:	20
L:	40
L1:	20
N:	30
T:	20
Flow rate in l/min:	55
Bore in mm:	7
Maximum working pressure in bar:	40
Material seal:	FKM
Material adjusting spindle:	Stainless steel 316l
Material body:	Stainless steel 316l
Material seat seal:	PTFE
Material lever:	Stainless steel 316l
Material stem:	Stainless steel 316l
min. temperature in °C:	-15
max. temperature in °C:	120
RoHS compliant:	Yes
Weight in kg:	0,176

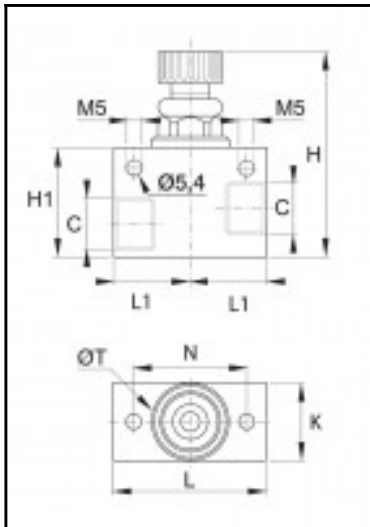

### Dimensions

C:	G1/8"
H min:	48
H max:	52,5
H1:	30
K:	20
L:	40
L1:	20
N:	30
T:	20