

Datasheet of 7771 17 17 Flow regulator



Description

Polymer flow regulators, regulator in-line, uni-directional, -

Non-return throttle valve, threaded, made of plastic, for line installation:

- with female thread, G-thread, uni-directional
- prevention against unwanted adjustment with a lock nut
- small and lightweight for easy installation
- versatile

Details

C:	G3/8"
F:	19
F1:	14
H min:	52
H max:	61
L:	97
L1:	33
N:	26
N1:	16
T:	4,2
Maximum working pressure in bar:	10
Material seal:	NBR
Material adjusting spindle:	Brass nickel plated
Material body:	Engineered polymer
Material threaded fitting:	Brass nickel plated
Material locknut:	Brass nickel plated
max. temperature in °C:	70
RoHS compliant:	Yes
Weight in kg:	0,16

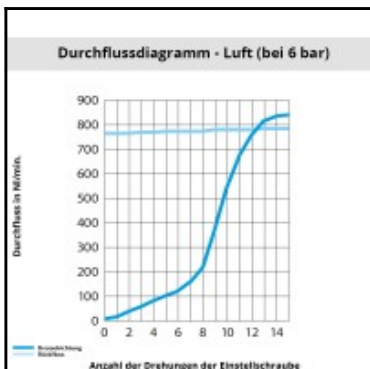
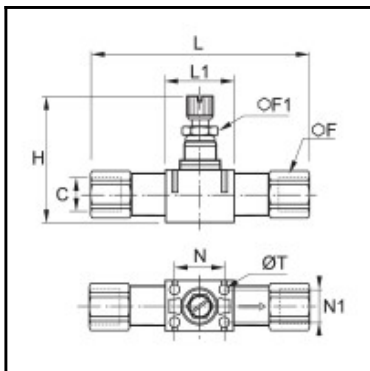

Dimensions

C:	G3/8"
F:	19
F1:	14
H min:	52
H max:	61
L:	97
L1:	33
N:	26
N1:	16
T:	4,2