

Datasheet of 7771 10 10 Flow regulator



Description

Polymer flow regulators, regulator in-line, uni-directional, -

Non-return throttle valve, threaded, made of plastic, for line installation:

- with female thread, G-thread, uni-directional
- prevention against unwanted adjustment with a lock nut
- small and lightweight for easy installation
- versatile

Details

C:	G1/8"
F:	13
F1:	8
H min:	39,5
H max:	44,5
L:	68,5
L1:	23
N:	17
N1:	11
T:	3,2
Maximum working pressure in bar:	10
Material seal:	NBR
Material adjusting spindle:	Brass nickel plated
Material body:	Engineered polymer
Material threaded fitting:	Brass nickel plated
Material locknut:	Brass nickel plated
max. temperature in °C:	70
RoHS compliant:	Yes
Weight in kg:	0,043

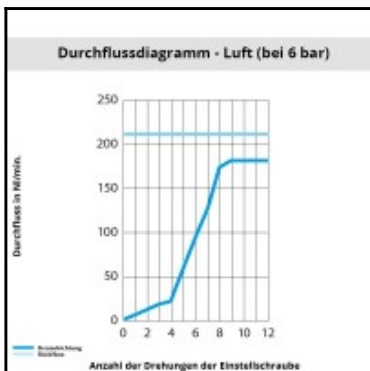
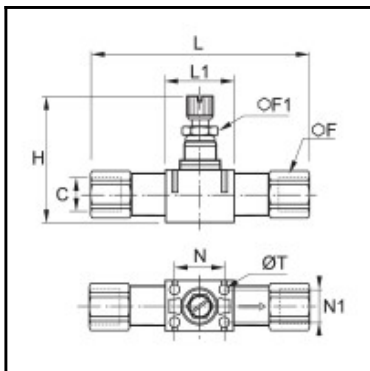

Dimensions

C:	G1/8"
F:	13
F1:	8
H min:	39,5
H max:	44,5
L:	68,5
L1:	23
N:	17
N1:	11
T:	3,2