

Datasheet of 7640 06 19 Flow regulator



Description

Polymer flow regulators, Miniature-Flow regulator, exhaust, made of polymer, 6 mm - M5x0,8

Non-return throttle valve, threaded, made of plastic:

- swivel outlet banjo with external screw and push-in connection, G- or metric thread
- external screw for throttling exhaust air
- reliable, precise and progressive adjustment
- lock nut guaranteeing stability of adjustment
- perfectly suited to solve the most difficult connection issues thanks to its orientability
- perfectly adapted to solve the most difficult connection issues thanks to its orientability and small size

Details

ØD:	6 mm
C:	M5x0,8
F:	6
G:	10,5
H min:	23,5
H max:	26
H1:	16
H2:	6,5
L:	21
Maximum working pressure in bar:	10
Material seal:	NBR
Material adjusting spindle:	Brass nickel plated
Material body:	Engineered polymer
Material locknut:	Brass nickel plated
Material toothed washer:	Stainless steel
max. temperature in °C:	70
RoHS compliant:	Yes
Weight in kg:	0,001

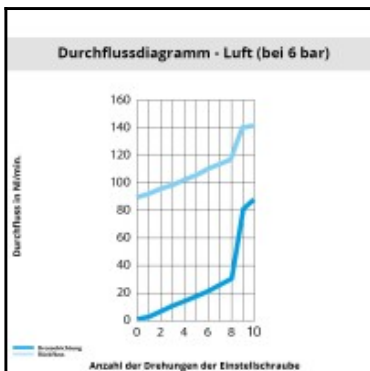
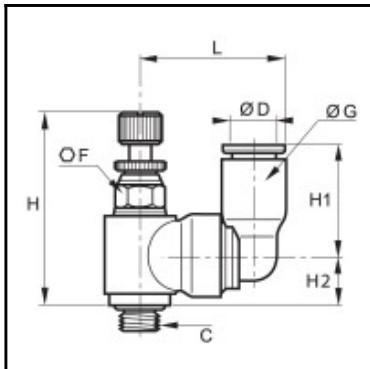

Dimensions

ØD:	6 mm
C:	M5x0,8
F:	6
G:	10,5
H min:	23,5
H max:	26
H1:	16
H2:	6,5
L:	21