

Datasheet of 7111 10 10 Flow regulator



Description

Metal regulators, Compact flow regulator, supply, made of metal, G1/8 - G1/8

Non-return throttle valve, threaded, made of metal:

- with female thread, G-thread
- external screw for throttling supply air
- lock nut guaranteeing stability of adjustment
- reliable, precise and progressive adjustment
- strong construction for improved longevity
- treated brass body extremely resistant to external aggressions - temperature, sparking, corrosion

Details

C:	G1/8"
F:	10
F1:	19
H min:	47
H max:	52,5
H1:	23
L:	22,5
Maximum working pressure in bar:	10
Material seal:	NBR
Material adjusting spindle:	Brass nickel plated
Material body:	Brass nickel plated
Material threaded fitting:	Brass nickel plated
Material locknut:	Brass nickel plated
max. temperature in °C:	70
RoHS compliant:	Yes
Weight in kg:	0,079

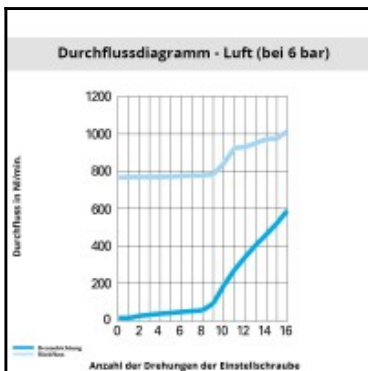
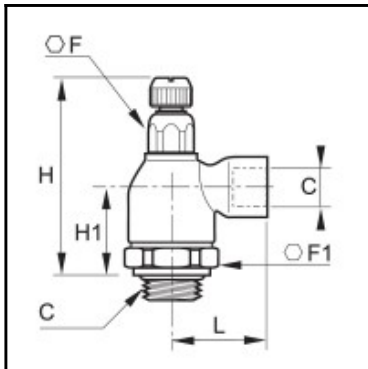

Dimensions

C:	G1/8"
F:	10
F1:	19
H min:	47
H max:	52,5
H1:	23
L:	22,5