

Datasheet of 7011 04 19 Flow regulator



Description

Polymer flow regulators, supply-regulator made of polymer, 4 mm - M5x0,8

Non-return throttle valve, threaded, made of plastic:

- banjo with threaded connections
- with recessed screw for throttling supply air
- reliable and progressive adjustment with a screwdriver guaranteeing stability of adjustment
- strong construction for improved longevity
- for use in all pneumatic installations due to their high performance capability and small size

Details

ØD:	4 mm
C:	M5x0,8
E:	4
F:	8
H:	17,5
L:	17
L1:	5
Maximum working pressure in bar:	10
Material seal:	NBR
Material adjusting spindle:	Brass nickel plated
Material body:	Engineered polymer
Material body 2:	Brass nickel plated
Material toothed washer:	Stainless steel
max. temperature in °C:	70
RoHS compliant:	Yes
Weight in kg:	0,006

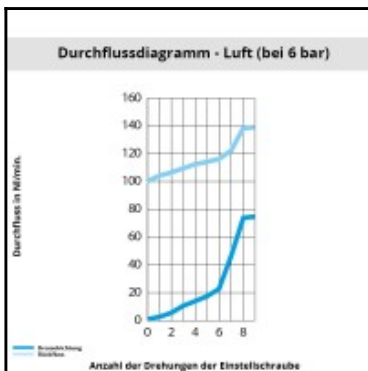
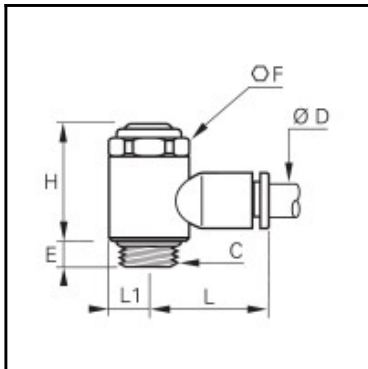

Dimensions

ØD:	4 mm
C:	M5x0,8
E:	4
F:	8
H:	17,5
L:	17
L1:	5