

Datasheet of 1870 22 22 Sleeve

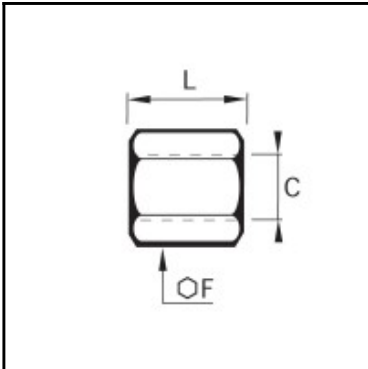

Description

Fittings Stainless steel, sleeve, female thread, NPT1/2

Connection of 2 female ports.

Details

C:	NPT1/2"
F:	27
L:	35
Maximum working pressure in bar:	150
Material body:	Stainless steel 316l
min. temperature in °C:	-20
max. temperature in °C:	180
RoHS compliant:	Yes
Weight in kg:	0,092

Dimensions

C:	NPT1/2"
F:	27
L:	35