

Datasheet of 1870 11 11 Sleeve

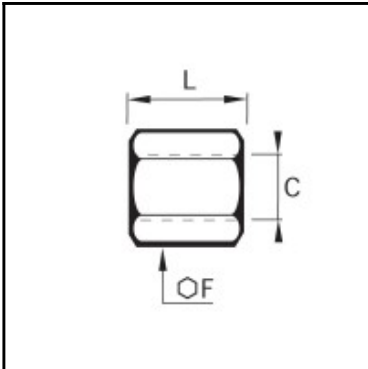

Description

Fittings Stainless steel, sleeve, female thread, NPT1/8

Connection of 2 female ports.

Details

C:	NPT1/8"
F:	14
L:	19
Maximum working pressure in bar:	150
Material body:	Stainless steel 316l
min. temperature in °C:	-20
max. temperature in °C:	180
RoHS compliant:	Yes
Weight in kg:	0,015

Dimensions

C:	NPT1/8"
F:	14
L:	19