

Datasheet of 1862 27 21 Sleeve

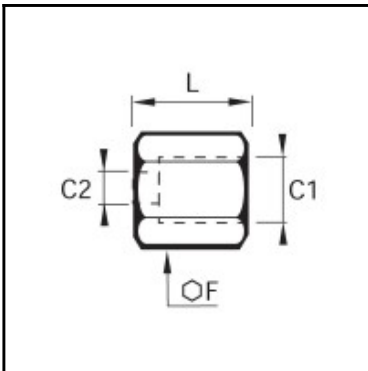

Description

Fittings Stainless steel, sleeve, female thread, G3/4 - G1/2

Used to connect 2 female items of different diameters.

Details

C1:	G3/4"
C2:	G1/2"
F:	32
L:	39,5
Maximum working pressure in bar:	150
Material body:	Stainless steel 316l
min. temperature in °C:	-20
max. temperature in °C:	180
RoHS compliant:	Yes
Weight in kg:	0,148

Dimensions

C1:	G3/4"
C2:	G1/2"
F:	32
L:	39,5