

## Datasheet of 1862 13 10 Sleeve

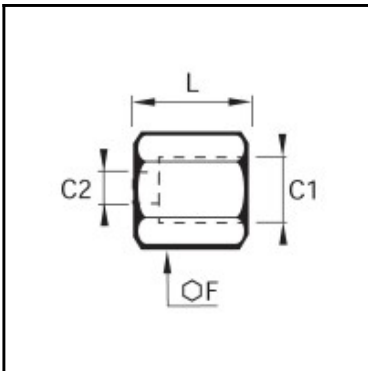

### Description

Fittings Stainless steel, sleeve, female thread, G1/4 - G1/8

Used to connect 2 female items of different diameters.

### Details

C1:	G1/4"
C2:	G1/8"
F:	17
L:	20,5
Maximum working pressure in bar:	150
Material body:	Stainless steel 316l
min. temperature in °C:	-20
max. temperature in °C:	180
RoHS compliant:	Yes
Weight in kg:	0,024

### Dimensions

C1:	G1/4"
C2:	G1/8"
F:	17
L:	20,5