

Datasheet of 0139 10 00 Bi-material captive sealing washer

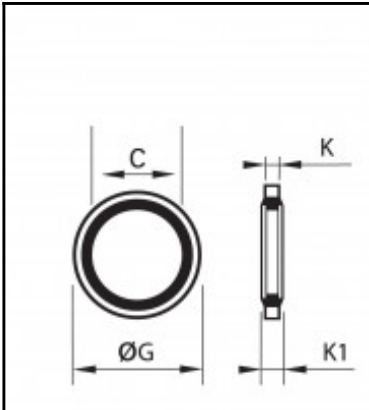

Description

Sealings, bi-material captive sealing washer, G1/8

Ensures perfect sealing of connection and provides high pressure resistance. captive bonded seal.

Details

C:	G1/8"
G:	14
K:	1
K1:	1,7
Maximum working pressure in bar:	20
Material body:	Galvanized steel with NBR seal
min. temperature in °C:	-10
max. temperature in °C:	80
RoHS compliant:	Yes
Weight in kg:	0,001

Dimensions

C:	G1/8"
G:	14
K:	1
K1:	1,7