

Datasheet of 0123 32 34 Quick-acting barbed fitting

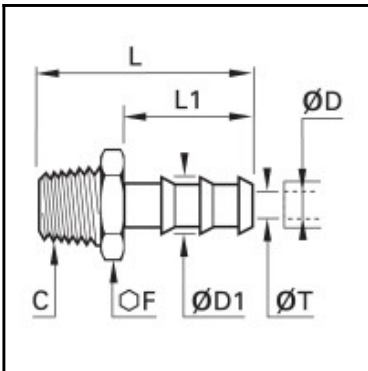

Description

Quick-acting barbed fittings made of brass, tailpiece adaptor, male thread, R1 - 32 mm

Quick connection of a hose to a male port. Available from 4 to 32 mm o.d..

Details

ØD:	32 mm
ØD1:	34,5 mm
C:	R1"
F:	36
L:	70
L1:	43
T:	24
Maximum working pressure in bar:	100
Material body:	Brass
min. temperature in °C:	-40
max. temperature in °C:	150
RoHS compliant:	Yes
Weight in kg:	0,142

Dimensions

ØD:	32 mm
ØD1:	34,5 mm
C:	R1"
F:	36
L:	70
L1:	43
T:	24