

Datasheet of 0690 10 00 Blowgun



Description

Blowguns, Venturi-nozzle, M12x1,25

VENTURI-nozzle. Features:

- Especially suited for use with large areas thanks to its large air flow
- Offers energy savings by venturi method of increasing air flow
- throttled air speed

Details

C:	M12x1,25
G:	15
L:	64
L1:	42
Bore in mm:	2,5
Maximum working pressure in bar:	10
Material body:	Brass nickel plated
min. temperature in °C:	-15
max. temperature in °C:	50
RoHS compliant:	Yes
Weight in kg:	0,038

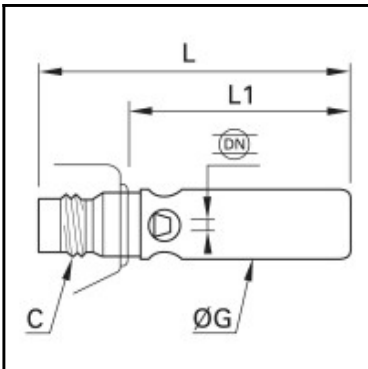

Dimensions

C:	M12x1,25
G:	15
L:	64
L1:	42

