

## Datasheet of 4021 56 14WP2 Ball valve

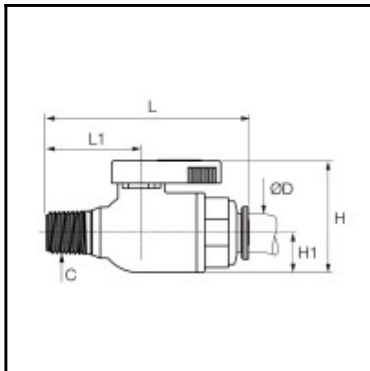

### Description

Ball valves LIQUIFIT, 2/2-way ball valve LIQUIfit®, 1/4 - 1/4 NPT

Full flow.

Full-flow self-cleaning ball maintains the cleanliness of the circuit

Carstick connection providing resistance to water hammer

Inert technical polymer providing the best mechanical strength, thermal and chemical resistance  
FDA, NSF 51, meet WQA (Water Quality Association) requirements.

### Details

ØD:	1/4"
C:	1/4 NPT"
Material seal:	EPDM
Material body:	Polypropylene with glass fibers
Material lever:	Polyamide
Material stem:	Polysulfone
Material toothed washer:	Stainless steel
min. temperature in °C:	-15
max. temperature in °C:	100
RoHS compliant:	Yes
Weight in kg:	0,029

### Dimensions

ØD:	1/4"
C:	1/4 NPT"