

Datasheet of 0695 12 17 Push-in-fitting

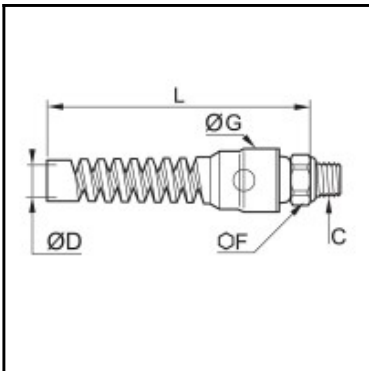

Description

Push-in-Fitting with protection spring, 12 mm - R3/8

Guarantees long-term connection thanks to the retention of the tube by the protection ring.
Enables tube length adjustment or disconnection without thread disassembly thanks to the push-in connection design of the protection spring.

Details

ØD:	12 mm
C:	R3/8"
F:	20
G:	29,5
L:	126
Maximum working pressure in bar:	20
Material seal:	NBR
Material spring:	Engineered polymer
Material body:	Brass nickel plated
Material toothed washer:	Stainless steel
min. temperature in °C:	-20
max. temperature in °C:	60
RoHS compliant:	Yes
Weight in kg:	0,09

Dimensions

ØD:	12 mm
C:	R3/8"
F:	20
G:	29,5
L:	126