

Datasheet of 0695 10 13 Push-in-fitting

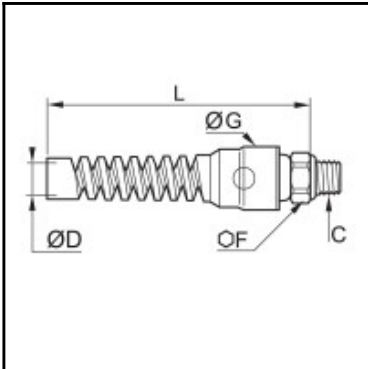

Description

Push-in-Fitting with protection spring, 10 mm - R1/4

Guarantees long-term connection thanks to the retention of the tube by the protection ring.
Enables tube length adjustment or disconnection without thread disassembly thanks to the push-in connection design of the protection spring.

Details

| | |
|----------------------------------|---------------------|
| ØD: | 10 mm |
| C: | R1/4" |
| F: | 18 |
| G: | 24 |
| L: | 106,5 |
| Maximum working pressure in bar: | 20 |
| Material seal: | NBR |
| Material spring: | Engineered polymer |
| Material body: | Brass nickel plated |
| Material toothed washer: | Stainless steel |
| min. temperature in °C: | -20 |
| max. temperature in °C: | 60 |
| RoHS compliant: | Yes |
| Weight in kg: | 0,064 |

Dimensions

| | |
|-----|-------|
| ØD: | 10 mm |
| C: | R1/4" |
| F: | 18 |
| G: | 24 |
| L: | 106,5 |