

Datasheet of 0695 08 13 Push-in-fitting

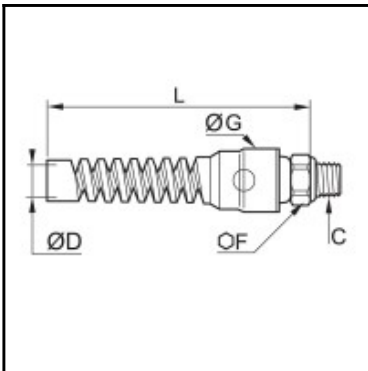

Description

Push-in-Fitting with protection spring, 8 mm - R1/4

Guarantees long-term connection thanks to the retention of the tube by the protection ring.
Enables tube length adjustment or disconnection without thread disassembly thanks to the push-in connection design of the protection spring.

Details

ØD:	8 mm
C:	R1/4"
F:	14
G:	24
L:	104,5
Maximum working pressure in bar:	20
Material seal:	NBR
Material spring:	Engineered polymer
Material body:	Brass nickel plated
Material toothed washer:	Stainless steel
min. temperature in °C:	-20
max. temperature in °C:	60
RoHS compliant:	Yes
Weight in kg:	0,055

Dimensions

ØD:	8 mm
C:	R1/4"
F:	14
G:	24
L:	104,5