

Datasheet of 25KBTS06BPX Quick coupling with hose barb in panel mount

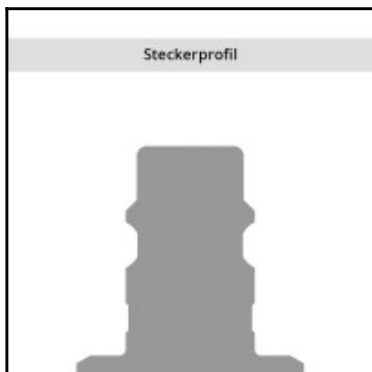
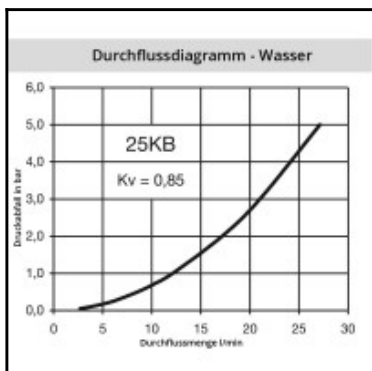
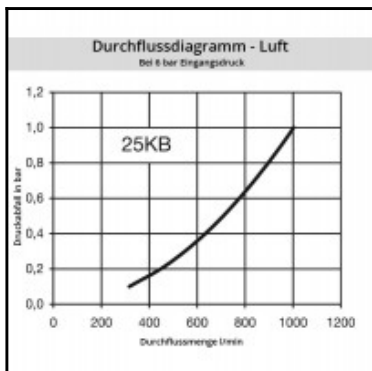
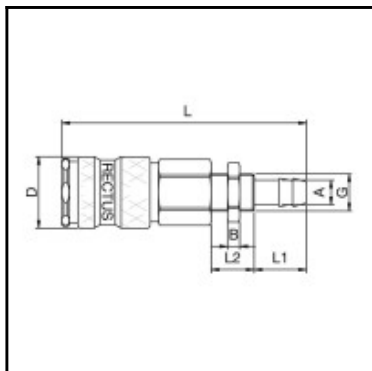

Description

Quick coupling double shut-off, panel mount with hose barb 6mm (1/4), nominal diameter 7,4, <35 bar, brass, seal NBR

Universal industrial coupling with standard European profile. Coupling system with single-hand operation. UltraFlo valve for optimum flow and low pressure drop. The series stands out for its robust design and long service life even with the harshest use.

Details

| | |
|---|--|
| Series: | 25 |
| Series long: | 25KB |
| Bore in mm: | 7,4 |
| Bore area in mm²: | 42 |
| Advantages: | One-hand operation. Robust structure. UltraFlo valve. The collar design minimises damage to the valve body. |
| Working pressure: | 35 bar maximum static working pressure with safety factor 4 to 1. |
| Working temperature: | -20°C up to +100°C (NBR) -40°C up to +120/150°C (EPDM) -15°C up to +200°C (FKM) 0°C up to +316°C (FFKM) depending on the medium. |
| Shut-Off: | Quick coupling Double Shut-Off |
| Connection: | Hose barb in Panel mount 6mm LW(1/4") |
| Connection description: | Hose barb in Panel mount 6mm LW(1/4") |
| Connection type: | Hose barb |
| Material: | Brass |
| Material description: | Brass CuZn39Pb3 2.0401 (completely) |
| Seal description: | Nitrite-butadiene rubber |
| Surface: | blank finish |
| Material connection: | Brass |
| Material valve body: | Brass |
| Material sleeve: | Brass |
| Material valve: | Brass |
| Material spring snap ring: | stainless steel AISI 301 |
| Material balls/pins: | Stainless steel AISI 420 |
| Material seal: | Perbunan® |
| Weight in kg: | 0,1085 |
| Self-venting coupling: | No |
| Safety locking system: | No |
| Single-hand operation: | Yes |
| Two-hand operation: | No |
| Ball locking: | Yes |
| Pin lock: | No |
| Ultra-FLO-valve: | No |
| Vacuum suitable: | No |
| Water-resistant: | Yes |
| Flat-sealing: | No |
| Suitable breath / respiratory protection: | No |
| Pressure eliminator: | No |
| Hydraulics: | No |
| Pneumatics: | Yes |
| Standard product: | No |
| Mould coupling: | No |

Dimensions

| | |
|---------------|----------|
| Connection A: | 6 mm |
| B mm: | 4 |
| D mm: | 23 |
| G mm: | M 12 x 1 |
| L mm: | 76 |
| L1 mm: | 17 |
| L2 mm: | 10 |
| SW mm: | 19 |
| SW1 mm: | 17 |