

## Datasheet of 0126 04 00 Blanking plug

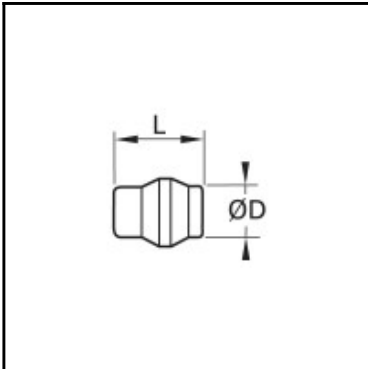

### Description

Compression fittings made of brass, Plug for compression fittings, 4 mm

Used to cap off tubing in a compression fitting. The plug replaces the sleeve. Available from 4 to 28 mm o.d..

### Details

ØD:	4 mm
L:	10
Maximum working pressure in bar:	550
Material body:	Brass
min. temperature in °C:	-60
max. temperature in °C:	250
RoHS compliant:	Yes
Weight in kg:	0,002

### Dimensions

ØD:	4 mm
L:	10