

Datasheet of 0125 08 00 Tube end plug

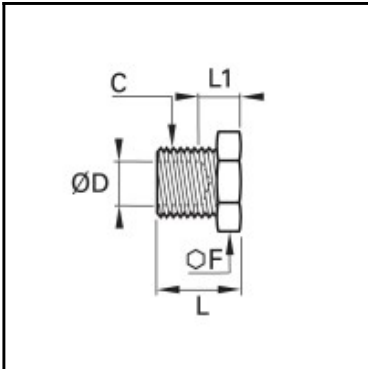

Description

Compression fittings made of brass, Tube end plug for compression fittings, 8 mm - M12x1

Used to cap off unused tubing, comprising a sleeve and a nut in a compression fitting. Available from 4 to 14 mm o.d..

Details

ØD:	8 mm
C:	M12x1
F:	14
L:	14
L1:	9
Maximum working pressure in bar:	550
Material body:	Brass
min. temperature in °C:	-60
max. temperature in °C:	250
RoHS compliant:	Yes
Weight in kg:	0,012

Dimensions

ØD:	8 mm
C:	M12x1
F:	14
L:	14
L1:	9