

Datasheet of 0119 22 27 39 Double banjo elbow connection



Description

Compression fittings made of brass, Double banjo connection, 2 x 22 mm - G3/4

Single banjo elbow connection between tube and male thread, mit bonded seal. In space constrained environments it can be mounted from above with a spanner. Available form 4 to 22 mm o.d..

Details

ØD:	22 mm
C:	G3/4"
F:	32
F1:	36
H:	54
H1:	22,5
L1:	24,5
N:	39
Maximum working pressure in bar:	550
Material seal ring:	Galvanized steel with NBR seal
Material adjusting spindle:	Brass
Material body:	Brass
Material gripping ring:	Brass
Material union nut:	Brass
min. temperature in °C:	-60
max. temperature in °C:	250
RoHS compliant:	Yes
Weight in kg:	0,61

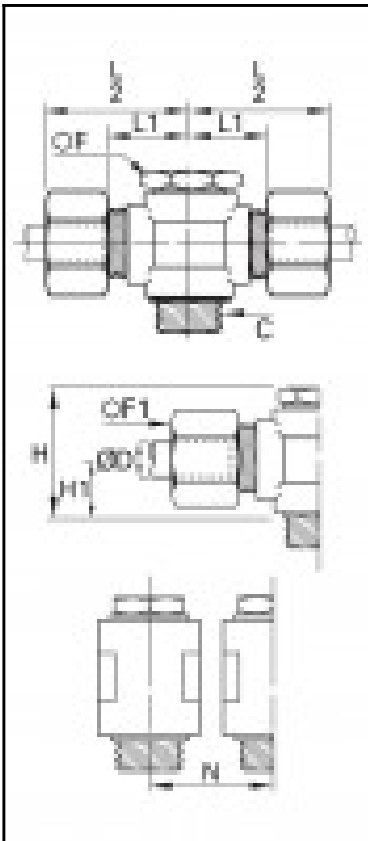

Dimensions

ØD:	22 mm
C:	G3/4"
F:	32
F1:	36
H:	54
H1:	22,5
L1:	24,5
N:	39