

Datasheet of 0119 14 13 39 Double banjo elbow connection



Description

Compression fittings made of brass, Double banjo connection, 2 x 14 mm - G1/4

Single banjo elbow connection between tube and male thread, mit bonded seal. In space constrained environments it can be mounted from above with a spanner. Available form 4 to 22 mm o.d..

Details

ØD:	14 mm
C:	G1/4"
F:	17
F1:	24
H:	36
H1:	16
L1:	20,5
N:	28
Maximum working pressure in bar:	550
Material seal ring:	Galvanized steel with NBR seal
Material adjusting spindle:	Brass
Material body:	Brass
Material gripping ring:	Brass
Material union nut:	Brass
min. temperature in °C:	-60
max. temperature in °C:	250
RoHS compliant:	Yes
Weight in kg:	0,248

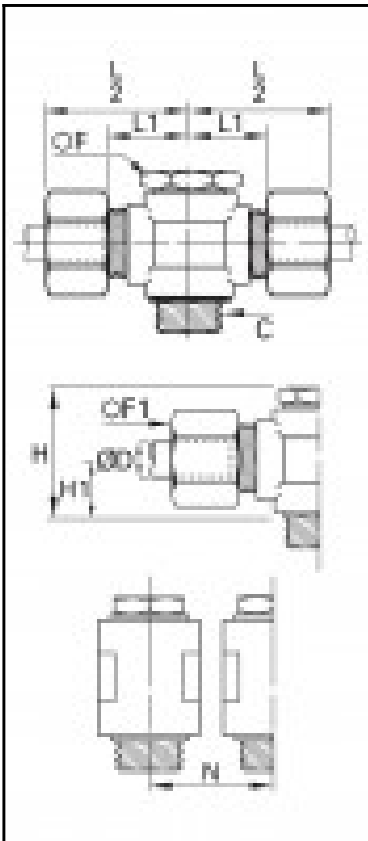

Dimensions

ØD:	14 mm
C:	G1/4"
F:	17
F1:	24
H:	36
H1:	16
L1:	20,5
N:	28