

Datasheet of 0119 08 17 39 Double banjo elbow connection



Description

Compression fittings made of brass, Double banjo connection, 2 x 8 mm - G3/8

Single banjo elbow connection between tube and male thread, mit bonded seal. In space constrained environments it can be mounted from above with a spanner. Available form 4 to 22 mm o.d..

Details

ØD:	8 mm
C:	G3/8"
F:	22
F1:	14
H:	31,5
H1:	13,5
L1:	18
N:	26,5
Maximum working pressure in bar:	550
Material seal ring:	Galvanized steel with NBR seal
Material adjusting spindle:	Brass
Material body:	Brass
Material gripping ring:	Brass
Material union nut:	Brass
min. temperature in °C:	-60
max. temperature in °C:	250
RoHS compliant:	Yes
Weight in kg:	0,135

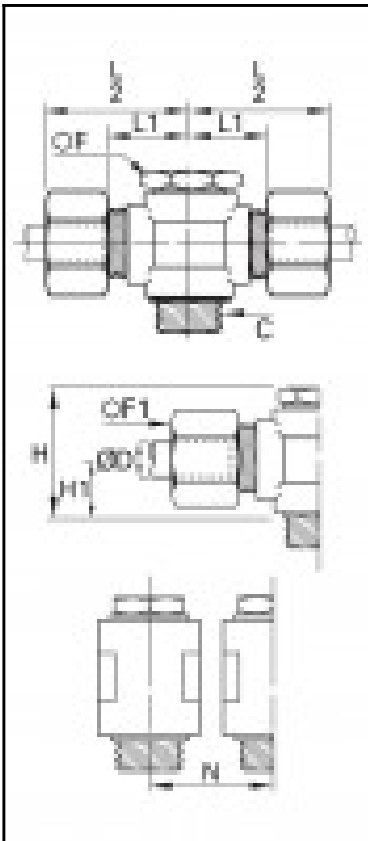

Dimensions

ØD:	8 mm
C:	G3/8"
F:	22
F1:	14
H:	31,5
H1:	13,5
L1:	18
N:	26,5