

Datasheet of 0119 06 13 Double banjo elbow connection

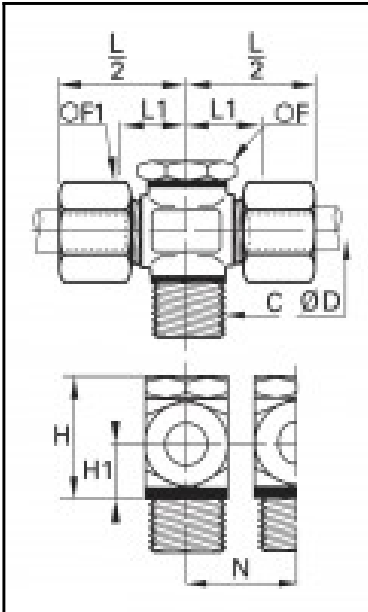

Description

Compression fittings made of brass, Double banjo connection, 2 x 6 mm - G1/4

Single banjo elbow connection between tube and male thread. In space constrained environments it can be mounted from above with a spanner. Available form 4 to 22 mm o.d..

Details

ØD:	6 mm
C:	G1/4"
F:	17
F1:	13
H:	25
H1:	10
L1:	16
N:	21
Maximum working pressure in bar:	550
Material seal ring:	Engineered polymer
Material adjusting spindle:	Brass
Material body:	Brass
Material gripping ring:	Brass
Material union nut:	Brass
min. temperature in °C:	-60
max. temperature in °C:	250
RoHS compliant:	Yes
Weight in kg:	0,038

Dimensions

ØD:	6 mm
C:	G1/4"
F:	17
F1:	13
H:	25
H1:	10
L1:	16
N:	21