

Datasheet of 0112 05 00 Extended sleeve nut

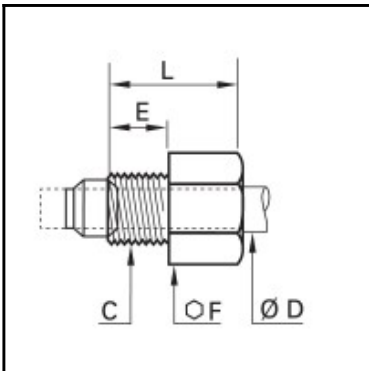

Description

Compression fittings made of brass, Extended Sleeve nut for compression fittings, 5 mm - M10x1

Male nut for standard sleeve. More compact built compared to a male thread. Available from 4 to 14 mm o.d..

Details

ØD:	5 mm
C:	M10x1
E:	7,5
F:	11
L:	13,5
Maximum working pressure in bar:	550
Material body:	Brass
min. temperature in °C:	-60
max. temperature in °C:	250
RoHS compliant:	Yes
Weight in kg:	0,007

Dimensions

ØD:	5 mm
C:	M10x1
E:	7,5
F:	11
L:	13,5