

## Datasheet of 0112 04 00 Extended sleeve nut

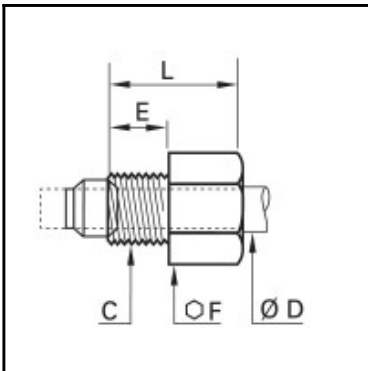

### Description

Compression fittings made of brass, Extended Sleeve nut for compression fittings, 4 mm - M8x1

Male nut for standard sleeve. More compact built compared to a male thread. Available from 4 to 14 mm o.d..

### Details

ØD:	4 mm
C:	M8x1
E:	7
F:	10
L:	13
Maximum working pressure in bar:	550
Material body:	Brass
min. temperature in °C:	-60
max. temperature in °C:	250
RoHS compliant:	Yes
Weight in kg:	0,005

### Dimensions

ØD:	4 mm
C:	M8x1
E:	7
F:	10
L:	13