

Datasheet of 0101 16 17 Male stud coupling

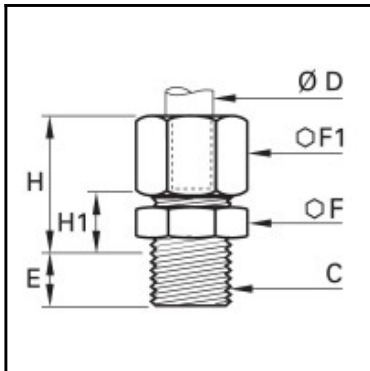

Description

Compression fittings made of brass, male stud coupling, 16 mm - G3/8

In-line connection of a tubing with male thread. Available from 4 to 28 mm o.d., BSPT metric thread.

Details

ØD:	16 mm
C:	G3/8"
E:	11
F:	22
F1:	27
H max:	27
H1:	12
Maximum working pressure in bar:	550
Material seal ring:	Engineered polymer
Material body:	Brass
Material gripping ring:	Brass
Material union nut:	Brass
min. temperature in °C:	-60
max. temperature in °C:	250
RoHS compliant:	Yes
Weight in kg:	0,091

Dimensions

ØD:	16 mm
C:	G3/8"
E:	11
F:	22
F1:	27
H max:	27
H1:	12