

## Datasheet of 0101 12 21 Male stud coupling

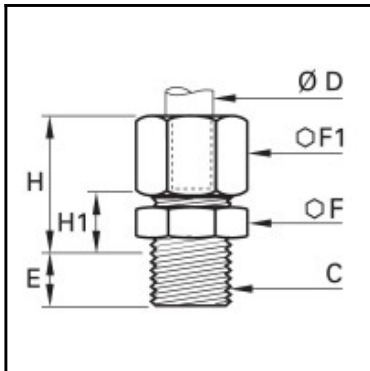

### Description

Compression fittings made of brass, male stud coupling, 12 mm - G1/2

In-line connection of a tubing with male thread. Available from 4 to 28 mm o.d., BSPT metric thread.

### Details

ØD:	12 mm
C:	G1/2"
E:	12
F:	27
F1:	22
H max:	24
H1:	12
Maximum working pressure in bar:	550
Material seal ring:	Engineered polymer
Material body:	Brass
Material gripping ring:	Brass
Material union nut:	Brass
min. temperature in °C:	-60
max. temperature in °C:	250
RoHS compliant:	Yes
Weight in kg:	0,089

### Dimensions

ØD:	12 mm
C:	G1/2"
E:	12
F:	27
F1:	22
H max:	24
H1:	12