

Datasheet of 0101 08 13 Male stud coupling

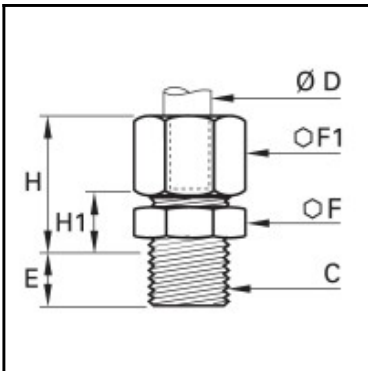

Description

Compression fittings made of brass, male stud coupling, 8 mm - G1/4

In-line connection of a tubing with male thread. Available from 4 to 28 mm o.d., BSPT metric thread.

Details

ØD:	8 mm
C:	G1/4"
E:	8
F:	17
F1:	14
H max:	19,5
H1:	9
Maximum working pressure in bar:	550
Material seal ring:	Engineered polymer
Material body:	Brass
Material gripping ring:	Brass
Material union nut:	Brass
min. temperature in °C:	-60
max. temperature in °C:	250
RoHS compliant:	Yes
Weight in kg:	0,031

Dimensions

ØD:	8 mm
C:	G1/4"
E:	8
F:	17
F1:	14
H max:	19,5
H1:	9