

DOTCO®

Material Removal Tools



Model Number Index

Model	Page	Model	Page	Model	Page	Model	Page	Model	Page
10B1200-32	43	10N1081-36	13	12L1300-32	43	12L2580-01RT	67	12R0410-13	10
10B2500-01	16	10N2080-01	14	12L1300-36	21,43	12L2580-36	15	12R0410-16	10
10L1000-36	13	10N9500-36	8	12L1300-36RT	66	12L2582-01	15	12R0410-18	10
10L1001-36	13	10R0400-13	9	12L1301-32	43	12L2582-0124RT	67	12R0410-43	10
10L1003-36	13	10R0400-18	9	12L1301-36	21,43	12L2582-01RT	67	12R0500-36	12
10L1080-36	13	10R0401-13	9	12L1302-36	21,43	12L2592-01	47	12R9180-03	8
10L1081-36	13	10R0401-16	9	12L1380-36	21,43	12L2593-01	47	12R9180-08	8
10L1082-36	13	10R0401-18	9	12L1380-36RT	66	12L2594-01	47	12R9180-43	8
10L1097-36	13	10R0401-43	9	12L1381-36	21,43	12L2600-01	18	12R9180-48	8
10L1100-36	17	10R0412-18	9	12L1381-36RT	66	12L2602-01	18	12S1008-36	12
10L1101-36	17	10R0414-43	9	12L1382-36	21,43	12L2662-01	18	12S1206-02	71
10L1111-36	17	10R9000-03	8	12L1382-36B2	46	12L2668-01	18	12S1207-02	71
10L1112-36	17	10R9000-08	8	12L1382-36B4	46	12L2680-01	18	12S1273-03	71
10L1180-36	17	10T4309-62	68	12L2000-01	13	12L2682-01	18	12S1274-03	71
10L1181-36	17	10T4316-62	68	12L2000-01RT	66	12L2714-28	26	12S1282-02	71
10L1200-32	43	10T4318-62	68	12L2001-01	13	12L2718-28	26	12S1283-02	71
10L2000-01	14	11T4309-62	68	12L2001-01RT	66	12L2718-36	24	12S1288-02	71
10L2000-01RT	67	11T4316-62	68	12L2002-01	13	12L2718-36RT	66	12S1289-02	71
10L2000-36	14	11T4318-62	68	12L2003-01	13	12L2750-01	23	12S2674-1A	18
10L2002-36	14	12B2080-01	13	12L2062-96	79	12L2750-80	45,48	12S2674-2A	18
10L2005-01	14	12L1000-36	12	12L2065-90	71	12L2751-01	23	12S2674-2C	18
10L2080-01	14	12L1000-36RT	66	12L2080-01	13	12L2751-80	45	12S2674-3A	18
10L2080-36	14	12L1001-36	12	12L2080-01RT	66	12L2752-01	23	12S2674-3C	18
10L2081-01	14	12L1001-36RT	66	12L2081-01	13	12L2752-80	45	12S2674-4A	18
10L2082-01	14	12L1003-36	12	12L2081-01RT	66	12L2760-80	45,48	12S2674-4C	18
10L2500-01	16	12L1010-36	79	12L2082-01	13	12L2761-80	45	12S2674-5A	18
10L2500-01RT	67	12L1028-36	12	12L2218-36	21,44	12L2762-80	45,48	12S2674-5C	18
10L2500-36	16	12L1031-36	79	12L2218-36RT	66	12L2776-36	24,44	12S2748-01	72
10L2502-01	16	12L1045-36	12	12L2240-90	71	12L2777-36	24,44	12S2749-01	72
10L2562-01	16	12L1046-36	12	12L2251-01	22	12L2778-36	24,44	12S2774-02	72
10L2565-01	16	12L1080-36	12	12L2251-80	44	12L2780-01	23	12S2775-01	72
10L2568-01	16	12L1081-36	12	12L2252-01	22	12L2782-01	23	12S2775-03	72
10L2580-01	16	12L1082-36	12	12L2277-36	21,44	12L4018-01	67	12S2790-02	72
10L2580-01RT	67	12L1088-01	47	12L2278-36	21,44	12L4018-03	67	12S2792-02	72
10L2580-36	16	12L1092-01	47	12L2384-01	21	12L4202-80	48	12S2793-02	72
10L2582-01	16	12L1093-01	47	12L2384-B1	46	12L4203-80	48	12S2794-01	72
10L2592-01	47	12L1100-36	17	12L2384-K1	46	12L4206-80	48	12S2794-02	72
10L2750-80	45,48	12L1101-36	17	12L2500-01	15	12L4207-80	48	12S4216-01	72
10L2751-80	45	12L1111-36	17	12L2500-01RT	67	12LF200-32	42	12S4217-01	72
10L2752-80	45	12L1112-36	17	12L2500-36	15	12LF200-36	20,42	12S4218-01	72
10L2760-80	45,48	12L1180-36	17	12L2502-01	15	12LF201-32	42	12S4225-01	72
10L4018-01	67	12L1181-36	17	12L2502-01RT	67	12LF201-36	20,42	12S4225-02	72
10L9500-36	8	12L1200-32	43	12L2542-01	15	12LF280-36	20,42	12S4225-03	72
10LF200-32	42	12L1201-32	43	12L2545-01	15	12LF281-36	20,42	135DPV-14B-50	56
10LF200-36	20,42	12L1201-36RT	66	12L2548-01	15	12R0380-13	9	135DPV-14B-51	56
10LF201-32	42	12L1280-32	43	12L2562-01	15	12R0380-18	9	135DPV-28B-51	56
10LF201-36	20,42	12L1280-36B2	46	12L2565-01	15	12R0380-43	9	135DPV-7B-43	56
10LF280-36	20,42	12L1281-32	43	12L2568-01	15	12R0400-13	10	135DPV-7B-50	56
10LF281-36	20,42	12L1281-36B2	46	12L2580-01	15	12R0400-18	10	136VGL-115-D3T4	25
10N1080-01	13	12L1281-36RT	66	12L2580-0124RT	67	12R0400-43	10	136VGL-135-D3T4	25

Model Number Index

Model	Page	Model	Page	Model	Page	Model	Page	Model	Page
136VGL-180-D3T3	25	14CNL97-51	55	15LF086-38	57	18G-810D	11	236GLS-115A-W3T4	29
136VGL-180-D3T4	25	14CNL97-53	55	15LF087-38	57	18G-810D-08	11	236GLS-180-C4	15
14CFS60-95	78	14CNL98-38	55	15LF087-40	57	1960HG-16	34	236GLS-240-C4	15
14CFS60-98	78	14CNL98-40	55	15LF281-52	59	1960HL-16	34	236GLSB-115A-W3T4	29
14CFS90-38	54	14CNL98-51	55	15LF281-62	58	216GLF-115A-C4	22	236GLSB-135A-D3T4	26
14CFS90-40	54	14CNL98-53	55	15LF282-52	59	216GLF-115A-D3T4	25	236GLSB-135A-W3T4	30
14CFS90-51	54	14CSL90-38	54	15LF282-62	58	216GLF-115A-D3T45	25	236GLSC-115A-C4	23
14CFS91-38	54	14CSL90-40	54	15LF283-52	59	216GLF-115A-W3T4	29	25GELC-120-C4	19
14CFS91-40	54	14CSL91-38	54	15LF283-62	58	216GLFB-135-W3T4	29	25GELC-120-W3T25	33
14CFS91-51	54	14CSL91-40	54	15LF284-52	59	216GLFB-135A-D3T4	25	25GELC-120-W3T3	33
14CFS92-38	54	14CSL92-38	54	15LF284-62	58	216GLFB-250-C4	14	25GELC-120-W3T4	33
14CFS92-40	54	14CSL92-40	54	15LF285-52	59	216GLFC-165A-C4	22	25GELC-140-P3T	32
14CFS92-51	54	14CSL95-40	54	15LF285-62	58	216GLSB-135A-D3T4	25	25GELC-140-W3T3	33
14CFS93-38	54	14CSL95-51	54	15LF286-52	59	216GLSB-135A-W3T4	29	25GELC-180-C4	19
14CFS93-40	54	14CSL97-40	54	15LF286-62	58	216GLSB-250-C4	14	25GELC-180-P3T	32
14CFS93-51	54	14CSL97-51	54	15LF287-52	59	216GLSC-165A-C4	22	25GELC-180-P5T	32
14CFS93-98	78	14CSL98-38	54	15LF287-62	58	220G-600-C2	10	25GELC-180-W3T3	33
14CFS93-99	78	14CSL98-40	54	15LN281-52	60	220G-600-C2-K	10	25GL-120-W3T4	33
14CFS94-38	54	14G-810	11	15LN281-62	59	220GL-600-C2	10	25GL-60A-D5T7	27
14CFS94-40	54	15DP-1.6B-53	56	15LN282-62	59	2260AGL-06	28,31	25GL-60A-W5T7	30
14CFS94-51	54	15DP-14B-49	56	15LN283-52	60	2260AGL-07	28,31	25GL-77A-D5T7	27
14CFS95-38	54	15DP-4B-53	56	15LN283-62	59	236GEL-240-C4	19	25GL-85A-D5T7	27
14CFS95-40	54	15DP-8B-53	56	15LN284-52	60	236GEL-240-P3T	32	25GL-85A-W5T7	30
14CFS95-51	54	15L1401-37	58	15LN284-62	59	236GELR-180-C4	19	3060AVL-06	35
14CFS96-38	54	15L1470-37	58	15LN285-52	60	236GELR-180-P3T	32	3060AVL-07	35
14CFS96-40	54	15L1471-37	58	15LN285-62	59	236GLF-115A-C4	23	3060AVL-09	35
14CFS96-51	54	15L1487-32	58	15LN286-52	60	236GLF-115A-D3T4	27	4060AVL-06	35
14CFS97-38	54	15L1487-36	58	15LN286-62	59	236GLF-115A-D3T45	27	4060AVL-07	35
14CFS97-40	54	15L1487-38	58	15LN288-52	60	236GLF-115A-W3T4	29	4060AVL-09	35
14CFS97-51	54	15L1488-36	58	15LN288-62	59	236GLF-180-C4	15	5120BHL-P	32
14CHL92-38	55	15L1488-38	58	15LS281-52	60	236GLF-250-C4	15	560BHL-16	34
14CHL92-40	55	15L1489-32	58	15LS281-62	59	236GLF-250-C6	15	560BHX-16	34
14CHL92-51	55	15L1489-36	58	15LS282-52	60	236GLFB-135A-D3T4	26	590BHL-P	32
14CHL92-53	55	15L1489-38	58	15LS282-62	59	236GLFB-135A-W3T4	30	B1-C-LT	76
14CHL98-38	55	15L1489-51	58	15LS283-52	60	236GLFC-165A-C4	23	B1-C-PT	75
14CHL98-40	55	15LF051-38	57	15LS283-62	59	236GLR-115A-C4	23	B1-CNB-LT-RD	75
14CHL98-51	55	15LF052-38	57	15LS284-62	59	236GLR-115A-D3T4	27	B1-CNB-LT-RD-K	75
14CHL98-53	55	15LF053-38	57	15LS285-52	60	236GLR-115A-D3T45	27	BR-C-LT	76
14CNL60-95	78	15LF054-38	57	15LS285-62	59	236GLR-115A-D3T5	27	CH-30-HX	76
14CNL90-38	55	15LF055-38	57	15LS286-52	60	236GLR-115A-D5T45	27	CH-30-HX-QC	76
14CNL90-40	55	15LF080-38	57	15LS286-62	59	236GLR-115A-W3T4	29	CH-30-RD	76
14CNL91-40	55	15LF081-38	57	15LS287-52	60	236GLR-180-C4	15	CH-30-RD-QC	76
14CNL91-51	55	15LF081-40	57	15LS287-62	59	236GLR-180-W3T4	33	F4-PT-RT-B	76
14CNL92-38	55	15LF082-38	57	15Z-710	11	236GLR-200-C4	15	SC3A	75
14CNL92-40	55	15LF082-40	57	15Z-720	11	236GLR-250-C4	15		
14CNL92-51	55	15LF083-38	57	1660AGL-04	28,31	236GLRB-135A-D3T4	26		
14CNL92-53	55	15LF083-40	57	1660AGL-05	28,31	236GLRB-135A-W3T4	30		
14CNL95-40	55	15LF084-38	57	1660AGL-05-M14	28,31	236GLRE-115A-D5T45	27		
14CNL95-51	55	15LF085-38	57	1660AGL-45	28,31	236GLS-115A-D3T4	27		
14CNL97-40	55	15LF085-40	57	1760HL-16	34	236GLS-115A-D5T45	27		

Model Number Index
 Tool Operation 2
Introduction 4



Grinders 6
 Precision 8
 Inline 12
 Right Angle 20
 Horizontal 32
 Vertical 35
 Grinder Accessories 36



Sanders 40
 Right Angle 42
 Belt 46
 Buffers | Polishers 47
 Sander | Buffer | Polisher Accessories 49



Drills 52
 Pistol Grip 54
 Inline 57
 Right Angle 58
 Drill Accessories 61



Specialty Tools 64
 Routers 66
 Router Accessories 69
 Saws 71
 Saw Accessories 73
 Percussion Tools 75
 Percussion Accessories 77
 Specialty Tools 78

General Accessories 80

Warranty

Apex Tool Group, LLC warrants products and parts sold by it, insofar as they are of its own manufacture, against defects of material and workmanship, under normal use and service in accordance with its written instructions, recommendations, and ratings for installation, operation, maintenance, and service of products, for a period of **ONE YEAR FROM THE DATE OF INITIAL USE, BUT IN NO EVENT SHALL THE WARRANTY EXCEED 24 MONTHS FROM DATE OF DELIVERY TO DISTRIBUTOR.**

Proof of Purchase with shipment date must be furnished by the user to validate the warranty. This warranty applies only to products manufactured by Apex Tool Group and specifically excludes products manufactured by others.

Products not manufactured by Apex Tool Group are warranted only to the extent and in the manner warranted to Apex Tool Group by the manufacturer and then only to the extent Apex Tool Group is

able to enforce such warranty. Apex Tool Group's warranty with respect to products manufactured by it is limited to the repair or replacement, as Apex Tool Group may elect, of any defective part regarding which the Distributor has given 5 days written notice from the discovery of such defect. Installation and transportation costs are not included.

Apex Tool Group shall have the option of requiring the return to it of the defective material, transportation prepaid, for inspection. No allowance will be made for repairs without Apex Tool Group's approval.

APEX TOOL GROUP MAKES NO OTHER WARRANTY OF ANY KIND WHATSOEVER, EXPRESSED OR IMPLIED, AND HEREBY DISCLAIMS ALL WARRANTIES OF MERCHANTABILITY AND FITNESS FOR A PARTICULAR PURPOSE.

Lubrication

Proper lubrication is essential to the economical operation of pneumatic and electric tools. Apex Tool Group products perform better and their life is extended by using the recommended lubricants. All lubricants that are listed in the accessory section of this catalog have undergone extensive testing and are recommended for use with Apex Tool Group products.

Safe Work Practices

WARNING

The signal word "WARNING" indicates a potentially hazardous situation which, if not avoided, may result in minor or moderate injury; and, identifies safe work practices in this operating instruction. Observe these notes and proceed with special care in these cases. Pass all safety instructions on to other users. In addition to these instructions, the general local safety and accident prevention rules must be observed.

⚠ WARNING



These Safety Instructions are not intended to be all inclusive. The operator should also read and understand the Product Manual for the specific tool.

⚠ WARNING

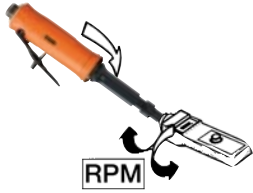

Before mounting any abrasive wheel, buffing wheel, wire brush, saw blade, flap wheel or other product, after all tool repairs and whenever a tool is issued for use, the rpm should be checked with a tachometer to insure that its actual speed does not exceed rated speed. Governed tools in use on the job should be checked at least once every twenty hours of use, or once weekly, whichever is more frequent. Tachometers must be checked and calibrated on a regular basis according to the manufacturer's recommendations.

⚠ WARNING

Test and operate tools at 90 PSIG (620 kPa/6.2 bar) maximum pressure (measured at the tool while the tool is running) unless tool is marked otherwise. Use air line filters – regulators – lubricators.

Always remove the air supply hose before working on the tool or changing accessories.

⚠ WARNING



Immediately shut off the tool if unusual sound or vibration is detected. Remove and inspect the wheel and check the tool speed (RPM).

Use of over-speeding grinder or unbalanced wheels may result in serious injury.

⚠ WARNING

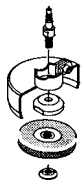

Each type of wheel, wire brush, saw blade, flap wheel, and other product, has specific mounting procedures and regulations concerning spindles, flanges, blotters, collets, etc., which should be used. Wheels must mount on tool's spindle freely but not loosely. Spindle nuts must be tightened so as not to crack the wheel with too much force. Nuts must have all thread engagement.

⚠ WARNING

Regularly inspect all wheels, etc., and discard cracked, chipped, or otherwise damaged units.

⚠ WARNING



Select proper guards for the application and mount securely and properly. Always mount guards so that abrasive debris, sparks, etc., are deflected away from the operator.

Safety guards should be in good condition. Any guard which has been subjected to a wheel failure should be discarded and replaced.

⚠ WARNING



Speed rating of abrasive wheel, buffing wheel, wire brush, saw blade, flap wheel, or other products used, must equal or exceed speed rating of tool.

Exceeding the speed of accessories may cause failure of these products and serious operator injury.

Wheels must clearly show the rated speed for its use, or must be discarded and not used.

⚠ WARNING



Wear impact resistant goggles or face shield at all times the tool is in operation. Other protective clothing should be worn, if necessary, for spark protection deflection.

⚠ WARNING



High sound levels can cause permanent hearing loss. Use hearing protection as required by the work environment and grinding application.

⚠ WARNING

Employ a safety program to provide inspection and maintenance of all phases of tool operation and air supply equipment in accordance with "Safety Code for Portable Air Tools," CAGI B186.1 and CAGI B7.1.

Make sure that all repairs are by trained personnel only and that these safety instructions are understood by the user.

⚠ WARNING

When mounting any grinding wheel, the tool should be run at operating speed with the safety guard in place, in a protected area such as under a work bench, for at least one minute. A damaged wheel should fail within that time.

Any suspect wheel of unknown origin should not be used and must be properly disposed.

Dotco: Tools that work with operators, not against them.

Performance

Known for their durability, dependability, and versatility, the Dotco brand is viewed as the premier line of material removal tools in the industrial marketplace. This is made possible by sound design and manufacturing techniques, producing tools that are small, comfortable and lightweight, yet can withstand the most rugged environments.

Ergonomics

Dotco tools are designed so their form follows their function. Simply, tools that are more comfortable for the operator to use...tools that work with operators and not against them...including composite housings, low vibration, and low noise.

Versatility

By using only a few motor types, a diverse line of Dotco products have been developed to handle a wide range of applications. These tools also have a high interchangeability of parts making maintenance easier and more affordable.

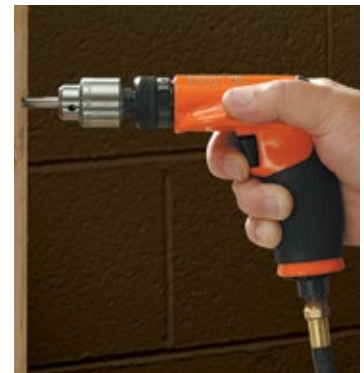

Dotco Quality

Quality Dotco power tools have been manufactured for over 75 years. Understandably, we are proud of our tools. Proud that they have become the industry standard.

ISO 9001 Certified

When we say our tools are built well, we really mean it. Our manufacturing processes are ISO 9001 certified... that means our products are manufactured to the highest standards.

Low Noise, Low Vibration

Noise and vibration of power tools in manufacturing is an important issue. Dotco tools have been designed to operate as quietly as possible, while providing substantial power. Vibration has been kept to a minimum by using precision parts and high quality bearings.

Precision Parts

It's simple, precision parts let operators manufacture precision products. Whether it is a spindle, a chuck, a motor or an angle head, our parts are manufactured from the finest materials available and are machined to the highest tolerances. It is understandable why we are proud of the .0005" runout on our collet model tools.



Parts Interchangeability

Maintenance of tools can be time consuming...and expensive. That is why our products have been designed with high parts interchangeability. With fewer parts required to repair our tools, less inventory of parts is required and tools are easier to repair.



GRINDERS

Performance, Versatility & Quality

When it comes to fine finishing applications such as die grinding or de-burring, no tools are better suited for the job than Dotco® grinders. Dotco's reputation for durability, dependability and versatility is among the highest for fine finishing applications. This is the result of years of continuous improvements in engineering design and manufacturing processes.

Dotco grinders are designed with the operator in mind. They are small, lightweight and comfortable to use, without sacrificing durability. Plus, they incorporate elastomer coatings, and perfectly balanced moving parts to keep vibration to a minimum. This optimal combination of tool characteristics allows the operator to focus doing the best job possible, in the least amount of time.

Tough tools for tough jobs

Cleco® grinders meet the demanding requirements of industries including shipbuilding, pipe fabricating, transportation equipment manufacturing, and welding applications. Since these types of applications typically require a high material removal rate, Cleco grinders incorporate high horsepower/high RPM motors.

To achieve maximum durability, Cleco grinders use top quality precision components and motor assemblies protected by all metal housings.



Grinder Abrasives Guide



Precision Grinders, Carbide Bur and Mounted Wheel Grinders

Used in finishing applications that require a high degree of durability.



Cone and Plug Wheels

Used for general purpose grinding work on mild steel, stainless steel, metal alloys, and cast steel.

Applications include:

- Grinding and smoothing fillets, corners
- Mild bending contours
- Beveling workpiece edges prior to welding
- General grinding in confined areas
- Internal grinding



Type 1 Wheels

Used on portable horizontal shaft tools.

Applications Include:

- Notch free grinding
- Pre-weld cleaning
- Smoothing out weld seams
- Grinding concrete or masonry products
- Removing seam lines from castings



Type 1 Cut-Off Wheels

Applications include cutting carbon and stainless steel, ferrous metals, and cast iron



Type 6 & 11 Cup Wheels

Used on right angle or vertical shaft tools.

- Type 6 – Straight Cup Wheels
- Type 11 – Flared Cup Wheels



Type 27/28 Depressed Center Wheels

Type 27 wheels are used at an angle to the workpiece between 30° and 45°.

These wheels do not "flat grind."

Type 28 wheels are saucer shaped wheels, which are contoured to provide a correct "built-in" grinding angle. Consequently, Type 28 wheels may be used for flat contact on the workpiece.



Inline Grinders
Page 12



Right Angle Grinders
Page 20



Precision Grinders
Page 8



Horizontal Grinders
Page 32



Vertical Grinders
Page 35

DOTCO® 10-90 Series - Turbine

100,000 RPM 0.06 hp (0.044 kW)

- Requires no air line lubrication - High precision ball bearings for long life expectancy
- Two-stage turbine motor with roll throttle
- Achieves a superb finish with its high speed and precision spindle
- Light weight and durable aluminum housing
- Low vibration and quiet operation minimizes operator fatigue



Cat. No.	Collet Size	Free Speed (rpm)	Abrasive Capacity	Type Housing	Weight	Length	Air Inlet Size
10R9000-03	3 mm	100,000	3/16" Carbide Burr, 3/16" Diamond Pin	Aluminum	0.5 lb 0.23 kg	5.4 in 137 mm	1/8 in
10R9000-08	1/8 in	100,000	3/16" Diamond Pin	Aluminum	0.5 lb 0.23 kg	5.4 in 137 mm	1/8 in

CAUTION: Use dry air at 90 psi maximum: **Do not lubricate turbine grinders.** Lubrication will be detrimental to the operation and life of turbine tools.
Do not attach a quick-disconnect fitting directly to the tool.
Standard Equipment: Applicable collet, collet wrenches, 7 ft./2.1 m air supply hose, replaceable cartridge hose filter.

DOTCO® 10-95 Series - Turbine

80,000 RPM 0.1 hp (0.074 kW)

- Requires no air line lubrication - High precision ball bearings for long life expectancy
- Maximizes productivity with two-stage turbine motor
- Achieves a superb finish with its high speed and precision spindle
- Light weight and durable aluminum housing
- Low vibration and quiet operation minimizes operator fatigue



Cat. No.	Collet Size	Throttle Type	Free Speed (rpm)	Abrasive Capacity	Type Housing	Weight	Length	Air Inlet Size
10L9500-36	1/8 in	Lever	80,000	1/4" Carbide Burr, 3/16" Diamond Pin	Aluminum	1.9 lb 0.86 kg	5.8 in 147 mm	1/4 in
10N9500-36*	1/8 in	None	80,000	1/4" Carbide Burr, 3/16" Diamond Pin	Aluminum	1.9 lb 0.86 kg	5.8 in 147 mm	1/4 in

* Tool will start with applied air, intended for fixtured applications;
CAUTION: Use dry air at 90 psi maximum: **Do not lubricate turbine grinders.** Lubrication will be detrimental to the operation and life of turbine tools.
Do not attach a quick-disconnect fitting directly to the tool.
Standard Equipment: Applicable collet, collet wrenches, 8 ft./2.4 m air supply hose, built-in air filter, speed regulator

DOTCO® 12R91 Series - Governed - Turbine

65,000 RPM 0.1 hp (0.074 kW)

- Requires no air line lubrication - High precision ball bearings for long life expectancy
- Two-stage turbine motor with roll throttle
- Achieves a superb finish with its high speed and precision spindle
- Light weight and durable composite housing
- Low vibration and quiet operation minimizes operator fatigue



Cat. No.	Collet Size	Free Speed (rpm)	Overhose	Abrasive Capacity	Type Housing	Weight	Length	Air Inlet Size
12R9180-03	3 mm	65,000	None	1/8" Carbide Burr, 1/8" Diamond Pin	Composite	0.4 lb 0.18 kg	5.8 in 147 mm	1/8 in
12R9180-08	1/8 in	65,000	None	1/8" Carbide Burr, 1/8" Diamond Pin	Composite	0.4 lb 0.18 kg	5.8 in 147 mm	1/8 in
12R9180-43	3 mm	65,000	4 ft 1.2 m	1/8" Carbide Burr, 1/8" Diamond Pin	Composite	0.4 lb 0.18 kg	5.8 in 147 mm	1/8 in
12R9180-48	1/8 in	65,000	4 ft 1.2 m	1/8" Carbide Burr, 1/8" Diamond Pin	Composite	0.4 lb 0.18 kg	5.8 in 147 mm	1/8 in

CAUTION: Use dry air at 90 psi maximum: **Do not lubricate turbine grinders.** Lubrication will be detrimental to the operation and life of turbine tools.
Do not attach a quick-disconnect fitting directly to the tool.
Standard Equipment: Applicable collet, collet wrenches, collet guard, 5 ft./1.5m air supply hose

DOTCO® 12-03 Series - Gearless Right Angle

80,000 RPM 0.1 hp (0.074 kW)

- Industrial bearing provides long life expectancy
- Designed for precision deburring and metal removal
- Compact and light weight composite housing
- Roll throttle equipped
- Includes over-hose



Cat. No.	Collet Size	Free Speed (rpm)	Overhose	Abrasive Capacity	Type Housing	Weight	Length	Air Inlet Size
12R0380-13	3 mm	80,000	1 ft 0.3 m	1/4" Carbide Burr, 1/4" Diamond Pin	Composite	0.3 lb 0.14 kg	5.5 in 140 mm	1/8 in
12R0380-18	1/8 in	80,000	1 ft 0.3 m	1/4" Carbide Burr, 1/4" Diamond Pin	Composite	0.3 lb 0.14 kg	5.5 in 140 mm	1/8 in
12R0380-43	3 mm	80,000	4 ft 1.2 m	1/4" Carbide Burr, 1/4" Diamond Pin	Composite	0.3 lb 0.14 kg	5.5 in 140 mm	1/8 in

*Tools require lubricated airline at 90 psi maximum: Do not attach a quick-disconnect fitting directly to the tool.
Standard Equipment: Applicable collet, collet wrenches, collet guard, 5 ft/1.5 m air supply hose, 1 ft./0.3 m overhose*

DOTCO® 10-04 Series - Inline

60,000 RPM 0.1 hp (0.074 kW)

- Industrial bearing provides long life expectancy
- Designed for precision deburring and metal removal
- Compact and light aluminum weight housing
- Roll throttle equipped



Collet Guard			Collet Size	Free Speed (rpm)	Overhose	Abrasive Capacity	Type Housing	Weight	Length	Air Inlet Size
Without	With	Wrenchless Chuck								
Cat. No.	Cat. No.	Cat. No.								
10R0400-13	10R0401-13	—	3 mm	60,000	1 ft 0.3 m	1/4" Carbide Burr, 1/4" Diamond Pin	Aluminum	0.2 lb 0.09 kg	5.8 in 147 mm	1/8 in
10R0400-18	10R0401-18	—	1/8 in	60,000	1 ft 0.3 m	1/4" Carbide Burr, 1/4" Diamond Pin	Aluminum	0.2 lb 0.09 kg	5.8 in 147 mm	1/8 in
—	10R0401-16	—	3/32 in	60,000	1 ft 0.3 m	1/4" Carbide Burr, 1/4" Diamond Pin	Aluminum	0.2 lb 0.09 kg	5.8 in 147 mm	1/8 in
—	10R0401-43	—	3 mm	60,000	4 ft 1.2 m	1/4" Carbide Burr, 1/4" Diamond Pin	Aluminum	0.2 lb 0.09 kg	5.8 in 147 mm	1/8 in
—	—	10R0412-18	1/8 in	60,000	1 ft 0.3 m	1/4" Carbide Burr, 1/4" Diamond Pin	Aluminum	0.2 lb 0.09 kg	6.2 in 157 mm	1/8 in
—	10R0414-43	—	3 mm	60,000	4 ft 1.2 m	1/4" Carbide Burr, 1/4" Diamond Pin	Aluminum	0.2 lb 0.09 kg	5.8 in 147 mm	1/8 in

*Tools require lubricated airline at 90 psi maximum: Do not attach a quick-disconnect fitting directly to the tool.
Standard Equipment: Applicable collet, collet wrenches, collet guard, 5 ft/1.5 m air supply hose, 1 ft./0.3 m overhose*

DOTCO® 12-04 Series - Inline

60,000 RPM 0.1 hp (0.074 kW)

- Industrial bearing provides long life expectancy
- Designed for precision deburring and metal removal
- Compact and light weight composite housing
- Roll throttle equipped



Collet Guard		Collet Size	Free Speed (rpm)	Overhose	Abrasive Capacity	Type Housing	Weight	Length	Air Inlet Size
Without	With								
Cat. No.	Cat. No.								
12R0400-13	12R0410-13	3 mm	60,000	1 ft 0.3 m	1/4" Carbide Burr, 1/4" Diamond Pin	Composite	0.3 lb 0.14 kg	5.8 in 147 mm	1/8 in
12R0400-18	—	1/8 in	60,000	1 ft 0.3 m	1/4" Carbide Burr, 1/4" Diamond Pin	Composite	0.3 lb 0.14 kg	5.8 in 147 mm	1/8 in
12R0400-43	—	3 mm	60,000	4 ft 1.2 m	1/4" Carbide Burr, 1/4" Diamond Pin	Composite	0.3 lb 0.14 kg	5.8 in 147 mm	1/8 in
—	12R0410-16	3/32 in	60,000	1 ft 0.3 m	1/4" Carbide Burr, 1/4" Diamond Pin	Composite	0.3 lb 0.14 kg	5.8 in 147 mm	1/8 in
12R0410-18	—	1/8 in	60,000	1 ft 0.3 m	1/4" Carbide Burr, 1/4" Diamond Pin	Composite	0.3 lb 0.14 kg	5.8 in 147 mm	1/8 in
12R0410-43	—	3 mm	60,000	4 ft 1.2 m	1/4" Carbide Burr, 1/4" Diamond Pin	Composite	0.3 lb 0.14 kg	5.8 in 147 mm	1/8 in

Tools require lubricated airline at 90 psi maximum: Do not attach a quick-disconnect fitting directly to the tool.
Standard Equipment: Applicable collet, collet wrenches, collet guard, 5 ft/1.5 m air supply hose, 1 ft./0.3 m overhose

PRECISION GRINDERS

Cleco® 220G Series - Push-Pull Start

60,000 RPM 0.1 hp (0.74 kW)

- Industrial bearing provides long life expectancy
- Designed for precision deburring and metal removal
- Compact and light weight housing
- Available in a kit with a complete set of accessories



Collet Guard		Collet Size	Throttle Type	Free Speed (rpm)	Abrasive Capacity	Type Housing	Weight	Length	Air Inlet Size
With	Without								
Cat. No.	Cat. No.								
220GL-600-C2	—	1/8 in	Lever	60,000	1/4" Carbide Burr	Aluminum	0.4 lb 0.18 kg	4.6 in 117 mm	1/8 in
—	220G-600-C2-K#	-	None	60,000	1/4" Carbide Burr	Aluminum	0.5 lb 0.23 kg	4.6 in 117 mm	1/8 in
220G-600-C2*	—	1/8 in	None	60,000	1/4" Carbide Burr	Aluminum	0.3 lb 0.14 kg	4.6 in 117 mm	1/8 in

Tools require lubricated airline at 90 psi maximum: Do not attach a quick-disconnect fitting directly to the tool.
Standard Equipment: Applicable collet, collet wrenches, 8 ft./2.4 m air supply hose, built-in air filter, speed regulator

* Tool will start with applied air, intended for fixtured applications

Kit includes grinder, hose, collet, collet wrench, cylindrical plain burr 413680, cylindrical radius end burr 413681, cone & taper burr 413682, and tree point burr 413683, carrying case.

Cleco® 14/18 Series - Steel

50,000 RPM 0.1 hp (0.074 kW)



- Industrial bearing provides long life expectancy
- Designed for precision deburring and metal removal
- Compact and light weight housing
- Available in a kit with a complete set of accessories

Cat. No.	Collet Size	Throttle Type	Free Speed (rpm)	Abrasive Capacity	Type Housing	Weight	Length	Air Inlet Size
14G-810	1/8 in	Roll	50,000	1/4" Carbide Burr, 1/2" Mounted Wheel	Steel	0.3 lb 0.14 kg	3.9 in 99 mm	1/8 in
18G-810D	1/4 in	Dial	40,000	1/4" Carbide Burr, 1/2" Mounted Wheel	Steel	0.9 lb 0.41 kg	5.9 in 150 mm	1/8 in
18G-810D-08	1/8 in	Dial	40,000	1/4" Carbide Burr, 1/2" Mounted Wheel	Steel	0.9 lb 0.41 kg	5.9 in 150 mm	1/8 in

*Tools require lubricated airline at 90 psi maximum: Do not attach a quick-disconnect fitting directly to the tool.
Standard Equipment: Two collet wrenches, Nosepiece; Use dry air at 90 psi maximum: Do not lubricate turbine grinders. Lubrication will be detrimental to the operation and life of turbine tools.
Do not attach a quick-disconnect fitting directly to the tool.
Standard Equipment: 1/4" collet - 7808, Nosepiece -1011790, 7/16" Spindle Wrench - 1011691, 11/16" Collet Nut Wrench - 1014472*

DOTCO® 15Z Series - Air Marking Pen

20,000 RPM 0.06 hp (0.044 kW)



- Sliding sleeve throttle
- Ideal for marking a variety of materials, ranging from Aluminum to Titanium
- Carbide tipped stylus
- Weighs only 4 oz!

Cat. No.	Free Speed (rpm)	Abrasive Capacity	Type Housing	Weight	Length	Air Inlet Size	Diameter
15Z-710	20,000	1/8" Stylus	Aluminum	0.3 lb 0.14 kg	5.5 in 140 mm	1/4 in	0.6 in

*Tools require lubricated airline at 90 psi maximum: Do not attach a quick-disconnect fitting directly to the tool.
Standard Equipment: Carbide tipped stylus*

DOTCO® 15Z Series - Air Marking Pen Kit

20,000 RPM 0.06 hp (0.044 kW)



- Includes 15Z-710 air marking pen
- 5' (1.5 m) air hose assembly
- 3/16" ID with 1/8" NPT fittings
- Includes two 1/2" wrenches
- Durable and convenient carrying case

Cat. No.	Free Speed (rpm)	Abrasive Capacity	Type Housing	Weight	Length	Air Inlet Size
15Z-720	20,000	1/8" Stylus	Aluminum	0.4 lb 0.18 kg	5.50 in 140 mm	1/4 in

*Tools require lubricated airline at 90 psi maximum: Do not attach a quick-disconnect fitting directly to the tool.
Standard Equipment: Carbide tipped stylus*

DOTCO® 12-05 Series - with Collet Guard

40,000 RPM 0.2 hp (0.15 kW)

- Robust design have been continuously improved for six decades
- Compact size for ultimate control - easy access to confined areas
- Ideal for die and mold work as well as deburring
- Comprehensive selection of speed available
- Equipped with dial throttle



Cat. No.	Collet Size	Free Speed (rpm)	Abrasive Capacity	Type Housing	Weight	Length	Air Inlet Size
12R0500-36	1/4 in	40,000	1/4" Carbide Burr, 7/8" Mounted Wheel	Composite	0.7 lb 0.32 kg	5.9 in 150 mm	1/8 in

All tools performance rated @ 90 psi / 620 kPa air pressure.
 Minimum Hose I.D.: 3/16 in / 4.8 mm
 Standard Equipment: Applicable collet, collet wrenches, collet guard, 7 ft / 2.1 m air supply hose

DOTCO® 12-10 Series - 300 Series Collet

20,000 - 34,000 RPM 0.3 hp (0.22 kW)

- Durable and ergonomic composite housing
- Compact size for ultimate control - easy access to confined areas
- Ideal for die and mold work as well as deburring
- Comprehensive selection of speed available
- Standard equipped with lock-off lever



Exhaust		Collet Size	Free Speed (rpm)	Abrasive Capacity	Type Housing	Weight	Length	Air Inlet Size
Front	Rear							
Cat. No.	Cat. No.							
12L1045-36	—	1/4 in	12,000	1/2" Carbide Burr, 1" Mounted Wheel	Composite	0.8 lb 0.36 kg	6.0 in 152 mm	1/4 in
12L1046-36	—	1/4 in	18,000	1/2" Carbide Burr, 1" Mounted Wheel	Composite	0.8 lb 0.36 kg	6.0 in 152 mm	1/4 in
12S1008-36	12L1028-36	1/4 in	20,000	1/2" Carbide Burr, 1" Mounted Wheel	Composite	0.8 lb 0.36 kg	6.0 in 152 mm	1/4 in
12L1003-36	12L1082-36	1/4 in	25,000	1/2" Carbide Burr, 1" Mounted Wheel	Composite	0.8 lb 0.36 kg	6.0 in 152 mm	1/4 in
12L1000-36	12L1080-36	1/4 in	30,000	1/2" Carbide Burr, 1" Mounted Wheel	Composite	0.8 lb 0.36 kg	6.0 in 152 mm	1/4 in
12L1001-36	12L1081-36	1/4 in	34,000	1/2" Carbide Burr, 1" Mounted Wheel	Composite	0.8 lb 0.36 kg	6.0 in 152 mm	1/4 in

All tools performance rated @ 90 psi / 620 kPa air pressure.
 Standard Equipment: Applicable collet, collet wrenches
 Minimum Hose I.D.: 1/4 in / 6.4 mm

DOTCO® 10-10 Series - 200 & 300 Series Collet

25,000 - 34,000 RPM 0.3 hp (0.22 kW)

- Durable aluminum housing
- Compact size for ultimate control - easy access to confined areas
- Ideal for die and mold work as well as deburring
- Comprehensive selection of speed available



Exhaust		Collet Size	Throttle Type	Free Speed (rpm)	Abrasive Capacity	Type Housing	Weight	Length	Air Inlet Size
Front	Rear								
Cat. No.	Cat. No.								
10L1003-36	10L1082-36	1/4 in	Lock Off Lever	25,000	1/2" Carbide Burr, 1" Mounted Wheel	Aluminum	0.7 lb 0.32 kg	4.6 in 117 mm	1/4 in
—	10N1080-01*	1/4 in	None	30,000	1/2" Carbide Burr, 1" Mounted Wheel	Aluminum	0.7 lb 0.32 kg	4.6 in 117 mm	1/4 in
10L1000-36	10L1080-36	1/4 in	Lock Off Lever	30,000	1/2" Carbide Burr, 1" Mounted Wheel	Aluminum	0.7 lb 0.32 kg	4.6 in 117 mm	1/4 in
—	10L1097-36	1/4 in	Lock Off Lever	30,000	1/2" Carbide Burr, 1" Mounted Wheel	Aluminum With Bail	0.7 lb 0.32 kg	4.6 in 117 mm	1/4 in
10L1001-36	10L1081-36	1/4 in	Lock Off Lever	34,000	1/2" Carbide Burr, 1" Mounted Wheel	Aluminum	0.7 lb 0.32 kg	4.6 in 117 mm	1/4 in
—	10N1081-36*	1/4 in	None	34,000	1/2" Carbide Burr, 1" Mounted Wheel	Aluminum	0.7 lb 0.32 kg	4.6 in 117 mm	1/4 in

All tools performance rated @ 90 psi / 620 kPa air pressure.
 Standard Equipment: Applicable collet, collet wrenches
 Minimum Hose I.D.: 1/4 in / 6.4 mm
 * Tool will start with applied air, intended for fixtured applications

IN LINE GRINDERS

DOTCO® 12-20 Series - 200 Series Collet

18,000 - 25,000 RPM 0.6 hp (0.45 kW)

- Ergonomic composite housing
- Front and rear exhaust models available
- Designed to work comfortably with the operator
- Standard equipped with 200 series collet



Exhaust		Throttle Type	Free Speed (rpm)	Abrasive Capacity	Type Housing	Weight	Length	Air Inlet Size
Front	Rear							
Cat. No.	Cat. No.							
12L2003-01	—	Lock Off Lever	12,000	3/4" Carbide Burr, 1.5" Mounted Wheel	Composite	1.4 lb 0.64 kg	6.9 in 175 mm	1/4 in
12L2002-01	12L2082-01	Lock Off Lever	18,000	3/4" Carbide Burr, 1.5" Mounted Wheel	Composite	1.4 lb 0.64 kg	6.9 in 175 mm	1/4 in
12L2001-01	12L2081-01	Lock Off Lever	20,000	3/4" Carbide Burr, 1.5" Mounted Wheel	Composite	1.4 lb 0.64 kg	6.9 in 175 mm	1/4 in
—	12B2080-01	Button	25,000	3/4" Carbide Burr, 1.5" Mounted Wheel	Composite	1.4 lb 0.64 kg	6.9 in 175 mm	1/4 in
12L2000-01	12L2080-01	Lock Off Lever	25,000	3/4" Carbide Burr, 1.5" Mounted Wheel	Composite	1.4 lb 0.64 kg	6.9 in 175 mm	1/4 in

All tools performance rated @ 90 psi / 620 kPa air pressure.
 Standard Equipment: Applicable collet, collet wrenches
 Minimum Hose I.D.: 1/4 in / 6.4 mm

DOTCO® 10-20 Series - 200 & 300 Series Collet

25,000 RPM 0.6 hp (0.45 kW)

- Durable aluminum housing
- Front, side, and rear exhaust models available
- Designed to work comfortably with the operator



Exhaust		Collet Guard	Collet Size	Throttle Type	Free Speed (rpm)	Abrasive Capacity	Type Housing	Weight	Length	Air Inlet Size
Front	Rear									
Cat. No.	Cat. No.									
10L2002-36	—	300 Series	1/4 in	Lock Off Lever	18,000	3/4" Carbide Burr, 1.5" Mounted Wheel	Aluminum	1.4 lb 0.64 kg	6.6 in 168 mm	1/4 in
—	10L2082-01	200 Series	1/4 in	Lock Off Lever	18,000	3/4" Carbide Burr, 1.5" Mounted Wheel	Aluminum	1.4 lb 0.64 kg	6.6 in 168 mm	1/4 in
10L2005-01	—	200 Series	1/4 in	Lock Off Lever	20,000	3/4" Carbide Burr, 1.5" Mounted Wheel	Aluminum	1.3 lb 0.59 kg	5.7 in 145 mm	1/4 in
—	10L2081-01	200 Series	1/4 in	Lock Off Lever	20,000	3/4" Carbide Burr, 1.5" Mounted Wheel	Aluminum	1.3 lb 0.59 kg	5.8 in 147 mm	1/4 in
10L2000-01	10L2080-01	200 Series	1/4 in	Lock Off Lever	25,000	3/4" Carbide Burr, 1.5" Mounted Wheel	Aluminum	1.3 lb 0.59 kg	5.8 in 147 mm	1/4 in
10L2000-36	—	300 Series	1/4 in	Lock Off Lever	25,000	3/4" Carbide Burr, 1.5" Mounted Wheel	Aluminum	1.2 lb 0.54 kg	6.4 in 163 mm	1/4 in
—	10L2080-36	300 Series	1/4 in	Lock Off Lever	25,000	3/4" Carbide Burr, 1.5" Mounted Wheel	Aluminum	1.3 lb 0.59 kg	6.4 in 163 mm	1/4 in
—	10N2080-01**	200 Series	1/4 in	None	25,000	3/4" Carbide Burr, 1.5" Mounted Wheel	Aluminum	1.3 lb 0.59 kg	5.8 in 147 mm	1/4 in

All tools performance rated @ 90 psi / 620 kPa air pressure.
 Standard Equipment: Applicable collet, collet wrenches
 Minimum Hose I.D.: 5/16 in / 7.9 mm
 *Tool will start with applied air, intended for fixtured applications

Cleco® 216 Series - 200 Series Collet

25,000 RPM 0.7 hp (0.45 kW)

- Designed for demands of heavy industries, such as shipbuilding, foundries, metal fabrication, etc.
- Rugged advanced alloy housing
- Front and side exhaust models available



Exhaust		Collet Size	Free Speed (rpm)	Abrasive Capacity	Type Housing	Weight	Length	Air Inlet Size
Front	Side							
Cat. No.	Cat. No.							
216GLFB-250-C4	216GLSB-250-C4	1/4 in	25,000	3/4" Carbide Burr	Aluminum	1.3 lb 0.59 kg	6.3 in 160 mm	1/4 in

All tools performance rated @ 90 psi / 620 kPa air pressure.
 Standard Equipment: Applicable collet, collet wrenches
 Minimum Hose I.D.: 1/4 in / 6.4 mm

Cleco® 236 Series - 200 Series Collet

18,000 - 25,000 RPM 0.6 hp (0.45 kW)

- Designed for demands of heavy industries, such as shipbuilding, foundries, metal fabrication, etc.
- Durable advanced alloy housing
- Front, side, and rear exhaust models available



Exhaust			Collet Size	Free Speed (rpm)	Abrasive Capacity	Type Housing	Weight	Length	Air Inlet Size
Rear	Front	Side							
Cat. No.	Cat. No.	Cat. No.							
236GLR-180-C4	—	—	1/4 in	18,000	1" Carbide Burr	Aluminum	1.3 lb 0.59 kg	7.4 in 188 mm	1/4 in
—	236GLF-180-C4	236GLS-180-C4	1/4 in	18,000	1" (25 mm) Carbide Burr, 2" (50 mm) Mounted Wheel	Aluminum	1.4 lb 0.64 kg	6.8 in 173 mm	1/4 in
236GLR-200-C4	—	—	1/4 in	20,000	1" (25 mm) Carbide Burr, 2" (50 mm) Mounted Wheel	Aluminum	1.3 lb 0.59 kg	7.4 in 188 mm	1/4 in
—	—	236GLS-240-C4	1/4 in	24,000	1" Carbide Burr	Aluminum	1.4 lb 0.64 kg	6.8 in 173 mm	1/4 in
236GLR-250-C4	—	—	1/4 in	25,000	1" Carbide Burr	Aluminum	1.3 lb 0.59 kg	7.4 in 188 mm	1/4 in
—	236GLF-250-C4	—	1/4 in	25,000	1" Carbide Burr	Aluminum	1.4 lb 0.64 kg	6.8 in 173 mm	1/4 in
—	236GLF-250-C6	—	3/8 in	25,000	1" (25 mm) Carbide Burr, 2" (50 mm) Mounted Wheel	Aluminum	1.4 lb 0.64 kg	6.8 in 173 mm	1/4 in

All tools performance rated @ 90 psi / 620 kPa air pressure.
Standard Equipment: Applicable collet, collet wrenches
Minimum Hose I.D.: 5/16 in / 7.9 mm

DOTCO® 12-25 Series - 200 & 300 Series Collet

12,000 - 23,000 RPM 0.9 hp (0.67 kW)

- Ergonomic composite housing
- Optional over-hose available
- High power-to-weight ratio for optimal productivity



Exhaust		Collet Guard	Collet Size	Free Speed (rpm)	Abrasive Capacity	Type Housing	Weight	Length	Air Inlet Size
Front	Rear								
Cat. No.	Cat. No.								
12L2562-01*	12L2542-01*	200 Series	1/4 in	12,000	1" Carbide Bur, 1.5" Mounted Wheel	Composite	1.8 lb 0.82 kg	7.4 in 188 mm	1/4 in
12L2565-01*	12L2545-01*	200 Series	1/4 in	15,000	1" Carbide Burr, 1.5" Mounted Wheel	Composite	1.8 lb 0.82 kg	7.4 in 188 mm	1/4 in
12L2502-01	12L2582-01	200 Series	1/4 in	18,000	1" Carbide Burr, 1.5" Mounted Wheel	Composite	1.8 lb 0.82 kg	7.3 in 185 mm	1/4 in
12L2568-01*	12L2548-01*	200 Series	1/4 in	18,000	1" Carbide Burr, 1.5" Mounted Wheel	Composite	1.8 lb 0.82 kg	7.4 in 188 mm	1/4 in
12L2500-01	12L2580-01	200 Series	1/4 in	23,000	1" Carbide Burr, 1.5" Mounted Wheel	Composite	1.8 lb 0.82 kg	7.3 in 185 mm	1/4 in
12L2500-36	12L2580-36	300 Series	1/4 in	23,000	1" Carbide Burr, 1.5" Mounted Wheel	Composite	1.8 lb 0.82 kg	8.0 in 203 mm	1/4 in

* Governed
All tools performance rated @ 90 psi / 620 kPa air pressure.
Standard Equipment: Applicable collet, collet wrenches
Minimum Hose I.D.: 5/16 in / 7.9 mm

DOTCO® 10-25 Series - 200 & 300 Series Collet

18,000 - 23,000 RPM 0.9 hp (0.67 kW)

- Aluminum housing
- Compact, yet powerful motor



Exhaust		Collet Option	Collet Size	Throttle Type	Free Speed (rpm)	Abrasive Capacity	Type Housing	Weight	Length	Air Inlet Size
Front	Rear									
Cat. No.	Cat. No.									
10L2562-01	—	200 Series	1/4 in	Lock Off Lever	12,000	1" Carbide Burr, 1.5" Mounted Wheel	Aluminum	1.9 lb 0.86 kg	7.0 in 178 mm	1/4 in
10L2565-01	—	200 Series	1/4 in	Lock Off Lever	15,000	1" Carbide Burr, 1.5" Mounted Wheel	Aluminum	1.9 lb 0.86 kg	7.0 in 178 mm	1/4 in
10L2502-01	—	200 Series	1/4 in	Lock Off Lever	18,000	1" Carbide Burr, 1.5" Mounted Wheel	Aluminum	1.4 lb 0.64 kg	6.3 in 160 mm	1/4 in
10L2568-01	—	200 Series	1/4 in	Lock Off Lever	18,000	1" Carbide Burr, 1.5" Mounted Wheel	Aluminum	1.5 lb 0.68 kg	7.3 in 185 mm	1/4 in
—	10L2582-01	200 Series	1/4 in	Lock Off Lever	18,000	1" Carbide Burr, 1.5" Mounted Wheel	Aluminum	1.5 lb 0.68 kg	7.3 in 185 mm	1/4 in
10L2500-01	10L2580-01	200 Series	1/4 in	Lock Off Lever	23,000	1" Carbide Burr, 1.5" Mounted Wheel	Aluminum	1.4 lb 0.64 kg	6.3 in 160 mm	1/4 in
10L2500-36	—	300 Series	1/4 in	Lock Off Lever	23,000	1" Carbide Burr, 1.5" Mounted Wheel	Aluminum	1.4 lb 0.64 kg	7.1 in 180 mm	1/4 in
—	10L2580-36	300 Series	1/4 in	Lock Off Lever	23,000	1" Carbide Burr, 1.5" Mounted Wheel	Aluminum	1.5 lb 0.68 kg	7.9 in 201 mm	1/4 in
10B2500-01*	—	200 Series	1/4 in	Button	23,000	1" Carbide Burr, 1.5" Mounted Wheel	Aluminum	1.4 lb 0.64 kg	6.3 in 160 mm	1/4 in

DOTCO® 12-11 Series - 300 Series Collet

25,000 - 28,000 RPM 0.3 hp (0.22 kW)

- 3" and 5" extended housings available
- Overhose available
- Multiple industrial bearings for low vibration and perfect balance



Exhaust		Collet Size	Free Speed (rpm)	Extension	Abrasive Capacity	Type Housing	Weight	Length	Air Inlet Size
Front	Rear								
Cat. No.	Cat. No.								
12L1111-36	—	1/4 in	25,000	3 in	1/2" Carbide Burr, 1" Mounted Wheel	Composite	1.1 lb 0.50 kg	8.9 in 226 mm	1/4 in
12L1100-36	12L1180-36	1/4 in	28,000	3 in	1/2" Carbide Burr, 1" Mounted Wheel	Composite	1.1 lb 0.50 kg	8.9 in 226 mm	1/4 in
12L1101-36	12L1181-36	1/4 in	28,000	5 in	1/2" Carbide Burr, 1" Mounted Wheel	Composite	1.3 lb 0.59 kg	10.9 in 277 mm	1/4 in
12L1112-36	—	1/4 in	25,000	5 in	1/2" Carbide Burr, 1" Mounted Wheel	Composite	1.3 lb 0.59 kg	10.9 in 277 mm	1/4 in

All tools performance rated @ 90 psi / 620 kPa air pressure.
Standard Equipment: Applicable collet, collet wrenches
Minimum Hose I.D.: 1/4 in / 4.8 mm

DOTCO® 10-11 Series - 300 Series Collet

25,000 - 28,000 RPM 0.3 hp (0.22 kW)

- 3" & 5" extended housing for hard to reach areas
- Available in a variety of speeds
- Balanced and comfortable to minimize fatigue



Exhaust		Collet Size	Free Speed (rpm)	Extension	Abrasive Capacity	Type Housing	Weight	Length	Air Inlet Size
Front	Rear								
Cat. No.	Cat. No.								
10L1100-36	—	1/4 in	28,000	3 in	1/2" Carbide Burr, 1" Mounted Wheel	Aluminum	1.0 lb 0.45 kg	7.6 in 193 mm	1/4 in
10L1101-36	—	1/4 in	28,000	3 in	1/2" Carbide Burr, 1" Mounted Wheel	Aluminum	1.2 lb 0.54 kg	9.8 in 249 mm	1/4 in
10L1111-36	—	1/4 in	25,000	3 in	1/2" Carbide Burr, 1" Mounted Wheel	Aluminum	1.0 lb 0.45 kg	7.6 in 193 mm	1/4 in
10L1112-36	—	1/4 in	25,000	5 in	1/2" Carbide Burr, 1" Mounted Wheel	Aluminum	1.2 lb 0.54 kg	9.8 in 249 mm	1/4 in
—	10L1180-36	1/4 in	28,000	3 in	1/2" Carbide Burr, 1" Mounted Wheel	Aluminum	1.1 lb 0.50 kg	8.4 in 213 mm	1/8 in
—	10L1181-36	1/4 in	28,000	5 in	1/2" Carbide Burr, 1" Mounted Wheel	Aluminum	1.2 lb 0.54 kg	9.8 in 249 mm	1/4 in

All tools performance rated @ 90 psi / 620 kPa air pressure.
Standard Equipment: Applicable collet, collet wrenches
Minimum Hose I.D.: 1/4 in / 6.4 mm

DOTCO® 12-26 Series - 5" (127 mm) Extension - 200 Series Collet

18,000 - 22,000 RPM 0.9 hp (0.67 kW)

- 5" Extended housing for hard to reach areas
- Available in a variety of speeds
- Balanced and comfortable to minimize fatigue



Exhaust		Collet Size	Free Speed (rpm)	Abrasive Capacity	Type Housing	Weight	Length	Air Inlet Size
Side	Rear							
Cat. No.	Cat. No.							
12L2662-01*	12L2682-01	1/4 in	12,000	1" Carbide Burr, 1.5" Mounted Wheel	Composite	2.9 lb 1.32 kg	12.9 in 328 mm	1/4 in
12L2602-01	—	1/4 in	18,000	1" Carbide Burr, 1.5" Mounted Wheel	Composite	2.9 lb 1.32 kg	12.9 in 328 mm	1/4 in
12L2668-01*	—	1/4 in	18,000	1" Carbide Burr, 1.5" Mounted Wheel	Composite	2.9 lb 1.32 kg	12.9 in 328 mm	1/4 in
12L2600-01	12L2680-01	1/4 in	22,000	1" Carbide Burr, 1.5" Mounted Wheel	Composite	2.9 lb 1.32 kg	12.9 in 328 mm	1/4 in

All tools performance rated @ 90 psi / 620 kPa air pressure.
 Standard Equipment: Applicable collet, collet wrenches
 Minimum Hose I.D.: 5/16 in / 7.9 mm
 * Governed

Cleco® 12-26 Series - Multiple Extension

18,000 RPM 0.9 hp (0.67 kW)

- Can be customized with multiple extensions for access to the most far-reaching areas
- Multiple industrial bearings provides optimal balance and power transfer
- Designed to work comfortably with the operator
- Available with 300 series 1/4" collet and 3/8"-24" external thread



Cat. No.	Exhaust	Termination	Free Speed (rpm)	Extension	Abrasive Capacity	Type Housing	Weight	Length	Air Inlet Size
12S2674-1A	Rear	1/4" Collet	18,000	7.25 in	3/4" Carbide Burr, 1.5" Mounted Wheel	Composite	3.0 lb 1.36 kg	16.3 in 414 mm	1/4 in
12S2674-2A	Rear	1/4" Collet	18,000	14.50 in	3/4" Carbide Burr, 1.5" Mounted Wheel	Composite	4.2 lb 1.91 kg	23.5 in 597 mm	1/4 in
12S2674-2C	Rear	3/8" - 24 e	18,000	14.50 in	1.25" Cone or Plug Wheel	Composite	4.2 lb 1.91 kg	23.5 in 597 mm	1/4 in
12S2674-3A	Rear	1/4" Collet	18,000	21.75 in	3/4" Carbide Burr, 1.5" Mounted Wheel	Composite	5.4 lb 2.45 kg	30.8 in 782 mm	1/4 in
12S2674-3C	Rear	3/8" - 24 e	18,000	21.75 in	1.25" Cone or Plug Wheel	Composite	5.4 lb 2.45 kg	30.8 in 782 mm	1/4 in
12S2674-4A	Rear	1/4" Collet	18,000	29.00 in	3/4" Carbide Burr, 1.5" Mounted Wheel	Composite	6.6 lb 2.99 kg	38.0 in 965 mm	1/4 in
12S2674-4C	Rear	3/8" - 24 e	18,000	29.00 in	1.25" Cone or Plug Wheel	Composite	6.6 lb 2.99 kg	38.0 in 965 mm	1/4 in
12S2674-5A	Rear	1/4" Collet	18,000	36.25 in	3/4" Carbide Burr, 1.5" Mounted Wheel	Composite	7.8 lb 3.54 kg	45.3 in 1151 mm	1/4 in
12S2674-5C	Rear	3/8" - 24 e	18,000	36.25 in	1.25" Cone or Plug Wheel	Composite	7.8 lb 3.54 kg	45.3 in 1151 mm	1/4 in

All tools performance rated @ 90 psi / 620 kPa air pressure.
 Standard Equipment: Applicable collet, collet wrenches
 Minimum Hose I.D.: 5/16 in / 7.9 mm

Cleco® 236 Series - Extended - 200 Series Collet

24,000 RPM 0.9 hp (0.6 kW)

- Rugged all aluminum housing
- Heavy industrial use for shipyards, foundries, metal fabrication, rail yards, etc.
- 5" Extended housing for hard to reach areas
- Offers higher horsepower and torque levels than similar competitive tools



Cat. No.	Exhaust	Collet Size	Free Speed (rpm)	Abrasive Capacity	Type Housing	Weight	Length	Air Inlet Size
236GEL-240-C4	Side	1/4 in	24,000	1" Carbide Burr, 2" Mounted Wheel	Aluminum	2.3 lb 1.04 kg	12.4 in 315 mm	1/4 in
236GELR-180-C4	Rear	1/4 in	18,000	1" (25 mm) Carbide Burr, 2" (50 mm) Mounted Wheel	Aluminum	2.2 lb 1.00 kg	12.3 in 312 mm	1/4 in

All tools performance rated @ 90 psi / 620 kPa air pressure.
Standard Equipment: Applicable collet, collet wrenches
Minimum Hose I.D.: 5/16 in / 7.9 mm

Cleco® 25 Series - Extended - Governed - 200 Series Collet

18,000 RPM 1.4 hp (1.0 kW)

- Lightweight, Ergonomic housing
- Heavy industrial use for shipyards, foundries, metal fabrication, rail yards, etc.
- Extended housing for hard to reach areas
- Offers higher horsepower and torque levels than similar competitive tools



Cat. No.	Collet Size	Free Speed (rpm)	Abrasive Capacity	Type Housing	Weight	Length	Air Inlet Size
25GELC-120-C4	1/4 in	12,000	1.25" Carbide Burr, 2" Mounted Wheel	Aluminum	3.0 lb 1.36 kg	14.5 in 368 mm	3/8 in
25GELC-180-C4	1/4 in	18,000	1.25" Carbide Burr, 2" Mounted Wheel	Aluminum	3.0 lb 1.36 kg	14.5 in 368 mm	3/8 in

All tools performance rated @ 90 psi / 620 kPa air pressure.
Standard Equipment: Applicable collet, collet wrenches
Minimum Hose I.D.: 3/8 in / 9.5 mm

DOTCO® 12LF Series - 300 Series Collet

12,000 - 20,000 RPM 0.4 hp (0.29 kW)

- Composite housing
- Front and rear exhaust models available
- Ergonomic and balanced design minimizes operator fatigue



Exhaust		Collet Size	Free Speed (rpm)	Abrasive Capacity	Type Housing	Weight	Length	Head Height
Front	Rear							
Cat. No.	Cat. No.							
12LF200-36	12LF280-36	1/4 in	12,000	1/2" Carbide Burr, 1" Mounted Wheel	Composite	1.1 lb 0.50 kg	6.6 in 168 mm	2.7 in
12LF201-36	12LF281-36	1/4 in	20,000	1/2" Carbide Burr, 1" Mounted Wheel	Composite	1.1 lb 0.50 kg	6.6 in 168 mm	2.7 in

All tools performance rated @ 90 psi / 620 kPa air pressure.
 Standard Equipment: Applicable collet, collet wrenches
 Minimum Hose I.D.: 1/4 in / 4.8 mm

DOTCO® 10LF Series - 300 Series Collet

12,000 - 20,000 RPM 0.4 hp (0.29 kW)

- Aluminum housing for high durability
- Front and rear exhaust models available
- Well suited for any industrial grinding application



Exhaust		Collet Size	Free Speed (rpm)	Abrasive Capacity	Type Housing	Weight	Length	Head Height
Front	Rear							
Cat. No.	Cat. No.							
10LF200-36	10LF280-36	1/4 in	12,000	1/2" Carbide Burr, 1" Mounted Wheel	Aluminum	1.1 lb 0.50 kg	6.6 in 168 mm	2.7 in
10LF201-36	10LF281-36	1/4 in	20,000	1/2" Carbide Burr, 1" Mounted Wheel	Aluminum	1.1 lb 0.50 kg	6.6 in 168 mm	2.7 in

All tools performance rated @ 90 psi / 620 kPa air pressure.
 Standard Equipment: Applicable collet, collet wrenches
 Minimum Hose I.D.: 1/4 in / 4.8 mm

DOTCO® 12-13 Series - Gearless - 300 Series Collet

20,000 - 30,000 RPM 0.3 hp (0.22 kW)

- Composite housing
- Front and rear exhaust models available
- Suitable for a wide range of finishing and deburring applications



Exhaust		Collet Size	Free Speed (rpm)	Abrasive Capacity	Type Housing	Weight	Length	Head Height
Front	Rear							
Cat. No.	Cat. No.							
12L1302-36	12L1382-36	1/4 in	20,000	1/2" Carbide Burr, 1" Mounted Wheel	Composite	1.1 lb 0.50 kg	7.1 in 180 mm	3.7 in
12L1301-36	12L1381-36	1/4 in	25,000	1/2" Carbide Burr, 1" Mounted Wheel	Composite	1.1 lb 0.50 kg	7.1 in 180 mm	3.7 in
12L1300-36	12L1380-36	1/4 in	30,000	1/2" Carbide Burr, 1" Mounted Wheel	Composite	1.1 lb 0.50 kg	7.1 in 180 mm	3.7 in

All tools performance rated @ 90 psi / 620 kPa air pressure.
Standard Equipment: Applicable collet, collet wrenches
Minimum Hose I.D.: 1/4 in / 4.8 mm

DOTCO® 12-23 Series - Gearless - 200 Series Collet

20,000 RPM 0.5 hp (0.38 kW)

- Composite housing
- Front, side and rear exhaust models available
- Suitable for a wide range of finishing and deburring applications



Cat. No.	Collet Size	Free Speed (rpm)	Abrasive Capacity	Type Housing	Weight	Length	Head Height	Air Inlet Size
12L2384-01	1/4 in	20,000	3/4" Carbide Burr, 1.25" Mounted Wheel	Composite	2.0 lb 0.91 kg	7.5 in 191 mm	5.5 in	1/4 in

All tools performance rated @ 90 psi / 620 kPa air pressure.
Standard Equipment: Applicable collet, collet wrenches
Minimum Hose I.D.: 1/4 in / 4.8 mm

DOTCO® 12-22 Series - 300 Series Collet

12,000 RPM 0.6 hp (0.45 kW)

- Ergonomic composite housing
- Heavy duty low profile head for greater accessibility
- High output motor in a lightweight package
- 3" Extended head available



Cat. No.	Termination	Free Speed (rpm)	Extension	Abrasive Capacity	Type Housing	Weight	Length	Air Inlet Size
12L2277-36	1/4" Collet	12,000	3 in	1/2" Carbide Burr, 1" Mounted Wheel	Composite	2.2 lb 1.00 kg	10.0 in 254 mm	1/4 in
12L2278-36	1/4" Collet	14,500	3 in	1/2" Carbide Burr, 1" Mounted Wheel	Composite	2.2 lb 1.00 kg	10.0 in 254 mm	1/4 in
12L2218-36	1/4" Collet	18,000	0 in	1/2" Carbide Burr, 1" Mounted Wheel	Composite	1.7 lb 0.77 kg	7.5 in 191 mm	1/4 in

All tools performance rated @ 90 psi / 620 kPa air pressure.
Standard Equipment: Applicable collet, collet wrenches
Minimum Hose I.D.: 5/16 in / 7.9 mm

DOTCO® 12-22 Series - Heavy Duty Head - 200 Series Collet

9,000 RPM 0.6 hp (0.45 kW)

- Composite housing
- Front, side, and rear exhaust models available
- Ergonomic and balanced design minimized operator fatigue



Cat. No.	Collet Size	Free Speed (rpm)	Abrasive Capacity	Type Housing	Weight	Length	Head Height	Air Inlet Size
12L2251-01	1/4 in	9,000	3/4" Carbide Bur, 2" Mounted Wheel	Composite	3.2 lb 1.45 kg	9.3 in 236 mm	3.9 in	1/4 in
12L2252-01	1/4 in	11,000	3/4" Carbide Burr, 2" Mounted Wheel	Composite	3.2 lb 1.45 kg	9.3 in 236 mm	3.9 in	1/4 in

All tools performance rated @ 90 psi / 620 kPa air pressure.
Standard Equipment: Applicable collet, collet wrenches
Minimum Hose I.D.: 5/16 in / 7.9 mm

Cleco® 216 Series - Heavy Duty Head - 200 Series Collet

11,500 - 16,500 RPM 0.7 hp (0.4 kW)

- Rugged and durable aluminum housing
- Designed for heavy industries such as shipbuilding, foundries, metal fabrication, etc.
- Robust angle head design provides excellent durability



Cat. No.	Exhaust	Collet Size	Free Speed (rpm)	Abrasive Capacity	Type Housing	Weight	Length	Head Height	Air Inlet Size
216GLF-115A-C4	Front	1/4 in	11,500	1" Carbide Burr	Aluminum	2.4 lb 1.09 kg	7.1 in 180 mm	2.2 in	1/4 in
216GLFC-165A-C4	Rear	1/4 in	16,500	3/4" Carbide Burr	Aluminum	1.7 lb 0.77 kg	9.1 in 231 mm	2.2 in	1/4 in
216GLSC-165A-C4	Side	1/4 in	16,500	3/4" Carbide Burr	Aluminum	1.7 lb 0.77 kg	9.1 in 231 mm	2.2 in	1/4 in

All tools performance rated @ 90 psi / 620 kPa air pressure.
Standard Equipment: Applicable collet, collet wrenches
Minimum Hose I.D.: 1/4 in / 4.8 mm

Cleco® 236 Series - Heavy Duty Head - 200 Series Collet

11,500 - 16,500 RPM 0.8 hp (0.6 kW)

- Rugged and durable aluminum housing
- Designed for heavy industries such as shipbuilding, foundries, metal fabrication, etc.
- Robust angle head design provides excellent durability



Cat. No.	Exhaust	Collet Size	Free Speed (rpm)	Abrasive Capacity	Type Housing	Weight	Length	Head Height	Air Inlet Size
236GLF-115A-C4	Front	1/4 in	11,500	1" (25 mm) Carbide Burr, 2" (50 mm) Mounted Wheel	Aluminum	2.6 lb 1.18 kg	7.6 in 193 mm	2.2 in	1/4 in
236GLR-115A-C4	Rear	1/4 in	11,500	1" (25 mm) Carbide Burr, 2" (50 mm) Mounted Wheel	Aluminum	2.1 lb 0.95 kg	8.3 in 211 mm	2.2 in	1/4 in
236GLSC-115A-C4	Side	1/4 in	11,500	1" (25 mm) Carbide Burr, 2" (50 mm) Mounted Wheel	Aluminum	2.0 lb 0.91 kg	9.6 in 244 mm	2.2 in	1/4 in
236GLFC-165A-C4	Front	1/4 in	16,500	3/4" Carbide Burr	Aluminum	2.0 lb 0.91 kg	9.6 in 244 mm	2.2 in	1/4 in

All tools performance rated @ 90 psi / 620 kPa air pressure.
Standard Equipment: Applicable collet, collet wrenches
Minimum Hose I.D.: 5/16 in / 7.9 mm

DOTCO® 12-27 Series - Heavy Duty Head - 200 Series Collet

6,000 - 11,000 RPM 0.9 hp (0.67 kW)

- Composite housing
- Front, side and rear exhaust models available
- Robust design perfectly suited for industrial applications



Cat. No.	Exhaust	Collet Size	Free Speed (rpm)	Abrasive Capacity	Type Housing	Weight	Length	Head Height	Air Inlet Size
12L2750-01	Side	1/4 in	6,000	1" Carbide Burr, 1" Mounted Wheel	Composite	3.4 lb 1.54 kg	9.8 in 249 mm	3.9 in	1/4 in
12L2780-01	Rear	1/4 in	6,000	3/4" Carbide Burr, 2" Mounted Wheel	Composite	3.4 lb 1.54 kg	9.8 in 249 mm	3.9 in	1/4 in
12L2751-01	Front	1/4 in	9,000	3/4" Carbide Burr, 2" Mounted Wheel	Composite	3.4 lb 1.54 kg	9.8 in 249 mm	3.9 in	1/4 in
12L2752-01	Side	1/4 in	11,000	3/4" Carbide Burr, 2" Mounted Wheel	Composite	3.4 lb 1.54 kg	9.8 in 249 mm	3.9 in	1/4 in
12L2782-01	Rear	1/4 in	11,000	3/4" Carbide Burr, 2" Mounted Wheel	Composite	3.4 lb 1.54 kg	9.8 in 249 mm	3.9 in	1/4 in

All tools performance rated @ 90 psi / 620 kPa air pressure.
Standard Equipment: Applicable collet, collet wrenches
Minimum Hose I.D.: 5/16 in / 7.9 mm

DOTCO® 12-27 Series - 300 Series Collet

18,000 RPM 0.9 hp (0.67 kW)

- Composite housing
- Powerful motor with rear exhaust
- Robust design perfectly suited for industrial applications
- Standard 3" extension



Cat. No.	Collet Size	Free Speed (rpm)	Extension	Abrasive Capacity	Type Housing	Weight	Length
12L2777-36	1/4 in	12,000	3 in	3/4" Carbide Burr, 1.25" Mounted Wheel	Composite	2.3 lb 1.04 kg	10.5 in 267 mm
12L2776-36	1/4 in	13,500	3 in	3/4" Carbide Burr, 1.25" Mounted Wheel	Composite	2.3 lb 1.04 kg	10.5 in 267 mm
12L2778-36	1/4 in	14,500	3 in	3/4" Carbide Burr, 1.25" Mounted Wheel	Composite	2.3 lb 1.04 kg	10.5 in 267 mm
12L2718-36	1/4 in	18,000	0 in	3/4" Carbide Burr, 1.25" Mounted Wheel	Composite	1.9 lb 0.86 kg	8.0 in 203 mm

*All tools performance rated @ 90 psi / 620 kPa air pressure.
Standard Equipment: Applicable collet, collet wrenches
Minimum Hose I.D.: 5/16 in / 7.9 mm*

Cleco® 136 Series - Gearless

11,500 - 18,000 RPM 0.6 hp (0.4 kW)

- Compact and powerful
- 1 Piece housing
- Maximum durability with gearless drive
- Equipped with lock-off lever



Cat. No.	Spindle Size	Free Speed (rpm)	Abrasive Capacity	Type Housing	Weight	Length	Head Height	Air Inlet Size
136VGL-115-D3T4	3/8" - 24 e	11,500	4" (100 mm) Type 27	Steel	2.4 lb 1.09 kg	7.3 in 185 mm	4.0 in	1/2 in
136VGL-135-D3T4	3/8" - 24 e	13,500	4" (100 mm) Type 27	Steel	2.4 lb 1.09 kg	7.3 in 185 mm	4.0 in	1/2 in
136VGL-180-D3T3	3/8" - 24 e	18,000	3" (75 mm) Type 27	Steel	2.4 lb 1.09 kg	7.3 in 185 mm	4.0 in	1/2 in
136VGL-180-D3T4	3/8"- 24 e	18,000	4" (100 mm) Type 27	Steel	2.4 lb 1.09 kg	7.3 in 185 mm	4.0 in	1/2 in

All tools performance rated @ 90 psi / 620 kPa air pressure.
Minimum Hose I.D.: 3/4 in / 19 mm
Standard Equipment: Wheel guard, flange wrench, Operating instructions & service manual

Cleco® 216 Series - Heavy Duty Head

11,500 RPM 0.6 hp (0.4 kW)

- Rugged and durable aluminum housing
- Robust and long lasting angle head for the most demanding applications
- Powerful motor stays durable in the harshest environments



Cat. No.	Exhaust	Spindle Size	Free Speed (rpm)	Abrasive Capacity	Type Housing	Weight	Length	Head Height	Air Inlet Size
216GLF-115A-D3T4	Front	3/8"-24 e	11,500	4" (100 mm) Type 27	Aluminum	2.7 lb 1.22 kg	7.1 in 180 mm	3.2 in	1/4 in
216GLF-115A-D3T45	Front	3/8"-24 e	11,500	4.5" (115 mm) Type 27	Aluminum	2.7 lb 1.22 kg	7.1 in 180 mm	3.2 in	1/4 in

All tools performance rated @ 90 psi / 620 kPa air pressure.
Minimum Hose I.D.: 5/16 in / 7.9 mm
Standard Equipment: Wheel guard, wheel adapter, spindle wrench, Operating instructions & service manual

Cleco® 216 Series - Extended Head

13,500 RPM 0.6 hp (0.4 kW)

- Rugged and durable aluminum housing
- Extended head for better reach and accessibility
- Lock-off lever for safe operation



Cat. No.	Exhaust	Spindle Size	Free Speed (rpm)	Abrasive Capacity	Type Housing	Weight	Length	Head Height	Air Inlet Size
216GLFB-135A-D3T4	Front	3/8" - 24 e	13,500	4" (100 mm) Type 27	Aluminum	2.7 lb 1.22 kg	9.1 in 231 mm	2.2 in	1/4 in
216GLSB-135A-D3T4	Side	3/8" - 24 e	13,500	4" (100 mm) Type 27	Aluminum	2.4 lb 1.09 kg	9.1 in 231 mm	2.2 in	1/4 in

All tools performance rated @ 90 psi / 620 kPa air pressure.
Minimum Hose I.D.: 5/16 in / 7.9 mm
Standard Equipment: Wheel guard, wheel adapter, spindle wrench, Operating instructions & service manual

Cleco® 236 Series - Extended Head

13,500 RPM 0.8 hp (0.6 kW)

- Extended head for better excess ability reach
- Powerful and durable material removal
- Robust and long lasting angle head for the most demanding applications



Cat. No.	Exhaust	Spindle Size	Free Speed (rpm)	Abrasive Capacity	Type Housing	Weight	Length	Head Height	Air Inlet Size
236GLSB-135A-D3T4	Side	3/8" - 24 e	13,500	4" (100 mm) Type 27	Aluminum	2.0 lb 0.91 kg	9.6 in 244 mm	2.2 in	1/4 in
236GLRB-135A-D3T4	Rear	3/8" - 24 e	13,500	4" (100 mm) Type 27	Aluminum	2.0 lb 0.91 kg	7.6 in 193 mm	2.2 in	1/4 in
236GLFB-135A-D3T4	Front	3/8" - 24 e	13,500	4" (100 mm) Type 27	Aluminum	2.0 lb 0.91 kg	9.6 in 244 mm	2.2 in	1/4 in

All tools performance rated @ 90 psi / 620 kPa air pressure.

Minimum Hose I.D.: 1/4 in / 6.4 mm

Standard Equipment: Wheel guard, wheel adapter, spindle wrench, Operating instructions & service manual

DOTCO® 12-27 Series - Heavy Duty Head

14,500 RPM 0.9 hp (0.67 kW)

- Ergonomic composite housing
- Durable and low profile angle head
- Low vibration and high output motor provides superior productivity



Cat. No.	Spindle Size	Free Speed (rpm)	Abrasive Capacity	Type Housing	Weight	Length	Air Inlet Size
12L2714-28	3/8"	14,500	4" (100 mm) Type 1	Composite	3.2 lb 1.45 kg	8.0 in 203 mm	1/4 in
12L2718-28	3/8"	18,000	4" (100 mm) Type 1	Composite	3.2 lb 1.45 kg	8.0 in 203 mm	1/4 in

All tools performance rated @ 90 psi / 620 kPa air pressure.

Minimum Hose I.D.: 1/2 in / 12.7 mm

Standard Equipment: Wheel guard and flange wrench

Cleco® 236 Series - Heavy Duty Head

11,500 RPM 0.9 hp (0.6 kW)

- Rugged and durable aluminum housing
- Robust and long lasting angle head for the most demanding applications
- Renowned Cleco motor stays durable in the harshest environments



Cat. No.	Exhaust	Spindle Size	Free Speed (rpm)	Abrasive Capacity	Type Housing	Weight	Length	Head Height	Air Inlet Size
236GLR-115A-D3T45	Rear	3/8" - 24 e	11,500	4.5" (115 mm) Type 27	Aluminum	2.5 lb 1.13 kg	8.3 in 211 mm	3.2 in	1/4 in
236GLF-115A-D3T4	Front	3/8" - 24 e	11,500	4" (100 mm) Type 27	Aluminum	3.0 lb 1.36 kg	7.6 in 193 mm	3.2 in	1/4 in
236GLS-115A-D3T4	Side	3/8" - 24 e	11,500	4" (100 mm) Type 27	Aluminum	2.5 lb 1.13 kg	7.6 in 193 mm	3.2 in	1/4 in
236GLR-115A-D3T4	Rear	3/8" - 24 e	11,500	4" (100 mm) Type 27	Aluminum	2.5 lb 1.13 kg	8.3 in 211 mm	3.2 in	1/4 in
236GLF-115A-D3T45	Front	3/8" - 24 e	11,500	4.5" (115 mm) Type 27	Aluminum	3.0 lb 1.36 kg	7.6 in 193 mm	3.2 in	1/4 in
236GLR-115A-D3T5	Rear	3/8" - 24 e	11,500	5" (150 mm) Type 27	Aluminum	2.5 lb 1.13 kg	8.3 in 211 mm	3.2 in	1/4 in
236GLR-115A-D5T45	Rear	5/8" - 11 e	11,500	4.5" (115 mm) Type 27	Aluminum	2.5 lb 1.13 kg	8.3 in 211 mm	3.2 in	1/4 in
236GLRE-115A-D5T45	Rear	5/8" - 11 e	11,500	4.5" (115 mm) Type 27	Aluminum	3.5 lb 1.59 kg	7.6 in 193 mm	3.2 in	1/4 in
236GLS-115A-D5T45	Side	5/8" - 11 e	11,500	4.5" (115 mm) Type 27	Aluminum	2.5 lb 1.13 kg	7.6 in 193 mm	3.2 in	1/4 in

All tools performance rated @ 90 psi / 620 kPa air pressure.
Minimum Hose I.D.: 1/4 in / 6.4 mm
Standard Equipment: Wheel guard, wheel adapter, spindle wrench, Operating instructions & service manual

Cleco® 25 Series - Governed - Right Angle

6,000 - 8,500 RPM 1.4 hp (1.3 kW)

- Rugged and durable aluminum housing
- Powerful and robust motor with side exhaust
- Heavy duty angle head designed to outperform and outlast



Cat. No.	Spindle Size	Free Speed (rpm)	Abrasive Capacity	Type Housing	Weight	Length	Head Height	Air Inlet Size
25GL-60A-D5T7	5/8" - 11 e	6,000	7" (180 mm) Type 27	Aluminum	5.6 lb 2.54 kg	10.0 in 254 mm	4.0 in	3/8 in
25GL-77A-D5T7	5/8" - 11 e	7,700	7" (180 mm) Type 27	Aluminum	5.6 lb 2.54 kg	10.0 in 254 mm	4.0 in	3/8 in
25GL-85A-D5T7	5/8" - 11 e	8,500	7" (180 mm) Type 27	Aluminum	5.6 lb 2.54 kg	10.0 in 254 mm	4.0 in	3/8 in

All tools performance rated @ 90 psi / 620 kPa air pressure.
Minimum Hose I.D.: 3/8 in / 9.5 mm
Standard Equipment: Wheel guard, flange wrench, Operating instructions & service manual

Cleco® 1660 Series - Right Angle Grinder

- Compact, yet powerful 1.6 hp motor, governed at 12,000 rpm
- Available with 4", 4.5", 5" guard options
- Reversible safety lever throttle
- Dual auxiliary handle positions



Cat. No.	Spindle Size	Free Speed (rpm)	Abrasive Capacity	Type Housing	Weight	Length	Head Height	Air Inlet Size
1660AGL-04	3/8"- 24 e	12,000	4" (100 mm), Type 27/42	Aluminum	4.3 lb 1.95 kg	11.5 in 292 mm	2.7 in	1/2 in
1660AGL-05*	5/8"- 11 e	12,000	5" (125 mm), Type 27/42	Aluminum	4.3 lb 1.95 kg	11.5 in 292 mm	2.7 in	1/2 in
1660AGL-05-M14*	M14 e	12,000	5" (125 mm), Type 27/42	Aluminum	4.3 lb 1.95 kg	11.5 in 292 mm	2.7 in	1/2 in
1660AGL-45*	5/8"- 11 e	12,000	4.5" (115 mm), Type 27/42	Aluminum	4.3 lb 1.95 kg	11.5 in 292 mm	2.7 in	1/2 in

All tools performance rated @ 90 psi / 620 kPa air pressure.

Minimum Hose I.D.: 3/4 in / 19 mm

Standard Equipment: Wheel guard, adapters, spindle wrenches, operating instructions & service manuals

* Also compatible with Type 27/29 Abrasive

RIGHT ANGLE GRINDERS

Cleco® 2260 Series - Right Angle Grinder

- High performance 2.2 hp motor, Governed at 8,400 rpm
- Available with 6", 7" guard options
- Reversible safety lever throttle
- Dual auxiliary handle positions
- Maximum material removal for a right angle grinder



Cat. No.	Spindle Size	Free Speed (rpm)	Abrasive Capacity	Type Housing	Weight	Length	Head Height	Air Inlet Size
2260AGL-06	5/8"- 11 e	8,400	6" (150 mm), Type 27/42	Aluminum	7.3 lb 3.31 kg	12.1 in 307 mm	2.9 in	1/2 in
2260AGL-07	5/8"- 11 e	8,400	7" (180 mm), Type 27/42	Aluminum	7.3 lb 3.31 kg	12.1 in 307 mm	2.9 in	1/2 in

All tools performance rated @ 90 psi / 620 kPa air pressure.

Minimum Hose I.D.: 3/4 in / 19 mm

Standard Equipment: Wheel guard, adapters, spindle wrenches, operating instructions & service manuals

Cleco® 216 Series - Heavy Duty Head

11,500 RPM 0.6 hp (0.4 kW)

- Rugged and durable aluminum housing
- Robust and long lasting angle head for the most demanding applications
- Powerful motor stays durable in the harshest environments



Cat. No.	Exhaust	Spindle Size	Free Speed (rpm)	Abrasive Capacity	Type Housing	Weight	Length	Head Height	Air Inlet Size
216GLF-115A-W3T4	Front	3/8" - 24 e	11,500	4" (100 mm) Type 1	Aluminum	2.7 lb 1.22 kg	7.1 in 180 mm	3.2 in	1/4 in

All tools performance rated @ 90 psi / 620 kPa air pressure.
 Minimum Hose I.D.: 5/16 in / 7.9 mm
 Standard Equipment: Wheel guard, wheel adapter, spindle wrench, Operating instructions & service manual

Cleco® 216 Series - Extended Head

13,500 RPM 0.6 hp (0.4 kW)

- Rugged and durable aluminum housing
- Extended head for better reach and accessibility
- Lock-off lever for safe operation



Cat. No.	Exhaust	Spindle Size	Free Speed (rpm)	Abrasive Capacity	Type Housing	Weight	Length	Head Height	Air Inlet Size
216GLFB-135A-W3T4	Front	3/8" - 24 e	13,500	4" (100 mm) Type 1	Aluminum	2.1 lb 0.95 kg	9.6 in 244 mm	2.2 in	1/4 in
216GLSB-135A-W3T4	Side	3/8" - 24 e	13,500	4" (100 mm) Type 1	Aluminum	2.4 lb 1.09 kg	9.1 in 231 mm	2.2 in	1/4 in

All tools performance rated @ 90 psi / 620 kPa air pressure.
 Minimum Hose I.D.: 5/16 in / 7.9 mm
 Standard Equipment: Wheel guard, wheel adapter, spindle wrench, Operating instructions & service manual

Cleco® 236 Series - Heavy Duty Head

11,500 RPM 0.8 hp (0.6 kW)

- Rugged and durable aluminum housing
- Heavy duty and extended head models available
- Designed for heavy duty material removal applications



Cat. No.	Exhaust	Free Speed (rpm)	Abrasive Capacity	Type Housing	Weight	Length	Air Inlet Size
236GLF-115A-W3T4	Front	11,500	4" (100 mm) Type 1	Aluminum	3.0 lb 1.36 kg	7.6 in 193 mm	1/4 in
236GLR-115A-W3T4	Rear	11,500	4" (100 mm) Type 1	Aluminum	2.5 lb 1.13 kg	8.3 in 211 mm	1/4 in
236GLS-115A-W3T4	Side	11,500	4" (100 mm) Type 1	Aluminum	2.5 lb 1.13 kg	8.3 in 211 mm	1/4 in
236GLSB-115A-W3T4	Side	11,500	4" (100 mm) Type 1	Aluminum	2.0 lb 0.91 kg	9.6 in 244 mm	1/4 in

All tools performance rated @ 90 psi / 620 kPa air pressure.
 Minimum Hose I.D.: 1/2 in / 12.7 mm
 Standard Equipment: Wheel guard and flange wrench

Cleco® 236 Series - Extended Head

11,500 RPM 0.8 hp (0.6kW)

- Rugged and durable aluminum housing
- Heavy duty and extended head models available
- Designed for heavy duty material removal applications



Cat. No.	Exhaust	Free Speed (rpm)	Abrasive Capacity	Type Housing	Weight	Length	Air Inlet Size
236GLFB-135A-W3T4	Front	13,500	4" (100 mm) Type 1	Aluminum	2.0 lb 0.91 kg	9.6 in 244 mm	1/4 in
236GLRB-135A-W3T4	Rear	13,500	4" (100 mm) Type 1	Aluminum	2.0 lb 0.91 kg	7.6 in 193 mm	1/4 in
236GLSB-135A-W3T4	Side	13,500	4" (100 mm) Type 1	Aluminum	2.0 lb 0.91 kg	9.6 in 244 mm	1/4 in

All tools performance rated @ 90 psi / 620 kPa air pressure.
 Minimum Hose I.D.: 1/2 in / 12.7 mm
 Standard Equipment: Wheel guard and flange wrench

Cleco® 25 Series - Governed - Right Angle

- Rugged and durable all aluminum housing
- Vibration - dampened handle for operator comfort
- Balanced design works with the operator for maximum material removal



Cat. No.	Exhaust	Spindle Size	Free Speed (rpm)	Abrasive Capacity	Type Housing	Weight	Length	Head Height	Air Inlet Size
25GL-60A-W5T7	Side	5/8" - 11 e	6,000	7" (180 mm) Type 1	Aluminum	5.6 lb 2.54 kg	10.0 in 254 mm	4.0 in	3/8 in
25GL-85A-W5T7	Side	5/8" - 11 e	8,500	7" (180 mm) Type 1	Aluminum	5.6 lb 2.54 kg	10.0 in 254 mm	4.0 in	3/8 in

All tools performance rated @ 90 psi / 620 kPa air pressure.
 Minimum Hose I.D.: 3/8 in / 9.5 mm
 Standard Equipment: Wheel guard, flange wrench, Operating instructions & service manual

RIGHT ANGLE GRINDERS

Cleco® 1660 Series - Right Angle Grinder

- Compact, yet powerful 1.6 hp motor, governed at 12,000 rpm
- Available with 4", 4.5", 5" guard options
- Reversible safety lever throttle
- Dual auxiliary handle positions



Cat. No.	Spindle Size	Free Speed (rpm)	Abrasive Capacity	Type Housing	Weight	Length	Head Height	Air Inlet Size
1660AGL-04	3/8"- 24 e	12,000	4" (100 mm), Type 1	Aluminum	4.3 lb 1.95 kg	11.5 in 292 mm	2.7 in	1/2 in
1660AGL-05-M14*	M14 e	12,000	5" (125 mm), Type 1	Aluminum	4.3 lb 1.95 kg	11.5 in 292 mm	2.7 in	1/2 in
1660AGL-05*	5/8"- 11 e	12,000	5" (125 mm), Type 1	Aluminum	4.3 lb 1.95 kg	11.5 in 292 mm	2.7 in	1/2 in
1660AGL-45*	5/8"- 11 e	12,000	4.5" (115 mm), Type 1	Aluminum	4.3 lb 1.95 kg	11.5 in 292 mm	2.7 in	1/2 in

All tools performance rated @ 90 psi / 620 kPa air pressure.

Minimum Hose I.D.: 3/4 in / 19 mm

Standard Equipment: Wheel guard, adapters, spindle wrenches, operating instructions & service manuals

* Also compatible with Type 27/29 Abrasive

Cleco® 2260 Series - Right Angle Grinder

- High performance 2.2 hp motor, Governed at 8,400 rpm
- Available with 6", 7" guard options
- Reversible safety lever throttle
- Dual auxiliary handle positions
- Maximum material removal for a right angle grinder



Cat. No.	Spindle Size	Free Speed (rpm)	Abrasive Capacity	Type Housing	Weight	Length	Head Height	Air Inlet Size
2260AGL-06	5/8"- 11 e	8,400	6" (150 mm) Type 1	Aluminum	7.3 lb 3.31 kg	12.1 in 307 mm	2.9 in	1/2 in
2260AGL-07	5/8"- 11 e	8,400	7" (180 mm) Type 1	Aluminum	7.3 lb 3.31 kg	12.1 in 307 mm	2.9 in	1/2 in

All tools performance rated @ 90 psi / 620 kPa air pressure.

Minimum Hose I.D.: 3/4 in / 19 mm

Standard Equipment: Wheel guard, adapters, spindle wrenches, operating instructions & service manuals

Cleco® 236 Series - Inline

18,000 - 24,000 RPM 0.9 hp (0.7 kW)

- Rugged and durable aluminum housing
- Side and rear exhaust models available



Cat. No.	Exhaust	Spindle Size	Free Speed (rpm)	Abrasive Capacity	Type Housing	Weight	Length	Air Inlet Size
236GELR-180-P3T	Rear	3/8" - 24 e	18,000	1.25" (31 mm) Cone or Plug Wheel	Aluminum	2.3 lb 1.04 kg	12.3 in 312 mm	1/4 in
236GEL-240-P3T	Side	3/8" - 24 e	24,000	1.25" (31 mm) Cone or Plug Wheel	Aluminum	2.3 lb 1.04 kg	12.3 in 312 mm	1/4 in

All tools performance rated @ 90 psi / 620 kPa air pressure.
Standard Equipment: Applicable collet, collet wrenches
Minimum Hose I.D.: 5/16 in / 7.9 mm

Cleco® 25 Series - Extended

14,000 - 18,000 RPM 1.4 hp (1.3 kW)

- Rugged and durable aluminum housing
- Governor speed control maintains RPM under load
- Safety- lock throttle lever prevents accidental start up



Cat. No.	Spindle Size	Free Speed (rpm)	Abrasive Capacity	Type Housing	Weight	Length	Air Inlet Size
25GELC-140-P3T	3/8" - 24 e	14,000	2" (50 mm) Cone or Plug Wheel	Aluminum	3.0 lb 1.36 kg	14.5 in 368 mm	3/8 in
25GELC-180-P3T	3/8" - 24 e	18,000	2" (50 mm) Cone or Plug Wheel	Aluminum	3.0 lb 1.36 kg	14.5 in 368 mm	3/8 in
25GELC-180-P5T	5/8" - 11 e	18,000	2" (50 mm) Cone or Plug Wheel	Aluminum	3.2 lb 1.45 kg	14.9 in 378 mm	3/8 in

All tools performance rated @ 90 psi / 620 kPa air pressure.
Minimum Hose I.D.: 3/8 in / 9.5 mm
Standard Equipment: Wheel guard, flange wrench, Operating instructions & service manual

Cleco® 500B Series

9,000 - 12,000 RPM 2.1 hp (1.6 kW)

- Rugged and durable all-steel housing
- Air motor is governor- controlled to maintain RPM under heavy load
- High output motor designed to tackle the toughest material removal jobs



Cat. No.	Spindle Size	Free Speed (rpm)	Abrasive Capacity	Type Housing	Weight	Length	Air Inlet Size
5120BHL-P	5/8" - 11 e	12,000	3" Cone or Plug Wheel	Steel	7.6 lb 3.45 kg	17.9 in 455 mm	1/2 in
590BHL-P	5/8" - 11 e	9,000	3" Cone or Plug Wheel	Steel	7.6 lb 3.45 kg	17.9 in 455 mm	1/2 in

All tools performance rated @ 90 psi / 620 kPa air pressure.
Standard Equipment: Applicable wrenches, operating instructions & service manual
Minimum Hose I.D.: 5/16 in / 7.9 mm

Cleco® 236 Series - Inline

18,000 RPM 0.9 hp (0.7 kW)

- Rugged and durable aluminum housing
- Side and rear exhaust models available



Cat. No.	Spindle Size	Free Speed (rpm)	Abrasive Capacity	Type Housing	Weight	Length	Air Inlet Size
236GLR-180-W3T4	3/8" - 24 e	18,000	4" (100 mm) Type 1	Aluminum	1.8 lb 0.82 kg	7.3 in 185 mm	1/4 in

All tools performance rated @ 90 psi / 620 kPa air pressure.
Minimum Hose I.D.: 1/2 in / 12.7 mm
Standard Equipment: Wheel guard and flange wrench

Cleco® 25 Series - Extended

12,000 - 18,000 RPM 1.4 hp (1.0 kW)

- Powerful motor for all cut-off operations
- Governed motor with side exhaust
- Rugged and durable for any environment



Cat. No.	Spindle Size	Free Speed (rpm)	Abrasive Capacity	Weight	Length	Air Inlet Size
25GELC-120-W3T25	3/8" - 24 e	12,000	2.5" (63 mm) Type 1	3.4 lb 1.54 kg	14.4 in 366 mm	3/8 in
25GELC-120-W3T3	3/8" - 24 e	12,000	3" (75 mm) Type 1	3.7 lb 1.68 kg	14.4 in 366 mm	3/8 in
25GELC-120-W3T4	3/8" - 24 e	12,000	4" (100 mm) Type 1	3.7 lb 1.68 kg	14.4 in 366 mm	3/8 in
25GELC-140-W3T3	3/8" - 24 e	14,000	3" (75 mm) Type 1	3.7 lb 1.68 kg	14.5 in 368 mm	3/8 in
25GELC-180-W3T3	3/8" - 24 e	18,000	3" (75 mm) Type 1	3.7 lb 1.68 kg	14.9 in 378 mm	3/8 in
25GL-120-W3T4*	3/8" - 24 e	12,000	4" (100 mm) Type 1	3.0 lb 1.36 kg	10.0 in 254 mm	3/8 in

All tools performance rated @ 90 psi / 620 kPa air pressure.
Minimum Hose I.D.: 3/8 in / 9.5 mm
* Non-extended version
Standard Equipment: Wheel guard, flange wrench, Operating instructions & service manual

Cleco® 500B Series

6,000 RPM 1.9 hp (1.4 kW)

- Safety lever or spade handle available
- Suitable for the most demanding horizontal grinding applications
- Robust and efficient design trusted for decades



Cat. No.	Spindle Size	Throttle Type	Free Speed (rpm)	Abrasive Capacity	Type Housing	Weight	Length	Air Inlet Size
560BHX-16	5/8" - 11 e	Spade	6,000	6" x 1" (150 mm x 25 mm) Type 1	Steel	11.6 lb 5.26 kg	18.8 in 478 mm	1/2 in
560BHL-16	5/8" - 11 e	Lever	6,000	6" x 1" (150 mm x 25 mm) Type 1	Steel	10.8 lb 4.90 kg	18.4 in 467 mm	1/2 in

All tools performance rated @ 90 psi / 620 kPa air pressure.
Minimum Hose I.D.: 1/2 in / 12.7 mm
Standard Equipment: Wheel guard and flange wrench

Cleco® 1700 Series - Lock-Off Lever Throttle

6,000 RPM 3.1 hp (2.3 kW)

- Spade handle availability
- Safety- lock throttle lever prevents accidental start up
- High output motor designed to tackle the toughest material removal jobs



Cat. No.	Spindle Size	Free Speed (rpm)	Abrasive Capacity	Type Housing	Weight	Length	Air Inlet Size
1760HL-16	5/8" - 11 e	6,000	6" x 1" (150 mm x25 mm) Type 1	Steel	14.5 lb 6.58 kg	19.6 in 498 mm	1/2 in

All tools performance rated @ 90 psi / 620 kPa air pressure.
Minimum Hose I.D.: 1/2 in / 12.7 mm
Standard Equipment: Wheel guard and flange wrench

Cleco® 1900 Series - Inline

6,000 RPM 4.1 hp (3.1 kW)

- Governed air motor- controlled to maintain RPM under heavy load
- High output motor designed to tackle the toughest material removal jobs
- Safety- lock throttle lever prevents accidental start up



Cat. No.	Spindle Size	Throttle Type	Free Speed (rpm)	Abrasive Capacity	Type Housing	Weight	Length	Air Inlet Size
1960HG-16	5/8" - 11 e	Spade	6,000	6" x 1" (150 mm x 25 mm) Type 1	Aluminum	16.8 lb 7.62 kg	21.4 in 544 mm	1/2 in
1960HL-16	5/8" - 11 e	Lever	6,000	6" x 1" (150 mm x 25 mm) Type 1	Aluminum	16.8 lb 7.62 kg	21.4 in 544 mm	1/2 in

All tools performance rated @ 90 psi / 620 kPa air pressure.
Minimum Hose I.D.: 1/2 in / 12.7 mm
Standard Equipment: Wheel guard and flange wrench

Cleco® 3060 Series

6,000 RPM 3.0 hp (2.3 kW)

- Powerful, governed motor
- Ideally suited for the most rugged environments
- Maximum material removal in an ergonomic package



Cat. No.	Spindle Size	Free Speed (rpm)	Abrasive Capacity	Weight	Height	Air Inlet Size
3060AVL-06	5/8" - 11 e	6,000	6" (150 mm) Type 11	10.2 lb 4.63 kg	6.9 in 175 mm	1/2 in
3060AVL-07	5/8" - 11 e	6,000	7" (180 mm) Type 27	9.7 lb 4.40 kg	6.9 in 175 mm	1/2 in
3060AVL-09	5/8" - 11 e	6,000	9" (230 mm) Type 27	10.4 lb 4.72 kg	6.9 in 175 mm	1/2 in

All tools performance rated @ 90 psi / 620 kPa air pressure.
 Minimum Hose I.D.: 3/4 in / 19 mm
 Standard Equipment: Wheel guard, adapters, spindle wrenches, operating instructions & service manuals

Cleco® 4060 Series

6,000 RPM 4.0 hp (3.1 kW)

- Maximum material removal in any application
- Powerful motor delivering ultimate torque
- Ideally suited for any heavy metal fabrication process



Cat. No.	Spindle Size	Free Speed (rpm)	Abrasive Capacity	Weight	Height	Air Inlet Size
4060AVL-06	5/8" - 11 e	6,000	6" (150 mm) Type 11	11.6 lb 5.26 kg	8.2 in 208 mm	1/2 in
4060AVL-07	5/8" - 11 e	6,000	7" (180 mm) Type 27	11.1 lb 5.03 kg	8.2 in 208 mm	1/2 in
4060AVL-09	5/8" - 11 e	6,000	9" (230 mm) Type 27	11.8 lb 5.35 kg	8.2 in 208 mm	1/2 in

All tools performance rated @ 90 psi / 620 kPa air pressure.
 Minimum Hose I.D.: 3/4 in / 19 mm
 Standard Equipment: Wheel guard, adapters, spindle wrenches, operating instructions & service manuals

Cleco Wheel Guards

Tool Series	vSize	Part No.	Speed (rpm)
Type 1 Wheel			
216RA, 236RA	3"/75 mm	202226	13,500 & 16,500
216RA, 236RA	4"/100 mm	889208	11,500
216RA, 236RA	4"/100 mm	202227	13,500 & 16,500
236, 25	3"/75 mm	202278	
236, 25	4"/100 mm	202245	
25GL RA	7"/180 mm	204131	
25G Inline	3"/75 mm	865786	
25G Inline	4"/100 mm	865988	
500BH	4"/100 mm	881608	9,000 & 12,000
500BH	6"/150 mm	865993	6,000
1700, 1900 Inline	6"/150 mm	202022	
1700, 1900 Inline	8"/205 mm	202025	

Type 27 Wheel

25GL RA	7"/180 mm	865986	
136V	3"/75 mm	849905	
136V	4"/100 mm	203382	
216RA, 236RA	4"/100 mm	889208	11,500
216RA, 236RA	4 1/2"/100 mm	202063	11,500
216RA, 236RA	3"/75 mm	202226	13,500 & 16,500
216RA, 236RA	4"/115 mm	202227	13,500 & 16,500
216RA, 236RA	5"/125 mm	203142	11,500
15V	7"/180 mm	849760	
1200V	7"/180 mm	202374	
1200V	9"/230 mm	202608	
3060V, 4060V	9"/230 mm	207752PT	
3060V, 4060V	7"/180 mm	207751PT	

Type 28 Wheel

15V	7"/180 mm	849760	
1200V	7"/180 mm	202374	
25GL RA	7"/180 mm	865986	

Type 6 & 11 (Cup) Wheel

1200V	4"/100 mm	202465	
3060V, 4060V	6"/150 mm	207750PT	

DOTCO Wheel Guards

Model Number	Wheel Size	Guard No.
Tool Series*		

Stationary Cup Wheel Guards

10-53 & 10-58	6" (152 mm)	14-5002
---------------	-------------	---------

Type 1 (Cut-Off) Wheel Guards

12-10	3" x 3/16" (76 mm x 4.8 mm)	14-1018
12-12	3" x 3/16" (76 mm x 4.8 mm)	14-1258
12-20 & 12-25	3" x 3/16" (76 mm x 4.8 mm)	14-2624
12-22 & 12-27 (LP)	3" x 3/16" (76 mm x 4.8 mm)	14-1258
12-25	4" x 3/16" (102 mm x 4.8 mm)	14-2623
12-22 & 12-27 (LP)	4" x 3/16" (102 mm x 4.8 mm)	14-1259

Type 1 Wheel Guards

12-25	3" x 1/2" (76 mm x 13 mm)	14-2551
12-26	3" x 1/2" (76 mm x 13 mm)	14-2097
12-31	3" x 1/2" (76 mm x 13 mm)	14-3011
12-41	3" x 1" (76 mm x 25 mm)	14-3011
12-41	4" x 1" (102 mm x 25 mm)	14-4074
12-51	6" x 1" (152 mm x 25 mm)	14-5012
10-56	8" x 1" (203 mm x 25 mm)	14-5022

Type 27 Depressed Center Wheel Guards

12-22 & 12-27 (LP)	3" (76 mm)	14-2593
12-28 (NG)	3" (76 mm)	14-2564
12-22 & 12-27	4" (102 mm)	14-2562
12-22 & 12-27 (LP)	4" (102 mm)	14-2594
12-27	4.5" (115 mm)	14-2672
12-27	5" (127 mm)	14-2252
12-22 & 12-27	5" (127 mm)	14-2152
12-42	7" (178 mm)	14-2123
10-53 & 10-58	7" (178 mm)	14-5018
10-53 & 10-58	9" (229 mm)	14-5017

Type 28 Depressed Center Wheel Guards

10-53 & 10-58	7" (178 mm)	14-5018
10-53 & 10-58	9" (229 mm)	14-5019

LP = Low Profile
NG = Non-Governed



Part Number	Collet Size	Tool Termination	Capacity		Tool Series*			
			Min.	Max.	10-04	10-90	12-03	12-04
Series HG Collets								
103	1/16"	-04 or -14	-	1/16"	OPT	OPT		
102	3/32"	-06 or -16	-	3/32"	STD	OPT		STD
01-0102	3/32"	-16	-	3/32"			STD	
100	1/8"	-08 or -18	-	1/8"	STD	STD		STD
01-0100	1/8"	-18	-	1/8"			STD	
146	1 mm	-00 or -10	-	1 mm	OPT	OPT		
131	2.35 mm	-02 or -12	-	2.35 mm	OPT	OPT		
148	3 mm	-03 or -13	-	3 mm	STD	STD		STD
01-0148	3 mm	-13	-	3 mm			STD	

Part Number	Collet Size	Tool Termination	Capacity		Tool Series*					
			Min.	Max.	10-95	12-10 12-11 12-12	12-20 12-25	12-21 12-22 12-26 12-27 12-31	10-43 11-43	12-05 12-22 12-27

Universal Collets

	7809	1/8"	-4508	-	1/8"							OPT
	7812	3/16"	-4512	-	3/16"							OPT
	7808	1/4"	-45	-	1/4"							STD
	7810	3 mm	-45M3	-	3 mm							OPT
	7811	6 mm	-45M6	-	6 mm							OPT

"K" Series Collets

	120	1/8"	-6208	3/32"	1/8"							OPT
	121	3/16"	-6212	5/32"	3/16"							OPT
	122	1/4"	-6216	7/32"	1/4"							OPT
	123	5/16"	-6220	9/32"	5/16"							OPT
	124	3/8"	-62	11/32"	3/8"							STD
	125	7/16"	-6228	13/32"	7/16"							OPT
	126	1/2"	-6232	15/32"	1/2"							OPT
	134	8 mm	-62M8	-	8 mm							OPT
	135	10 mm	-6270	-	10 mm							OPT

Series 200 Collets

	204	1/8"	-0108	3/32"	1/8"			OPT	OPT		
	205	5/32"	-0110	1/8"	5/32"			OPT	OPT		
	206	3/16"	-0112	5/32"	3/16"			OPT	OPT		
	207	7/32"	-0114	3/16"	7/32"			OPT	OPT		
	208	1/4"	-01	7/32"	1/4"			STD	STD		
	209	9/32"	-0118	1/4"	9/32"			OPT	OPT		
	210	5/16"	-0120	9/32"	5/16"			OPT	OPT		
	211	11/32"	-0122	5/16"	11/32"			OPT	OPT		
	212	3/8"	-0124	11/32"	3/8"			OPT	OPT		
	213	6 mm	-01M6	5.2 mm	6 mm			OPT	OPT		
	216	8 mm	-01M8	7.2 mm	8 mm			OPT	OPT		

Series 300 Collets

	301	3/64"	-3603	1/64"	3/64"			OPT	OPT		OPT
	302	5/64"	-3605	3/64"	5/64"			OPT	OPT		OPT
	303	3/32"	-3606	1/16"	3/32"			OPT	OPT		OPT
	304	1/8"	-3608	3/32"	1/8"	STD		OPT	OPT		OPT
	305	5/32"	-3610	1/8"	5/32"			OPT	OPT		OPT
	306	3/16"	-3612	5/32"	3/16"			OPT	OPT		OPT
	308	1/4"	-36	7/32"	1/4"	OPT		STD	STD		STD
	311	3 mm	-36M3	2.2 mm	3 mm			OPT	OPT		OPT
	310	6 mm	-36M6	5.2 mm	6 mm			OPT	OPT		OPT

* STD = Standard Collet
OPT = Optional Collet

Spiral Cool Sanding Kits

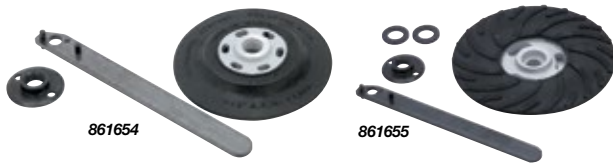

Part No.	Size	Used On
861792	5"	216RA, 236RA
861655	7"	25RA, 15V, 1200V

Type 27 & 28 Wheel Adapter Kit



Part Number	Used On
849269	15V, 1200V, 3060V, 4060V

Long Collet Guard

Completely covers the collet. Limits the diameter of the cutting tool used to 5/8".



Part Number	Tool Series
1020	12-10

Noise Suppressor Guard

Completely covers the collet. Limits the diameter of the cutting tool used to 1/2". Air is exhausted at an angle.



Part Number	Tool Series
14-2188	12-10 front exhaust tools only

Turbine Collet Guard

Slips on and off tool with a slight twist.



Part Number	Tool Series
14-1280	10-9000

Overhose for 236* Grinders

Part Number	Description
869580	Exhaust Overhose
869204	Overhose Adapter
202343	Hose Clamp

* Rear exhaust models only



Depressed Center Wheel Adapters

Adapt abrasive with a 7/8" arbor tool with 5/8-11 thread.

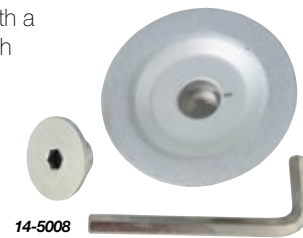

Part Number	Description
14-5008	Metal Flange

Toolpost Holders

Special high-speed machining operations can be made with this lathe mounted cross-slide attachment. Swivel holder permits positioning the grinder thru 180° arc.



Part Number	Tool Series
14-0991	10-04

Venturi-X Vacuum/Blow Gun Kit

Kit includes accessories, reusable vacuum bag, and blowmold carrying case. Vacuum can extract metal shavings, liquids, dust, wood chips, etc. Converts to blow gun to clear debris from work area or floor.



Part Number	Description
VX-1KIT	Venturi-X Kit
VX-1A	1 bag, 1 brush, 1 flat tube, 1 small diameter vacuum tube, 1 flexible tube
VX-1B	1 dust bag, 3 O-rings, 2 O-rings

SANDERS, BUFFERS, POLISHERS

DOTCO® Sanders, Buffers, and Polishers are available in a variety of styles and power ratings to provide flexibility in choosing the best tool for the job. Disc sanding and polishing, wire brushes, buffing wheels, abrasive sheets, woven or non-woven belts. No matter the application, Dotco has a quality tool solution.

Dotco belt sanders can grind corners, enter grooves, debur, strap polish or enter channels. The unique belt cover makes belt changes quick and easy. You can use non-woven nylon or coated abrasive belts on a variety of surfaces.

The unique sanding attachment pivots 360 degrees to allow user flexibility in reaching confined areas. The belt cover snaps on/off easily with no special tools needed allowing for quick belt changes. The arm itself is interchangeable to best suit a variety of applications.





DOTCO® 12LF Series - 300 Series Collet

12,000 - 20,000 RPM 0.4 hp (0.29 kW)

- Composite housing
- Wide array of speeds; front and rear exhaust models available
- Ergonomic and balanced design minimized operator fatigue



Exhaust		Termination	Free Speed (rpm)	Abrasive Capacity	Type Housing	Weight	Length	Head Height
Rear	Front							
Cat. No.	Cat. No.							
12LF280-36	12LF200-36	1/4" Collet	12,000	3" (75 mm) Sanding/ Polishing disc	Composite	1.1 lb 0.50 kg	6.6 in 168 mm	2.7 in
—	12LF200-32	1/4"- 28 i	12,000	3" (75 mm) Sanding/ Polishing disc	Composite	1.1 lb 0.50 kg	6.6 in 168 mm	2.7 in
12LF281-36	12LF201-36	1/4" Collet	20,000	2" (50 mm) Sanding/ Polishing disc	Composite	1.1 lb 0.50 kg	6.6 in 168 mm	2.7 in
—	12LF201-32	1/4"- 28 i	20,000	2" (50 mm) Sanding/ Polishing disc	Composite	1.1 lb 0.50 kg	6.6 in 168 mm	2.7 in

All tools performance rated @ 90 psi / 620 kPa air pressure.
Standard Equipment: Applicable collet, collet wrenches
Minimum Hose I.D.: 1/4 in / 4.8 mm

DOTCO® 10LF Series - 300 Series Collet

12,000 - 20,000 RPM 0.4 hp (0.29 kW)

- Aluminum housing
- Wide array of speeds; front and rear exhaust models available
- Ergonomic and balanced design minimized operator fatigue



Exhaust		Termination	Free Speed (rpm)	Abrasive Capacity	Type Housing	Weight	Length	Head Height
Front	Rear							
Cat. No.	Cat. No.							
10LF200-36	10LF280-36	1/4" Collet	12,000	3" (75 mm) Sanding/ Polishing Disc	Aluminum	1.1 lb 0.50 kg	6.6 in 168 mm	2.7 in
10LF200-32	—	1/4"- 28 i	12,000	3" (75 mm) Sanding/ Polishing Disc	Aluminum	1.1 lb 0.50 kg	6.6 in 168 mm	2.9 in
10LF201-36	10LF281-36	1/4" Collet	20,000	2" (50 mm) Sanding/ Polishing Disc	Aluminum	1.1 lb 0.50 kg	6.6 in 168 mm	2.7 in
10LF201-32	—	1/4"- 28 i	20,000	2" (50 mm) Sanding/ Polishing Disc	Aluminum	1.1 lb 0.50 kg	6.6 in 168 mm	2.9 in

All tools performance rated @ 90 psi / 620 kPa air pressure.
Standard Equipment: Applicable collet, collet wrenches
Minimum Hose I.D.: 1/4 in / 4.8 mm

DOTCO[®] 10-12 & 12-12 Series

- Composite housing
- Front and rear exhaust available
- Wide range of speeds to suit every application



Exhaust		Termination	Free Speed (rpm)	Abrasive Capacity	Type Housing	Weight	Length	Head Height	Air Inlet Size
Front	Rear								
Cat. No.	Cat. No.								
12L1200-32	12L1280-32	1/4"- 28 i	12,000	3" (75 mm) Sanding/ Polishing Disc	Composite	1.1 lb 0.50 kg	6.3 in 160 mm	1.9 in	1/4 in
10B1200-32*	—	1/4"- 28 i	12,000	3" (75 mm) Sanding/ Polishing Disc	Composite	1.0 lb 0.45 kg	5.0 in 127 mm	1.9 in	1/4 in
10L1200-32	—	1/4"- 28 i	12,000	3" (75 mm) Sanding/ Polishing Disc	Composite	1.0 lb 0.45 kg	5.0 in 127 mm	1.9 in	1/4 in
12L1201-32	12L1281-32	1/4"- 28 i	20,000	2" (50 mm) Sanding/ Polishing Disc	Composite	1.1 lb 0.50 kg	6.3 in 160 mm	1.9 in	1/4 in

All tools performance rated @ 90 psi / 620 kPa air pressure.
Minimum Hose I.D.: 1/4 in / 4.8 mm
Standard Equipment: Applicable collet, collet wrenches
* Button Activation

DOTCO[®] 12-13 Series - Gearless - 300 Series Collet

20,000 - 30,000 RPM 0.3 hp (0.22 kW)

- Composite housing
- Wide array of speeds offered; front and rear exhaust models available
- Suitable for a wide range of finishing applications



Exhaust		Collet Size	Termination	Free Speed (rpm)	Abrasive Capacity	Type Housing	Weight	Length	Head Height
Front	Rear								
Cat. No.	Cat. No.								
12L1302-36	12L1382-36	1/4 in	1/4" Collet	20,000	2" (50 mm) Sanding/ Polishing Disc	Composite	1.1 lb 0.50 kg	7.1 in 180 mm	3.7 in
12L1301-36	12L1381-36	1/4 in	1/4" Collet	25,000	2" (50 mm) Sanding/ Polishing Disc	Composite	1.1 lb 0.50 kg	7.1 in 180 mm	3.7 in
12L1301-32	—	-	1/4"- 28 i	25,000	2" (50 mm) Sanding/ Polishing Disc	Composite	1.1 lb 0.50 kg	7.1 in 180 mm	3.7 in
12L1300-36	12L1380-36	1/4 in	1/4" Collet	30,000	1" (25 mm) Sanding/ Polishing Disc	Composite	1.1 lb 0.50 kg	7.1 in 180 mm	3.7 in
12L1300-32	—	-	1/4"- 28 i	30,000	1" (25 mm) Sanding/ Polishing Disc	Composite	1.1 lb 0.50 kg	7.1 in 180 mm	3.7 in

All tools performance rated @ 90 psi / 620 kPa air pressure.
Standard Equipment: Applicable collet, collet wrenches
Minimum Hose I.D.: 1/4 in / 4.8 mm

DOTCO® 12-22 Series - 300 Series Collet

18,000 RPM 0.6 hp (0.45 kW)

- Ergonomic composite housing
- Heavy duty low profile head for greater accessibility
- High output motor in a lightweight package
- 3" Extended head available



Cat. No.	Termination	Free Speed (rpm)	Extension	Abrasive Capacity	Type Housing	Weight	Length
12L2277-36	1/4" Collet	12,000	3 in	4" (100 mm) Sanding/ Polishing Disc	Composite	2.2 lb 1.00 kg	10.0 in 254 mm
12L2278-36	1/4" Collet	14,500	3 in	4" (100 mm) Sanding/ Polishing Disc	Composite	2.2 lb 1.00 kg	10.0 in 254 mm
12L2218-36	1/4" Collet	18,000	0 in	3" (50 mm) Sanding/ Polishing Disc	Composite	1.7 lb 0.77 kg	7.5 in 191 mm

All tools performance rated @ 90 psi / 620 kPa air pressure.
Standard Equipment: Applicable collet, collet wrenches
Minimum Hose I.D.: 5/16 in / 7.9 mm

DOTCO® 12-22 Series - Heavy Duty Head

9,000 RPM 0.6 hp (0.45 kW)

- Ergonomic composite housing
- Heavy duty low profile head for greater accessibility
- high output motor in a lightweight package



Cat. No.	Termination	Free Speed (rpm)	Abrasive Capacity	Type Housing	Weight	Length	Head Height	Air Inlet Size
12L2251-80	5/8" - 11 e	9,000	5" (125 mm) Sanding/ Polishing Disc	Composite	3.2 lb 1.45 kg	9.3 in 236 mm	3.9 in	1/4 in

All tools performance rated @ 90 psi / 620 kPa air pressure.
Minimum Hose I.D.: 5/16 in / 7.9 mm
Standard Equipment: Applicable collet, collet wrenches

DOTCO® 12-27 Series - 300 Series Collet

18,000 RPM 0.9 hp (0.67 kW)

- Composite housing
- Powerful motor with rear exhaust
- Robust design perfectly suited for industrial applications
- Standard 3" extension



Cat. No.	Termination	Free Speed (rpm)	Abrasive Capacity	Type Housing	Weight	Length
12L2777-36	1/4" Collet	12,000	4" (100 mm) Sanding/ Polishing Disc	Composite	2.3 lb 1.04 kg	10.5 in 267 mm
12L2776-36	1/4" Collet	13,500	4" (100 mm) Sanding/ Polishing Disc	Composite	2.3 lb 1.04 kg	10.5 in 267 mm
12L2778-36	1/4" Collet	14,500	4" (100 mm) Sanding/ Polishing Disc	Composite	2.3 lb 1.04 kg	10.5 in 267 mm

All tools performance rated @ 90 psi / 620 kPa air pressure.
Standard Equipment: Applicable collet, collet wrenches
Minimum Hose I.D.: 5/16 in / 7.9 mm

DOTCO® 12-27 & 10-27 Series - Heavy Duty Head

3,300 - 11,000 RPM 0.9 hp (0.67 kW)

- Aluminum and Composite housing available
- High output motor for demanding sanding applications
- Heavy duty low profile head for superior durability



Cat. No.	Termination	Free Speed (rpm)	Abrasive Capacity	Type Housing	Weight	Length	Head Height	Air Inlet Size
10L2760-80	5/8" - 11 e	3,300	4" (102 mm) Wire Brush, 6" (152 mm) Buffing Wheel	Aluminum	3.9 lb 1.77 kg	9.3 in 236 mm	3.9 in	1/4 in
12L2760-80	5/8" - 11 e	3,300	7" (178 mm) Sanding/ Polishing Disc	Composite	3.9 lb 1.77 kg	10.5 in 267 mm	3.9 in	1/4 in
12L2762-80	5/8" - 11 e	4,500	7" (178 mm) Sanding/ Polishing Disc	Composite	3.9 lb 1.77 kg	10.5 in 267 mm	3.9 in	1/4 in
10L2750-80	5/8" - 11 e	6,000	7" (178 mm) Sanding/ Polishing Disc	Aluminum	3.1 lb 1.41 kg	8.5 in 216 mm	3.9 in	1/4 in
12L2750-80	5/8" - 11 e	6,000	7" (178 mm) Sanding/ Polishing Disc	Composite	3.4 lb 1.54 kg	9.8 in 249 mm	3.9 in	1/4 in
12L2761-80	5/8" - 11 e	6,000	7" (178 mm) Sanding/ Polishing Disc	Composite	3.9 lb 1.77 kg	10.5 in 267 mm	3.9 in	1/4 in
10L2751-80	5/8" - 11 e	9,000	5" (127 mm) Sanding/ Polishing Disc	Aluminum	3.1 lb 1.41 kg	8.5 in 216 mm	3.9 in	1/4 in
12L2751-80	5/8" - 11e	9,000	5" (127 mm) Sanding/ Polishing Disc	Composite	3.4 lb 1.54 kg	9.8 in 249 mm	3.9 in	1/4 in
12L2752-80	5/8" - 11 e	11,000	4" (102 mm) Sanding/ Polishing Disc	Composite	3.4 lb 1.54 kg	9.8 in 249 mm	3.9 in	1/4 in
10L2752-80	5/8" - 11 e	11,000	4" (100mm) Sanding/ Polishing Discs	Aluminum	3.4 lb 1.54 kg	8.6 in 218 mm	3.9 in	1/4 in

All tools performance rated @ 90 psi / 620 kPa air pressure.
Minimum Hose I.D.: 5/16 in / 7.9 mm
Standard Equipment: Applicable collet, collet wrenches

DOTCO® 12-12 Series - Belt Sander

12,000 - 20,000 RPM 0.3 hp (0.22 kW)

- Grind, deburr, strap polish, blend
- Choice of geared or gearless
- Ergonomic housing reduces cold air transmission to operator



Cat. No.	Free Speed (rpm)	Abrasive Capacity	Type Housing	Weight	Length	Air Inlet Size
12L1280-36B2	12,000	1/2" W x 12" L Sanding Belt	Composite	1.4 lb 0.64 kg	11.3 in 287 mm	1/4 in
12L1281-36B2	20,000	1/2" W x 12" L Sanding Belt	Composite	1.4 lb 0.64 kg	11.3 in 287 mm	1/4 in

All tools performance rated @ 90 psi / 620 kPa air pressure.

Minimum Hose I.D.: 1/4 in / 4.8 mm

Standard Equipment: No.80 and No.120 grit sanding belt or one medium grit non-woven belt, applicable wrenches, grease gun, gear lube

Optional Terminations, All models may not be available: -32Bx 1/4"-28 Internal Thread; -36Bx 1/4" collet

DOTCO® 12-13 Series - Gearless - Belt Sander

20,000 RPM 0.3 hp (0.22 kW)

- Grind, deburr, strap polish, blend
- Choice of geared or gearless
- Ergonomic housing reduces cold air transmission to operator



Cat. No.	Free Speed (rpm)	Abrasive Capacity	Type Housing	Weight	Length	Air Inlet Size
12L1382-36B2	20,000	1/2" W x 12" L Sanding Belt	Composite	1.4 lb 0.64 kg	11.3 in 287 mm	1/4 in
12L1382-36B4	20,000	1" W x 12" L Sanding Belt	Composite	1.7 lb 0.77 kg	11.3 in 287 mm	1/4 in

All tools performance rated @ 90 psi / 620 kPa air pressure.

Minimum Hose I.D.: 1/4 in / 4.8 mm

Standard Equipment: No.80 and No.120 grit sanding belt or one medium grit non-woven belt, applicable wrenches, grease gun, gear lube

Optional Terminations, All models may not be available: -32Bx 1/4"-28 Internal Thread; -36Bx 1/4" collet

DOTCO® 12-23 Series - Gearless

20,000 RPM 0.5 hp (0.38 kW)

- Grind, deburr, strap polish, blend
- Choice of geared or gearless
- Ergonomic housing reduces cold air transmission to operator



Cat. No.	Free Speed (rpm)	Abrasive Capacity	Type Housing	Weight	Length	Air Inlet Size
12L2384-B1	20,000	5/8" or 3/4" W x 18" L Sanding Belt	Composite	2.5 lb 1.13 kg	15.0 in 381 mm	1/4 in

All tools performance rated @ 90 psi / 620 kPa air pressure.

Minimum Hose I.D.: 1/4 in / 4.8 mm

Standard Equipment: No.80 and No.120 grit sanding belt or one medium grit non-woven belt, applicable wrenches, grease gun, gear lube

DOTCO® 12L2384-K1 Kit

- Kit comes with tool and all three interchangeable arms, belts, and wrenches
- Kit includes 12L2384-B1 tool along with: 2 additional abrasives, multiple belt sizes, all required wrenches, collet cap and chuck body



Cat. No.	Description
12L2384-K1	Sander - Belt - Kit

DOTCO® 12-10 Series - 200 Series Collet

3,200 - 5,000 RPM 0.3 hp (0.22 kW)

- Ergonomic composite housing
- Parts interchangeable with numerous other Dotco products
- Lightweight and compact design with powerful geared motor



Cat. No.	Collet Size	Free Speed (rpm)	Abrasive Capacity	Type Housing	Weight	Length	Air Inlet Size
12L1088-01	1/4 in	380	4" (100 mm) Wire Brush, 5" (125 mm) Wire Brush	Composite	2.2 lb 1.00 kg	8.6 in 218 mm	1/4 in
12L1092-01	1/4 in	3,200	3" (75 mm) Wire Brush, 3" (75 mm) Buffing Wheel	Composite	1.6 lb 0.73 kg	7.2 in 183 mm	1/4 in
12L1093-01	1/4 in	5,000	3" (75 mm) Wire Brush, 3" (75 mm) Buffing Wheel	Composite	1.6 lb 0.73 kg	7.2 in 183 mm	1/4 in

All tools performance rated @ 90 psi / 620 kPa air pressure.
Minimum Hose I.D.: 1/4 in / 6.4 mm
Standard Equipment: Applicable collet, collet wrenches

DOTCO® 12-25 & 10-25 Series - Buffer - 200 Series Collet

3,200 - 6,200 RPM 0.9 hp (0.67 kW)

- Ergonomic composite housing
- Parts interchangeable with numerous other Dotco products
- Lightweight and compact design with powerful geared motor



Cat. No.	Collet Size	Free Speed (rpm)	Abrasive Capacity	Type Housing	Weight	Length	Air Inlet Size
12L2592-01	1/4 in	3,200	4"(100 mm) Wire Brush, 6" (150 mm) Buffing Wheel	Composite	2.1 lb 0.95 kg	9.3 in 236 mm	1/4 in
10L2592-01	1/4 in	3,200	4"(100 mm) Wire Brush, 6" (150 mm) Buffing Wheel	Aluminum	2.2 lb 1.00 kg	8.9 in 226 mm	1/4 in
12L2593-01	1/4 in	4,700	4"(100 mm) Wire Brush, 6" (150 mm) Buffing Wheel	Composite	2.1 lb 0.95 kg	9.3 in 236 mm	1/4 in
12L2594-01	1/4 in	6,200	4"(100 mm) Wire Brush, 6" (150 mm) Buffing Wheel	Composite	2.1 lb 0.95 kg	9.3 in 236 mm	1/4 in

All tools performance rated @ 90 psi / 620 kPa air pressure.
Minimum Hose I.D.: 5/16 in / 7.9 mm
Standard Equipment: Applicable collet, collet wrenches

DOTCO® 12-27 & 10-27 Series - Heavy Duty Head

3,300 - 11,000 RPM 0.9 hp (0.67 kW)

- Aluminum and Composite housing available
- high output motor for demanding sanding applications
- heavy duty low profile head for superior durability



Cat. No.	Termination	Free Speed (rpm)	Abrasive Capacity	Type Housing	Weight	Length	Head Height	Air Inlet Size
10L2760-80	5/8" - 11 e	3,300	4" (102 mm) Wire Brush, 6" (152 mm) Buffing Wheel	Aluminum	3.9 lb 1.77 kg	9.3 in 236 mm	3.9 in	1/4 in
12L2760-80	5/8" - 11 e	3,300	7" (178 mm) Sanding/ Polishing Disc	Composite	3.9 lb 1.77 kg	10.5 in 267 mm	3.9 in	1/4 in
12L2762-80	5/8" - 11 e	4,500	7" (178 mm) Sanding/ Polishing Disc	Composite	3.9 lb 1.77 kg	10.5 in 267 mm	3.9 in	1/4 in
10L2750-80	5/8" - 11 e	6,000	7" (178 mm) Sanding/ Polishing Disc	Aluminum	3.1 lb 1.41 kg	8.5 in 216 mm	3.9 in	1/4 in
12L2750-80	5/8" - 11 e	6,000	7" (178 mm) Sanding/ Polishing Disc	Composite	3.4 lb 1.54 kg	9.8 in 249 mm	3.9 in	1/4 in

All tools performance rated @ 90 psi / 620 kPa air pressure.
Minimum Hose I.D.: 5/16 in / 7.9 mm
Standard Equipment: Applicable collet, collet wrenches

DOTCO® 12-42 Series

3,400 RPM 1.7 hp (1.27 kW)

- High output motor for the most demanding applications
- Comfortable and ergonomic composite handle
- Includes auxiliary handle for optimum operator control



Cat. No.	Termination	Free Speed (rpm)	Abrasive Capacity	Type Housing	Weight	Length	Head Height	Air Inlet Size
12L4202-80	5/8" - 11 e	2,500	4" (100 mm) Wire Brush, 8" (200 mm) Buffing Wheel	Composite	6.4 lb 2.90 kg	13.6 in 345 mm	3.9 in	1/2 in
12L4203-80	5/8" - 11 e	3,400	4" (100 mm) Wire Brush, 8" (200 mm) Buffing Wheel	Composite	6.4 lb 2.90 kg	13.6 in 345 mm	3.9 in	1/2 in
12L4206-80	5/8" - 11 e	6,000	9" (225 mm) Sanding Disc	Composite	6.4 lb 2.90 kg	13.6 in 345 mm	3.9 in	1/2 in
12L4207-80	5/8" - 11 e	7,200	7" (175 mm) Sanding Disc	Composite	6.4 lb 2.90 kg	13.6 in 345 mm	3.9 in	1/2 in

All tools performance rated @ 90 psi / 620 kPa air pressure.
Minimum Hose I.D.: 1/2 in / 12.7 mm
Standard Equipment: Nut, washer, spacer and wrenches

Belt Sander Attachments

Dotco 12-12 and 12-13 series.

300 Series Collet	1/4"-28 Internal Thread	Sanding Belt Size		Sanding Area	
-36 Termination	-32 Termination	in.	mm	in.	mm

Non-Woven Attachments (used with 12,000 rpm 12-12 series)

14-1715	-	1/2" x 18"	13 x 457	1/2" x 6"	13 x 152
---------	---	------------	----------	-----------	----------

Coated Abrasive Attachments (used with 12,000 rpm 12-12 series; 20,000 rpm 12-12 & 12-13 series)

14-1639	14-1638	1/4" x 12"	6.4 x 305	1/4" x 4"	6.4 x 102
14-1316	14-1301	1/2" x 12"	13 x 305	1/2" x 4"	13 x 102
14-1473	14-1463	1" x 12"	25 x 305	1" x 4"	25 x 102
14-1319	14-1318	1/2" x 24"	13 x 610	1/2" x 10"	13 x 254
14-1613	14-1603	1" x 24"	25 x 610	1" x 10"	25 x 254



Sanding Belts – Aluminum Oxide, Resin Bond

For use with Dotco belt sanders. Minimum order: 10 of any one belt.

Grit Size	Belt Number							
	1/4" x 12	1/2" x 12	1" x 12	1/2" x 24	1" x 24	1/4" x 18	1/2" x 18	3/4" x 18
40		14-1344						
50		14-1345						
60	14-1590	14-1346	14-1582	14-1366	14-1642	14-2320	14-2316	14-2326
80	14-1591	14-1348	14-1583	14-1368		14-2321	14-2317	14-2323
100		14-1350						
120	14-1593	14-1352	14-1585	14-1372		14-2322	14-2318	
150		14-1355						
180	14-1596	14-1358	14-1588	14-1378	14-1648			
240		14-1360						
320		14-1362						

Sanding Belts – Non-woven

Minimum order: 10 of any one belt.

Grit Size	Part Number	
	1/4" x 18	3/4" x 18
Extra Fine	14-1728	
Fine	14-1729	
Medium	14-1730	14-2327
Coarse	14-1731	



Spiralcool™ Backing Pads

For Dotco sanders with 5/8"-11 threaded spindles. Pad contour develops draft action to cool disc and avoid excessive pick-up.

Flexibility	Part Number – Pad Diameter (Max. rated RPM)				
	4" 12,000 rpm	4 1/2" 11,000 rpm	5" 10,000 rpm	7" 7,000 rpm	9" 6,000 rpm
Flexible	14-2197	14-2255	14-2115	14-2529	14-2202
Medium	14-2198	14-2256	14-2116	14-2200	14-2203
Rigid	14-2199	14-2257	14-2117	14-2201	

Save-A-Disc Pads

For Dotco sanders with 5/8"-11 threaded spindles. Ribs on the backing plate cause a flexing action which throws off accumulation.



Diameter	Part Number				
	Max. rpm	Assembly	Pad Only	Plate Only	Nut Only
5"	7,500	14-2515	14-2521	14-2522	14-2525
7"	7,500	14-2517	14-2521	14-2523	14-2525
9"	7,500	14-2519	14-2521		14-2525

PSA Disc Holders

Collet Chuck:

Chuck the PSA disc holder shank directly into the appropriate collet (1/8" or 1/4").



Threaded Spindle:

Remove the threaded shank from the PSA disc holder. Referring to the spindle adapter chart, select the correct spindle and thread it into the PSA holder.

Part Number	Disc Holder Diameter	Shank Assembly	PSA Disc Holder Thread
14-1146	1/2"	1/8"	5-40 Female
14-1105	1/2"	1/4"	5-40 Female
14-1147	3/4"	1/8"	5-40 Female
14-1107	3/4"	1/4"	5-40 Female
14-1170	1"	1/8"	5-40 Female
14-1110	1"	1/4"	5-40 Female
14-1111	1-1/2"	1/4"	1/4"-20 Female
14-1112	2"	1/4"	1/4"-20 Female
14-1113	3"	1/4"	1/4"-20 Female
14-1114	4"	1/4"	1/4"-20 Female

Sanding Pad Nut

For use with Dotco sanders with 5/8"-11 threaded spindles.



Part Number	Tool Series
14-2118	5/8"-11 threaded spindle

Spanner Wrench

For use with 14-2118 Sanding Nut Pad.



Part Number	Tool Series
14-2319	5/8"-11 threaded spindle

Sanding Disc Cutter

An adjustment scale allows a 9" maximum diameter sanding disc to be cut down to 3" or 4" diameter. The double bevel cutting edge assures a round cut without a loose edge or raveling.



Part Number	Description
14-2535	Disc Cutter

Replacement Blades

14-2590	Upper
14-2591	Lower

Mini Chucks

For use with Dotco 12-12 series.

To adapt right angle threaded spindle sanders for drilling, disc sanding with PSA holders, and light grinding.



Shank Size	Part Number	
	Assembly	Collet
1/8"	14-1102*	14-0158**
1/4"	14-1104*	14-0168***
6 mm	14-1094	14-0170***

* NOTE: For 1/4"-28 internal thread

** NOTE: For 5/16"-24 internal thread – 1/8" collet

*** NOTE: For 3/8"-24 internal thread – 1/4" collet

Spindle Adapters

For use with PSA Disc holders.



Part Number	Adapter Description		
	Thread (for Tool Spindle)	Thread (for PSA Disc Holder)	Max. Disc Dia.
14-1142	1/4"-28 Male	5 -40 Male	1"
14-1144	1/4"-28 Male	1/4"-20 Male	4"
14-2903	5/8"-11 Male	5/16"-24 Male	4"
14-1212	5/8"-11 Male	1/4"-20 Male	4"
14-1211	5/8"-11 Female	3/8"-24 Male	4"

DRILLS

Dotco® drills are used daily in applications ranging from aerospace to oil fields and refineries. Three styles are available - pistol grip, inline, and right angle models. Drills in this section range from 0.3–1.5 hp. Plus, dead handles are available for several models.

Parts Interchangeability

Maintenance of tools can be time consuming and expensive. That is why our products have been designed with high parts interchangeability. With fewer parts required to repair our tools, less inventory of parts is required and tools are easier to repair.

Precision Parts

It's simple, precision parts let operators manufacture precision products. Whether it is a spindle, a chuck, a motor or an angle head, our parts are manufactured from the finest materials available and are machined to the highest tolerances. It is understandable why we are proud of the .0005" runout on our collet model tools.

Ultimate Ergonomics

The Dotco drill has long been the industry workhorse for the high-volume, high-repetition, high-precision demands of today's assembly line. Dotco drills are the ergonomic solution to deliver comfort and productivity, while assuring decreased operator fatigue, potential for injury and downtime on the line.



Design features double ball bearings for the spindle, pre-loaded for longer bearing life and more accurate spindle control. Vibration and runout are reduced.

Gears are machined from alloy steel and heat-treated, with fixed cages to control centers for smooth operation.

Time-proven motor and gear design is well-balanced to reduce vibration and extend tool life.

Each tool is individually checked, aligned and adjusted on our assembly line for minimum chuck runout. Vibration is minimized.

Ergonomically critical finger and thumb guides fit the hand and aid in control.

The trigger is practically forceless requiring only 4 ounces of pressure to engage.

Full feathering is accomplished with our pressurized tip-valve design for speed control while drilling.

Housing is made of durable lightweight industrial grade aluminum.

Finger lip under the trigger keeps other fingers from interfering with the trigger action.

Rubber grip acts as a thermal protector and isolates vibration for improved operator comfort.

Handles are shaped to fit the human hand. They are flat where they need to be flat and round where they need to be round ensuring less slippage.

Minimal noise levels enhance operator comfort.

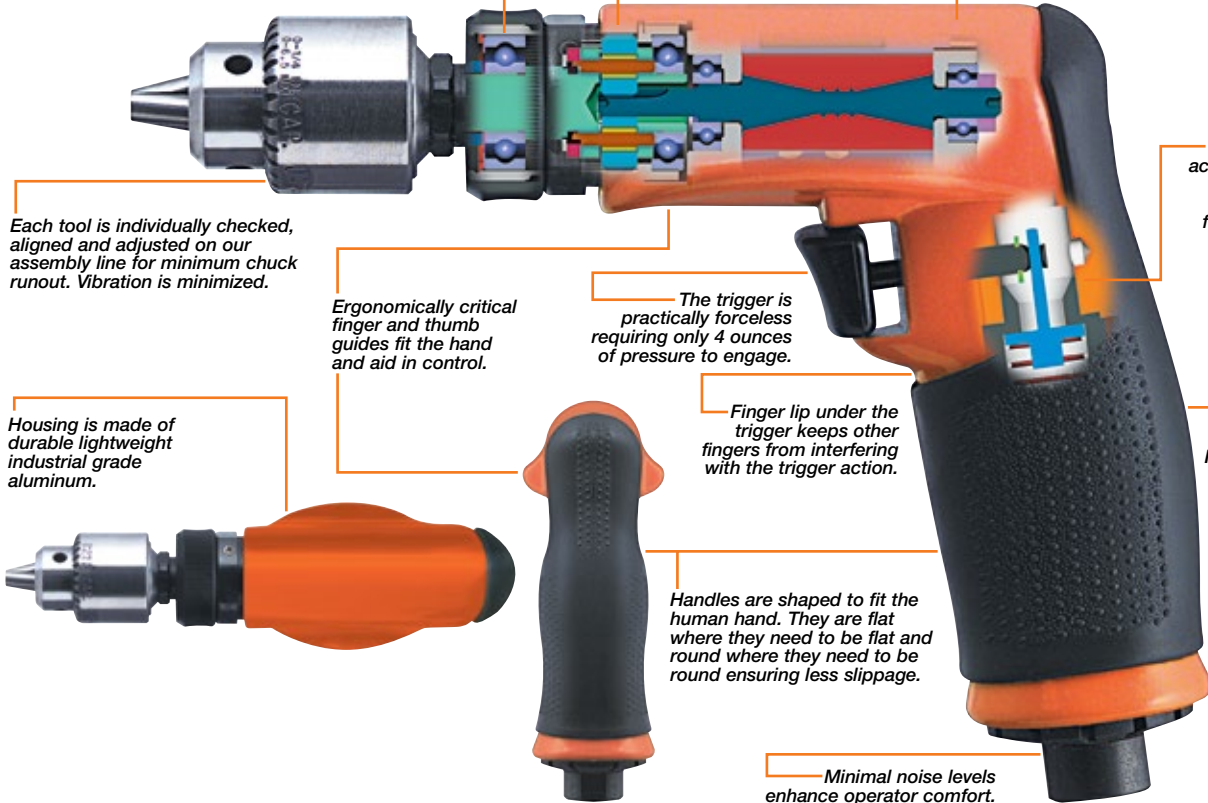

Pistol Grip Drills
Page 54



Inline Drills
Page 57



Right Angle Drills
Page 58



DOTCO® 14CF Series - Non-Reversible

600 - 29,000 RPM 0.4 hp (0.30 kW)

- Equipped with Jacobs® geared chuck and chuck key
- Non-reversible
- Composite housing with ergonomic finger and thumb guides to aid control
- Excellent for aerospace, metal fabrication, and wood working application



Termination			Free Speed (rpm)	Weight	Length	Air Inlet Size
1/4" Chuck	3/8" Chuck	3/8"-24 e				
Cat. No.	Cat. No.	Cat. No.				
14CFS97-38	14CFS97-51	14CFS97-40	600	1.8 lb 0.82 kg	6.9 in 175 mm	1/4 in
14CFS96-38	14CFS96-51	14CFS96-40	700	1.8 lb 0.82 kg	6.9 in 175 mm	1/4 in
14CFS95-38	14CFS95-51	14CFS95-40	1,000	1.8 lb 0.82 kg	6.9 in 175 mm	1/4 in
14CFS94-38	14CFS94-51	14CFS94-40	2,400	1.6 lb 0.73 kg	5.7 in 145 mm	1/4 in
14CFS93-38	14CFS93-51	14CFS93-40	3,200	1.5 lb 0.68 kg	5.7 in 145 mm	1/4 in
14CFS92-38	14CFS92-51	14CFS92-40	3,800	1.5 lb 0.68 kg	5.7 in 145 mm	1/4 in
14CFS91-38	14CFS91-51	14CFS91-40	5,200	1.5 lb 0.68 kg	5.7 in 145 mm	1/4 in
14CFS90-38	14CFS90-51	14CFS90-40	29,000	1.5 lb 0.68 kg	5.7 in 145 mm	1/4 in

All tools performance rated @ 90 psi / 620 kPa air pressure.
 Minimum Hose I.D.: 5/16 in / 7.9 mm
 Drill Diameter Capacity Matches Chuck Size

PISTOL GRIP DRILLS

DOTCO® 14CS Series - Non reversible

500 - 20,000 RPM 0.9 hp (0.67 kW)

- Equipped with Jacobs® geared chuck and chuck key
- Ergonomically critical finger and thumb guides fir the hand to aid control
- Excellent for aerospace, metal fabrication, and wood working application
- 1/2" models equipped with dead handle



Termination			Free Speed (rpm)	Weight	Length	Air Inlet Size
3/8" Chuck	3/8" - 24 e	1/4" Chuck				
Cat. No.	Cat. No.	Cat. No.				
14CSL97-51	14CSL97-40	—	500	2.9 lb 1.32 kg	8.1 in 206 mm	1/4 in
14CSL95-51	14CSL95-40	—	1,300	2.9 lb 1.32 kg	8.1 in 206 mm	1/4 in
—	14CSL92-40	14CSL92-38	3,200	2.1 lb 0.95 kg	6.3 in 160 mm	1/4 in
—	14CSL91-40	14CSL91-38	5,200	2.1 lb 0.95 kg	6.3 in 160 mm	1/4 in
—	14CSL98-40	14CSL98-38	6,000	2.1 lb 0.95 kg	6.3 in 160 mm	1/4 in
—	14CSL90-40	14CSL90-38	20,000	2.1 lb 0.95 kg	6.3 in 160 mm	1/4 in

All tools performance rated @ 90 psi / 620 kPa air pressure.
 Minimum Hose I.D.: 5/16 in / 7.9 mm
 Standard equipment: Jacobs geared chuck, chuck key
 Drill diameter capacity matches chuck size.

DOTCO® 14CNL Series - Non-Reversible

500 - 20,000 RPM 0.9 hp (0.67 kW)



- Equipped with Jacobs® geared chuck and chuck key
- Ergonomically critical finger and thumb guides for the hand to aid control
- Excellent for aerospace, metal fabrication, and wood working application
- 1/2" models equipped with dead handle

Termination				Free Speed (rpm)	Weight	Length	Air Inlet Size
3/8" Chuck	3/8" - 24 e	1/2" Chuck	1/4" Chuck				
Cat. No.	Cat. No.	Cat. No.	Cat. No.				
14CNL97-51	14CNL97-40	14CNL97-53	—	500	3.5 lb 1.59 kg	9.1 in 231 mm	1/4 in
14CNL95-51	14CNL95-40	—	—	1,300	2.8 lb 1.27 kg	8.6 in 218 mm	1/4 in
14CNL92-51	14CNL92-40	14CNL92-53	14CNL92-38	3,200	2.4 lb 1.09 kg	7.2 in 183 mm	1/4 in
14CNL91-51	14CNL91-40	—	—	5,200	2.4 lb 1.09 kg	7.2 in 183 mm	1/4 in
14CNL98-51	14CNL98-40	14CNL98-53	14CNL98-38	6,000	2.2 lb 1.00 kg	6.8 in 173 mm	1/4 in
—	14CNL90-40	—	14CNL90-38	20,000	2.2 lb 1.00 kg	6.8 in 173 mm	1/4 in

All tools performance rated @ 90 psi / 620 kPa air pressure.
 Minimum Hose I.D.: 5/16 in / 7.9 mm
 Standard equipment: Jacobs geared chuck, chuck key
 Drill diameter capacity matches chuck size.

DOTCO® 14CHL Series - Non-Reversible

3,200 – 6,000 RPM 1.4 hp (1.04 kW)



- Available with Jacobs® chuck
- Powerful motor
- Rear exhaust

Cat. No.	Termination	Free Speed (rpm)	Weight	Length	Air Inlet Size
14CHL92-38	1/4" Chuck	3,200	2.6 lb 1.18 kg	6.5 in 165 mm	1/4 in
14CHL92-40	3/8" - 24 e	3,200	2.4 lb 1.09 kg	5.5 in 140 mm	1/4 in
14CHL92-51	3/8" Chuck	3,200	2.8 lb 1.27 kg	7.1 in 180 mm	1/4 in
14CHL92-53	1/2" Chuck	3,200	3.8 lb 1.72 kg	7.4 in 188 mm	1/4 in
14CHL98-38	1/4" Chuck	6,000	2.6 lb 1.18 kg	6.5 in 165 mm	1/4 in
14CHL98-40	3/8" - 24 e	6,000	2.4 lb 1.09 kg	5.5 in 140 mm	1/4 in
14CHL98-51	3/8" Chuck	6,000	2.8 lb 1.27 kg	7.1 in 180 mm	1/4 in
14CHL98-53	1/2" Chuck	6,000	3.8 lb 1.72 kg	7.4 in 188 mm	1/4 in

All tools performance rated @ 90 psi / 620 kPa air pressure.
 Drill Diameter Capacity Matches Chuck Size
 Minimum hose ID: 5/16 in / 7.9 mm

Cleco® 15DP Series - Non-Reversible

160 – 1,400 RPM 1.0 hp (0.75 kW)

- Excellent for slow speed application
- Powerful motor



Cat. No.	Termination	Free Speed (rpm)	Type Housing	Weight	Length	Air Inlet Size
15DP-1.6B-53	1/2" Chuck	160	Aluminum	6.0 lb 2.72 kg	9.8 in 249 mm	3/8 in
15DP-4B-53	1/2" Chuck	400	Aluminum	5.5 lb 2.49 kg	8.5 in 216 mm	3/8 in
15DP-8B-53	1/2" Chuck	800	Aluminum	5.5 lb 2.49 kg	8.5 in 216 mm	3/8 in
15DP-14B-49	3/8" Chuck	1,400	Aluminum	4.5 lb 2.04 kg	8.3 in 211 mm	3/8 in

All tools performance rated @ 90 psi / 620 kPa air pressure.

Standard Equipment: Operating instructions and service manual Dead handles on all models except 15DP-14B 3-Jaw Chuck and Key

General: Air Inlet: 3/8" NPTF, Minimum Hose Size: 3/8", Spindle Thread: 1/2"-20, Spindle Offset: Pistol Grip: 31/32"

Drill Diameter Capacity Matches Chuck Size

Minimum hose ID: 5/16 in / 7.9 mm

Cleco® 135DPV Series - Variable Speed

600 – 2,600 RPM 0.7 hp (0.5 kW)

- Variable speed
- Calibrated governed speed control



Cat. No.	Termination	Free Speed (rpm)	Type Housing	Weight	Length	Air Inlet Size
135DPV-7B-43	1/2" Chuck	600	Aluminum	3.6 lb 1.63 kg	9.6 in 244 mm	1/4 in
135DPV-7B-50	1/2" Chuck	600	Aluminum	3.6 lb 1.63 kg	9.6 in 244 mm	1/4 in
135DPV-14B-50	1/2" Chuck	1,250	Aluminum	3.4 lb 1.54 kg	9.3 in 236 mm	1/4 in
135DPV-14B-51	3/8" Chuck	1,250	Aluminum	3.4 lb 1.54 kg	9.3 in 236 mm	1/4 in
135DPV-28B-51	3/8" Chuck	2,600	Aluminum	3.2 lb 1.45 kg	8.5 in 216 mm	1/4 in

All tools performance rated @ 90 psi / 620 kPa air pressure.

Standard Equipment: Operating instructions, service manual, 3-Jaw Chuck and Key-Jaw Chuck and Key

General: Air Inlet: 1/4 in NPT, Minimum Hose Size: 1/4 in / 6 mm, Spindle Offset: 25/32 in / 20 mm

Drill Diameter Capacity Matches Chuck Size

DOTCO® 15LF Series - Inline

600 - 5,300 RPM 0.4 hp (0.30 kW)

- Equipped with Jacobs brand chuck
- Rear Exhaust
- Safety lever



Exhaust		Termination	Free Speed (rpm)	Type Housing	Weight	Length	Air Inlet Size
Rear	Front						
Cat. No.	Cat. No.						
15LF087-38	—	1/4" Chuck	600	Composite	1.9 lb 0.86 kg	8.6 in 218 mm	1/4 in
15LF087-40	—	3/8" - 24 e	600	Composite	1.9 lb 0.86 kg	8.6 in 218 mm	1/4 in
15LF086-38	—	1/4" Chuck	750	Composite	1.4 lb 0.64 kg	8.0 in 203 mm	1/4 in
—	15LF055-38	1/4" Chuck	1,000	Composite	1.9 lb 0.86 kg	8.6 in 218 mm	1/4 in
15LF085-38	—	1/4" Chuck	1,000	Composite	1.4 lb 0.64 kg	8.0 in 203 mm	1/4 in
15LF085-40	—	3/8" - 24 e	1,000	Composite	1.4 lb 0.64 kg	8.0 in 203 mm	1/4 in
—	15LF054-38	1/4" Chuck	2,400	Composite	1.3 lb 0.59 kg	7.3 in 185 mm	1/4 in
15LF084-38	—	1/4" Chuck	2,400	Composite	1.4 lb 0.64 kg	8.0 in 203 mm	1/4 in
—	15LF053-38	1/4" Chuck	3,300	Composite	1.3 lb 0.59 kg	7.3 in 185 mm	1/4 in
15LF083-38	—	1/4" Chuck	3,300	Composite	1.4 lb 0.64 kg	8.0 in 203 mm	1/4 in
15LF083-40	—	3/8" - 24 e	3,300	Composite	1.4 lb 0.64 kg	8.0 in 203 mm	1/4 in
—	15LF052-38	1/4" Chuck	4,000	Composite	1.3 lb 0.59 kg	7.3 in 185 mm	1/4 in
15LF082-38	—	1/4" Chuck	4,000	Composite	1.4 lb 0.64 kg	8.0 in 203 mm	1/4 in
15LF082-40	—	3/8" - 24 e	4,000	Composite	1.4 lb 0.64 kg	7.3 in 185 mm	1/4 in
—	15LF051-38	1/4" Chuck	5,300	Composite	1.3 lb 0.59 kg	7.3 in 185 mm	1/4 in
15LF081-38	—	1/4" Chuck	5,300	Composite	1.4 lb 0.64 kg	8.0 in 203 mm	1/4 in
15LF081-40	—	3/8" - 24 e	5,300	Composite	1.4 lb 0.64 kg	8.0 in 203 mm	1/4 in
15LF080-38	—	1/4" Chuck	28,500	Composite	0.9 lb 0.41 kg	6.3 in 160 mm	1/4 in

All tools performance rated @ 90 psi / 620 kPa air pressure.

Minimum Hose I.D.: 1/4 in / 6.4 mm

Standard Equipment: Jacobs geared chuck, chuck key

Drill diameter capacity matches chuck size.

DOTCO® 15-14 Series - Right Angle

2,400 - 3,600 RPM 0.3 hp (0.22 kW)

- Equipped with Jacobs® chuck
- Rear Exhaust
- Safety Lever



Cat. No.	Termination	Free Speed (rpm)V	Type Housing	Weight	Length	Head Height	Air Inlet Size	Drill Diameter Capacity
15L1487-32	1/4" - 28 i	1,500	Composite	1.2 lb 0.54 kg	8.0 in 203 mm	3.0 in	1/4 in	1/4 in
15L1487-36	1/4" Collet	1,500	Composite	1.2 lb 0.54 kg	8.0 in 203 mm	3.0 in	1/4 in	1/4 in
15L1487-38	1/4" Chuck	1,500	Composite	1.5 lb 0.68 kg	8.0 in 203 mm	3.0 in	1/4 in	1/4 in
15L1488-36	1/4" Collet	2,400	Composite	1.6 lb 0.73 kg	8.7 in 221 mm	3.0 in	1/4 in	1/4 in
15L1488-38	1/4" Chuck	2,400	Composite	1.5 lb 0.68 kg	8.0 in 203 mm	3.0 in	1/4 in	1/4 in
15L1489-32	1/4" - 28 i	3,600	Composite	1.6 lb 0.73 kg	8.7 in 221 mm	3.0 in	1/4 in	1/4 in
15L1489-36	1/4" Collet	3,600	Composite	1.6 lb 0.73 kg	8.7 in 221 mm	3.0 in	1/4 in	1/4 in
15L1489-38	1/4" Chuck	3,600	Composite	1.5 lb 0.68 kg	8.0 in 203 mm	3.0 in	1/4 in	1/4 in
15L1489-51	3/8" Chuck	3,600	Composite	1.5 lb 0.68 kg	8.0 in 203 mm	3.0 in	1/4 in	1/4 in
15L1470-37	5/32" Chuck	12,000	Composite	1.2 lb 0.54 kg	6.9 in 175 mm	2.5 in	1/4 in	1/4 in
15L1401-37	5/32" Chuck	20,000	Composite	1.0 lb 0.45 kg	6.2 in 157 mm	2.5 in	1/4 in	1/4 in
15L1471-37	5/32" Chuck	20,000	Composite	1.2 lb 0.54 kg	6.9 in 175 mm	2.5 in	1/4 in	1/4 in

All tools performance rated @ 90 psi / 620 kPa air pressure.
 Minimum Hose I.D.: 1/4 in / 6.4 mm
 Standard Equipment: Jacobs geared chuck, chuck key
 Drill Diameter Capacity Matches Chuck Size

RIGHT ANGLE DRILLS

DOTCO® 15LF Series - Light Duty Head

600 - 5,300 RPM 0.4 hp (0.30 kW)

- Wide array of speeds, head designs, and spindle threads for all applications
- High efficiency motor and gear train
- Comfortable and ergonomic handle



Cat. No.	Termination	Free Speed (rpm)	Type Housing	Weight	Length	Air Inlet Size
15LF287-62	1/4" - 28 i	600	Composite	1.9 lb 0.86 kg	11.8 in 300 mm	1/4 in
15LF286-62	1/4" - 28 i	750	Composite	1.9 lb 0.86 kg	11.8 in 300 mm	1/4 in
15LF285-62	1/4" - 28 i	1,000	Composite	1.9 lb 0.86 kg	11.8 in 300 mm	1/4 in
15LF284-62	1/4" - 28 i	2,400	Composite	1.8 lb 0.82 kg	11.1 in 282 mm	1/4 in
15LF283-62	1/4" - 28 i	3,300	Composite	1.6 lb 0.73 kg	10.7 in 272 mm	1/4 in
15LF282-62	1/4" - 28 i	4,000	Composite	1.6 lb 0.73 kg	10.7 in 272 mm	1/4 in
15LF281-62	1/4" - 28 i	5,300	Composite	1.6 lb 0.73 kg	10.7 in 272 mm	1/4 in

All tools performance rated @ 90 psi / 620 kPa air pressure.
 Standard Equipment: 600 Series Mini Angle Head with 1/4"-28 internal thread

DOTCO® 15LS Series - Light Duty Head

500 - 5,430 RPM 0.6 hp (0.45 kW)

- Wide array of speeds, head designs, and spindle threads for all applications
- High efficiency motor and gear train
- Comfortable and ergonomic handle



Cat. No.	Termination	Free Speed (rpm)	Type Housing	Weight	Length	Air Inlet Size
15LS287-62	1/4" - 28 i	500	Composite	1.9 lb 0.86 kg	12.7 in 323 mm	1/4 in
15LS286-62	1/4" - 28 i	840	Composite	1.9 lb 0.86 kg	12.7 in 323 mm	1/4 in
15LS285-62	1/4" - 28 i	1,360	Composite	1.9 lb 0.86 kg	12.7 in 323 mm	1/4 in
15LS284-62	1/4" - 28 i	1,660	Composite	1.9 lb 0.86 kg	12.4 in 315 mm	1/4 in
15LS283-62	1/4" - 28 i	2,010	Composite	2.3 lb 1.04 kg	11.5 in 292 mm	1/4 in
15LS282-62	1/4" - 28 i	3,370	Composite	2.3 lb 1.04 kg	11.5 in 292 mm	1/4 in
15LS281-62	1/4" - 28 i	5,430	Composite	2.3 lb 1.04 kg	11.5 in 292 mm	1/4 in

All tools performance rated @ 90 psi / 620 kPa air pressure.
Standard Equipment: 600 Series Mini Angle Head with 1/4"-28 internal thread

DOTCO® 15LN Series - Light Duty Head

540 - 5,600 RPM 0.9 hp (0.67 kW)

- Wide array of speeds, head designs, and spindle threads for all applications
- High efficiency motor and gear train
- Comfortable and ergonomic handle



Cat. No.	Termination	Free Speed (rpm)	Type Housing	Weight	Length	Head Height	Air Inlet Size
15LN287-62	1/4" - 28 i	320	Composite	2.5 lb 1.13 kg	12.0 in 305 mm	1.0 in	1/4 in
15LN286-62	1/4" - 28 i	540	Composite	2.5 lb 1.13 kg	13.5 in 343 mm	1.0 in	1/4 in
15LN285-62	1/4" - 28 i	1,000	Composite	2.5 lb 1.13 kg	12.0 in 305 mm	1.0 in	1/4 in
15LN284-62	1/4" - 28 i	1,530	Composite	2.5 lb 1.13 kg	12.0 in 305 mm	1.0 in	1/4 in
15LN283-62	1/4" - 28 i	1,850	Composite	2.5 lb 1.13 kg	12.0 in 305 mm	1.0 in	1/4 in
15LN282-62	1/4" - 28 i	3,100	Composite	2.5 lb 1.13 kg	12.0 in 305 mm	1.0 in	1/4 in
15LN281-62	1/4" - 28 i	5,000	Composite	2.5 lb 1.13 kg	12.0 in 305 mm	1.0 in	1/4 in
15LN288-62	1/4" - 28 i	5,600	Composite	2.5 lb 1.13 kg	12.0 in 305 mm	1.0 in	1/4 in

All tools performance rated @ 90 psi / 620 kPa air pressure.
Standard Equipment: 600 Series Mini Angle Head with 1/4"-28 internal thread

DOTCO® 15LF Series - Heavy Duty Head

420 - 3,700 RPM 0.4 hp (0.30 kW)

- Wide array of speeds, head designs, and spindle threads for all applications
- Reinforced angle head for added durability
- Comfortable and ergonomic handle



Cat. No.	Termination	Free Speed (rpm)	Type Housing	Weight	Length	Air Inlet Size
15LF287-52	1/4" - 28 i	420	Composite	2.0 lb 0.91 kg	12.0 in 305 mm	1/4 in
15LF286-52	1/4" - 28 i	525	Composite	2.0 lb 0.91 kg	12.0 in 305 mm	1/4 in
15LF285-52	1/4" - 28 i	700	Composite	2.0 lb 0.91 kg	12.0 in 305 mm	1/4 in
15LF284-52	1/4" - 28 i	1,700	Composite	1.8 lb 0.82 kg	10.6 in 269 mm	1/4 in
15LF283-52	1/4" - 28 i	2,300	Composite	1.7 lb 0.77 kg	11.0 in 279 mm	1/4 in
15LF282-52	1/4" - 28 i	2,800	Composite	1.7 lb 0.77 kg	11.0 in 279 mm	1/4 in
15LF281-52	1/4" - 28 i	3,700	Composite	1.7 lb 0.77 kg	11.0 in 279 mm	1/4 in

All tools performance rated @ 90 psi / 620 kPa air pressure.
Standard Equipment: 500 Series Heavy Duty Angle Head with 1/4"-28

DOTCO® 15LS Series - Heavy Duty Head

350 - 3,800 RPM 0.6 hp (0.45 kW)

- Wide array of speeds, head designs, and spindle threads for all applications
- Reinforced angle head for added durability
- Comfortable and ergonomic handle



Cat. No.	Termination	Free Speed (rpm)	Type Housing	Weight	Length	Air Inlet Size
15LS287-52	1/4" - 28 i	350	Composite	2.8 lb 1.27 kg	12.3 in 312 mm	1/4 in
15LS286-52	1/4" - 28 i	590	Composite	2.8 lb 1.27 kg	12.3 in 312 mm	1/4 in
15LS285-52	1/4" - 28 i	950	Composite	2.8 lb 1.27 kg	12.3 in 312 mm	1/4 in
15LS283-52	1/4" - 28 i	1,410	Composite	2.4 lb 1.09 kg	11.0 in 279 mm	1/4 in
15LS282-52	1/4" - 28 i	2,360	Composite	2.4 lb 1.09 kg	11.0 in 279 mm	1/4 in
15LS281-52	1/4" - 28 i	3,800	Composite	2.4 lb 1.09 kg	11.0 in 279 mm	1/4 in

All tools performance rated @ 90 psi / 620 kPa air pressure.
Standard Equipment: 500 Series Heavy Duty Angle Head with 1/4"-28

DOTCO® 15LN Series - Heavy Duty Head

320 - 3,900 RPM 0.9 hp (0.67 kW)

- Wide array of speeds, head designs, and spindle threads for all applications
- Reinforced angle head for added durability
- Comfortable and ergonomic handle



Cat. No.	Termination	Free Speed (rpm)	Type Housing	Weight	Length	Air Inlet Size
15LN286-52	1/4" - 28 i	540	Composite	3.0 lb 1.36 kg	12.8 in 325 mm	1/4 in
15LN285-52	1/4" - 28 i	870	Composite	3.0 lb 1.36 kg	12.8 in 325 mm	1/4 in
15LN284-52	1/4" - 28 i	1,070	Composite	3.0 lb 1.36 kg	12.8 in 325 mm	1/4 in
15LN283-52	1/4" - 28 i	1,300	Composite	2.6 lb 1.18 kg	11.5 in 292 mm	1/4 in
15LN281-52	1/4" - 28 i	3,500	Composite	2.6 lb 1.18 kg	11.5 in 292 mm	1/4 in
15LN288-52	1/4" - 28 i	3,900	Composite	2.6 lb 1.18 kg	11.5 in 292 mm	1/4 in

All tools performance rated @ 90 psi / 620 kPa air pressure.
Standard Equipment: 500 Series Heavy Duty Angle Head with 1/4"-28

Termination	Spindle Thread
600 Series Mini Angle Head	
-61	#10-32 Internal
-62	1/4"-28 Internal
-63	9/32"-40 Internal
-64	5/16"-24 Internal



Termination	Spindle Thread
700 Series Compact Angle Head	
-72	1/4"-28 Internal
-73	9/32"-40 Internal
-74	5/16"-24 Internal



Termination	Spindle Thread
360 Degree Mini Angle Head	
-91	#10-32 Internal
-92	1/4"-28 Internal

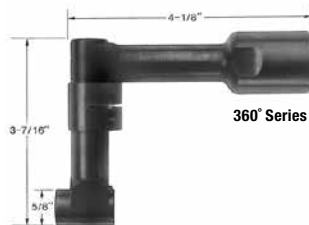

Termination	Spindle Thread
45 Degree Mini Angle Head	
-42	1/4"-28 Internal
-43	9/32"-40 Internal
-44	5/16"-24 Internal



Termination	Spindle Thread
500 Series Heavy Duty Angle Head	
-52	1/4"-28 Internal
-53	9/32"-40 Internal
-54	5/16"-24 Internal
-55	3/8"-24 Internal
-59	1/4" Cap. 3 jaw chuck
-59NC	3/8"-24 Male Thread



Mini Chucks

For use with DOTCO 12-12 series. To adapt right angle threaded spindle sanders for drilling, disc sanding with PSA holders, and light grinding.

Shank Size	Assembly	Collet
1/8"	14-1102*	14-0158**
1/4"	14-1104*	14-0168***
6 mm	14-1094	14-0170***

* NOTE: For 1/4"-28 internal thread

** NOTE: For 5/16"-24 internal thread – 1/8" collet

*** NOTE: For 3/8"-24 internal thread – 1/4" collet



14-1104

Quick-Change Chuck

Thread Size	Capacity	Part Number
3/8"-24	1/4" Hex	QRA-08



Collet Chuck (1/4"-28 Male Thread)

Drill Size	Part Number
3/16"	863810
1/4"	863806



863810

Cone Jaw Chuck

Part No.	Description
1020699	1/4" capacity with a 1/4"-28 male thread



Quick Change Pressure Foot Adapter

For use on 1"-20 external thread tools.

Part Number	Diameter "A"
1110167	1.626/1.623

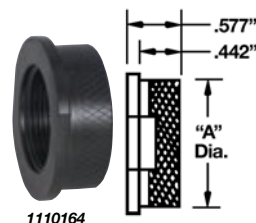

1110164

Jacobs® Chucks

Part No.	Thread Size	Capacity	Description	Term.
1005078	3/8"-24	1/4"	1 BA	-38
1001505	3/8"-24	1/4" HD	7 BA	-42
1001252	3/8"-24	3/8"	41 BA (med.duty)	-51
1009726	3/8"-24	1/2"	33 BA	-53
1075	5/16"-24	5/32"	*OB	37



1001252

Dead Handle

Drill Model	Part Number
15	881580



881580

300 Series Collet Chuck

Use with Standard Collet: 1/4" (#308). Termination Number: -36

Part Number	Description
14-1148	1/64"-1/4" capacity with a 5/16"-24 female thread



Collets

For use on Dotco 15LF, 15LS & 15LN right angle drills with 9/32"-40 spindles. (Termination codes: - 43, -53, -63, -73, & -93)



1005184

Part Number	Drill		
	Size	Dec.	mm
1005180	1/16	.0625	1.6
1005182	3/32	.0937	2.4
1005183	7/64	.1094	2.8
1005184	1/8	.125	3.2
1005185	9/64	.1406	3.6
1005186	5/32	.1562	4.0
1005187	11/64	.1719	4.4
1005188	3/16	.1875	4.8
1006408	53	.0595	1.5
1006412	51	.067	1.7
1005875	46	.081	2.1
1005684	40	.098	2.5
1006395	39	.0995	2.5

Part Number	Drill		
	Size	Dec.	mm
1005873	31	.120	3.0
1013904	30	.1285	3.3
1005872	27	.144	3.7
1005926	22	.157	4.0
1005682	21	.159	4.0
1005876	20	.161	4.1
1006035	19	.166	4.2
1005977	17	.173	4.4
1005927	13	.185	4.7
1005871	12	.189	4.8
1006001	11	.191	4.9
1005681	10	.1935	4.9

Optional Drill Attachments

For use on Dotco 15LF, 15LS, and 15LN series. Capacity: 1/4" Diameter Drill

These drill attachments can be ordered as a separate accessory item or as part of a complete model. To order as a complete model, use the basic model number from the appropriate 15LF, 15LS, or 15LN catalog page and replace the termination number (-32 for example) with the termination number of the desired optional attachment (-71 for example) from this page.

Part Number	Termination	Spindle Thread
Compact Angle Head – 700 Series		
1025477	-72	1/4"-28 Internal Thread
1025476	-73	9/32"-40 Internal Thread
1025668	-74	5/16"-24 Internal Thread
Light Duty Head – 600 Series		
1025314	-61	#10-32 Internal Thread
1025409	-62	1/4"-28 Internal Thread
1025313	-63	9/32"-40 Internal Thread
1025328	-64	5/16"-24 Internal Thread
Heavy Duty Angle Head – 500 Series		
1021289	-52	1/4"-28 Internal Thread
1021292	-53	9/32"-40 Internal Thread
1021291	-54	5/16"-24 Internal Thread
1025780	-55	3/8"-24 Internal Thread
45° Light Duty Angle Head		
1025730	-42	1/4"-28 Internal Thread
1025731	-43	9/32"-40 Internal Thread
1025733	-44	5/16"-24 Internal Thread
360° Light Duty Angle Head		
1025696	-91	#10-32 Internal Thread
1025694	-92	1/4"-28 Internal Thread



Part No.	Termination	Drill Chuck
Heavy Duty Angle Head		
1021620	-59	500 Series Angle Head with drill chuck, 1/4" capacity
1021620	-59 NC	500 Series Angle Head, no chuck 3/8"-24 ext. thread



ROUTERS, SAWS, PERCUSSION, SPECIALTY TOOLS

For over 60 years, Dotco has been producing tools that are precise, durable, and easy-to-service, satisfying all the demands of the world's toughest industries. We offer a full range of routers, saws, percussion, and specialty tools for all your production and maintenance needs.

Packs a Punch

Attack those hard-to-reach spots with our full line of percussion tools. Our tools are designed to pack a harder punch, outlast the competition, and reduce vibration for the operator. Whether your application is maintenance or production, look no further than our family of trusted percussion tools.





Routers
Page 66



Saws
Page 71



Specialty Tools
Page 78

Percussion Tools
Page 75



DOTCO® 12 Series - Right Angle Routers

- Available in both geared and gearless
- Multiple speed and power options available to find the right tool for the application



Cat. No.	Exhaust	Shank Diameter Capacity	Free Speed (rpm)	Drive	Weight	Length	Air Inlet Size
12L2218-36RT	Front	1/4 in	18,000	Geared 0.6 hp (0.45 kW)	1.8 lb 0.82 kg	7.5 in 191 mm	1/4 in
12L2718-36RT	Front	1/4 in	18,000	Geared 0.9 hp (0.67 kW)	1.9 lb 0.86 kg	8.0 in 203 mm	1/4 in
12L1281-36RT	Rear	1/4 in	20,000	Geared 0.3 hp (0.22 kW)	1.7 lb 0.77 kg	6.5 in 165 mm	1/4 in
12L1201-36RT	Front	1/4 in	20,000	Geared 0.3 hp (0.22 kW)	1.7 lb 0.77 kg	6.5 in 165 mm	1/4 in
12L1381-36RT	Rear	1/4 in	25,000	Gearless 0.3 hp (0.22 kW)	1.5 lb 0.68 kg	7.4 in 188 mm	1/4 in
12L1300-36RT	Front	1/4 in	30,000	Gearless 0.3 hp (0.22 kW)	1.5 lb 0.68 kg	7.4 in 188 mm	1/4 in
12L1380-36RT	Rear	1/4 in	30,000	Gearless 0.3 hp (0.22 kW)	1.5 lb 0.68 kg	7.4 in 188 mm	1/4 in

All tools performance rated @ 90 psi / 620 kPa air pressure.
Minimum Hose I.D.: 1/4 in / 6.4 mm
Standard Equipment: Collet, applicable wrenches

DOTCO® 10-10 & 12-10 Series - Inline Router

30,000 - 34,000 RPM 0.3 hp (0.22 kW)

- Tremendous power for the toughest portable routing operations
- Unique governor design assures minimum air consumption, maximum power all at correct speed and long motor life
- All models oil free



Cat. No.	Shank Diameter Capacity	Free Speed (rpm)	Type Housing	Weight	Length	Air Inlet Size
12L1000-36RT	1/4 in	30,000	Composite	1.4 lb 0.64 kg	6.7 in 170 mm	1/4 in
12L1001-36RT	1/4 in	34,000	Composite	1.4 lb 0.64 kg	6.7 in 170 mm	1/4 in

All tools performance rated @ 90 psi / 620 kPa air pressure.
Minimum Hose I.D.: 1/4 in / 6.4 mm
Standard Equipment: Collet, applicable wrenches

DOTCO® 12-20 Series - Inline Router

20,000 - 25,000 RPM 0.6 hp (0.45 kW)

- Roll valve gives easy, convenient operation
- Tremendous power for the toughest portable routing operations
- Unique governor design assures minimum air consumption, maximum power at correct speed and long motor life



Cat. No.	Exhaust	Shank Diameter Capacity	Free Speed (rpm)	Type Housing	Weight	Length	Air Inlet Size
12L2001-01RT	Front	1/4 in	20,000	Composite	1.9 lb 0.86 kg	7.5 in 191 mm	1/4 in
12L2081-01RT	Rear	1/4 in	20,000	Composite	1.9 lb 0.86 kg	7.5 in 191 mm	1/4 in
12L2000-01RT	Front	1/4 in	25,000	Composite	1.9 lb 0.86 kg	7.5 in 191 mm	1/4 in
12L2080-01RT	Rear	1/4 in	25,000	Composite	1.9 lb 0.86 kg	7.5 in 191 mm	1/4 in

All tools performance rated @ 90 psi / 620 kPa air pressure.
Minimum Hose I.D.: 5/16 in / 7.9 mm
Standard Equipment: Collet, applicable wrenches

DOTCO® 10-20 Series - Inline Router

20,000 - 25,000 RPM 0.6 hp (0.45 kW)

- Roll valve gives easy, convenient operation
- Tremendous power for the toughest portable routing operations
- Unique governor design assures minimum air consumption, maximum power at correct speed and long motor life



Cat. No.	Exhaust	Shank Diameter Capacity	Free Speed (rpm)	Type Housing	Weight	Length	Air Inlet Size
10L2000-01RT	Front	1/4 in	25,000	Aluminum	1.8 lb 0.82 kg	6.3 in 160 mm	1/4 in

All tools performance rated @ 90 psi / 620 kPa air pressure.
Minimum Hose I.D.: 5/16 in / 7.9 mm
Standard Equipment: Collet, applicable wrenches

DOTCO® 12-25 Series - Inline Router

18,000 - 23,000 RPM 0.9 hp (0.67 kW)

- Sustained power for any routing application
- Composite comfortable grip
- Roll valve for easy operation



Cat. No.	Shank Diameter Capacity	Free Speed (rpm)	Type Housing	Weight	Length	Air Inlet Size
12L2582-01RT	1/4 in	18,000	Composite	2.6 lb 1.18 kg	7.1 in 180 mm	1/4 in
12L2582-0124RT	3/8 in	18,000	Composite	2.6 lb 1.18 kg	7.1 in 180 mm	1/4 in
12L2580-0124RT	3/8 in	23,000	Composite	2.6 lb 1.18 kg	7.1 in 180 mm	1/4 in
12L2500-01RT	1/4 in	23,000	Composite	2.6 lb 1.18 kg	7.1 in 180 mm	1/4 in
12L2580-01RT	1/4 in	23,000	Composite	2.6 lb 1.18 kg	7.1 in 180 mm	1/4 in
10L2500-01RT	1/4 in	23,000	Aluminum	2.5 lb 1.13 kg	6.9 in 175 mm	1/4 in
10L2580-01RT	1/4 in	23,000	Aluminum	2.5 lb 1.13 kg	6.9 in 175 mm	1/4 in
12L2502-01RT	1/4 in	18,000	Composite	2.6 lb 1.18 kg	7.1 in 180 mm	1/4 in

All tools performance rated @ 90 psi / 620 kPa air pressure.
Minimum Hose I.D.: 5/16 in / 7.9 mm
Standard Equipment: Collet, applicable wrenches

DOTCO® 12-40 Series - Inline Router

18,000 RPM 1.7 hp (1.27 kW)

- Maximum power for larger routing application
- Tremendous power for the toughest portable routing operations
- Unique governor design assures minimum air consumption, maximum power at correct speed and long motor life
- All models oil free



Cat. No.	Shank Diameter Capacity	Free Speed (rpm)	Type Housing	Weight	Length	Air Inlet Size
10L4018-01	1/4 in	18,000	Aluminum	4.2 lb 1.91 kg	11.3 in 287 mm	1/2 in
12L4018-01	1/4 in	18,000	Composite	4.2 lb 1.91 kg	11.3 in 287 mm	1/2 in
12L4018-03	3/8 in	18,000	Composite	4.2 lb 1.91 kg	11.3 in 287 mm	1/2 in

All tools performance rated @ 90 psi / 620 kPa air pressure.
Minimum Hose I.D.: 1/2 in / 12.7 mm
Standard Equipment: Collet, applicable wrenches

DOTCO® 10-43 Series - Base Mount Router

9,000 - 18,000 RPM 1.7 hp (1.27 kW)

- Roll valve gives easy, convenient operation
- Cool running pneumatic motor - Stays cool even under heavy load
- Easy-to-use thumb throttle can be operated without releasing hand from handle
- Smooth accurate cuts - assured by precision spindle



Cat. No.	Shank Diameter Capacity	Free Speed (rpm)	Type Housing	Weight	Length	Air Inlet Size
10T4309-62	1/2 in	9,000	Aluminum	7.4 lb 3.36 kg	7.1 in 180 mm	1/2 in
10T4316-62	1/2 in	16,000	Aluminum	7.4 lb 3.36 kg	7.1 in 180 mm	1/2 in
10T4318-62	1/2 in	18,000	Aluminum	7.4 lb 3.36 kg	7.1 in 180 mm	1/2 in

All tools performance rated @ 90 psi / 620 kPa air pressure.
 Minimum Hose I.D.: 1/2 in / 12.7 mm
 Standard Equipment: Collet, applicable wrenches

DOTCO® 11-43 Series - Mountable Power Unit

18,000 RPM 1.7 hp (1.27 kW)

- Cool running pneumatic motor stays cool even under heavy load
- Flat top provides firm setting for changing cutters and making adjustments
- Smooth accurate cuts - assured by precision spindle



Cat. No.	Shank Diameter Capacity	Free Speed (rpm)	Type Housing	Weight	Length	Air Inlet Size
11T4309-62	1/2 in	9,000	Aluminum	5.5 lb 2.49 kg	7.1 in 180 mm	1/2 in
11T4316-62	1/2 in	16,000	Aluminum	5.5 lb 2.49 kg	7.1 in 180 mm	1/2 in
11T4318-62	1/2 in	18,000	Aluminum	5.5 lb 2.49 kg	7.1 in 180 mm	1/2 in

All tools performance rated @ 90 psi / 620 kPa air pressure.
 Minimum Hose I.D.: 1/2 in / 12.7 mm
 Standard Equipment: Collet, applicable wrenches

Router Assemblies

For use with Dotco 12-10, 12-20 and 12-25 series.

Tool Series	Cutter Shank Capacity	Part Number					
		Complete Attachment	Nose Housing	Bearing	Ring	Lock Nut	Router Housing
12-10	1/4"	14-2187	14-2176	14-0508	1098	14-2082	14-1180
12-20/12-25	1/4"	14-2180	14-2176	14-0508	1098	14-2082	14-2080
12-20/12-25	3/8"	14-2429	14-2426	14-0533	1068	14-2082	14-2080
12-12/12-22/12-27	1/4"	7197		14-0508	1098	N/A	N/A



For use with Dotco 12-40 series.

Tool Series	Cutter Shank Capacity	Part Number		
		Nose Housing	Bearing	Retaining Ring
12-40	1/4"	4272	14-0508	1098
12-40	3/8"	4263	14-0533	1068

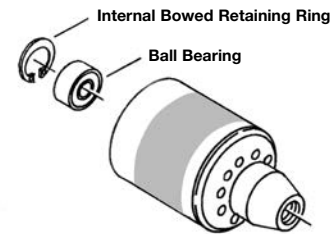

Router Guides

For use on Dotco 12-10, 12-20, 12-20, 12-25 and 12-40 series.

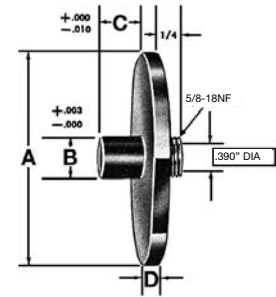
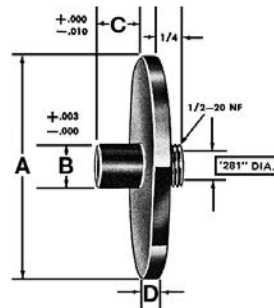
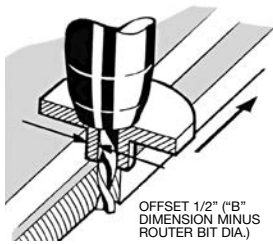

The minimum router bit length (Overall Length) to be used is determined by the formula:
 OAL = 1-13/16"+C+P (series 12-10);
 OAL = 2"+C+P (series 12-20 & 12-25). "C" is the "C" dimension of the router guide and "P" is the desired protrusion of the router bit.

Important: Insert bit into collet as far as possible, then pull out 1/16" and tighten collet.

In an emergency, if it is necessary to pull out the bit more than 1/4", be sure to insert a short length of blank shank (not to exceed 5/8" long) in the bottom of the collet before inserting the bit.

Part Number	Dimensions (in.)			
	A	B	C	D
For Router Bits with 1/4" Shanks				
14-2703	3/4	3/8	1/2	1/8
14-2400	1	3/8	1/8	1/8
14-2401	1	3/8	1/4	1/8
14-2402	1	3/8	3/8	1/8
14-2406	1	7/16	1/8	1/8
14-2407	1	7/16	1/4	1/8
14-2408	1	7/16	3/8	1/8
14-2411	1	1/2	1/4	1/8
14-2412	1	1/2	1/2	1/8
14-2413	1	1/2	5/8	1/8
14-2414	1	1/2	3/4	1/8
14-2417	1	9/16	1/8	1/8
14-2420	1	5/8	1/8	1/8
14-2421	1	5/8	5/8	1/8
14-2500	1 1/2	3/8	1/8	1/8
14-2501	1 1/2	3/8	1/4	1/8
14-2502	1 1/2	3/8	3/8	1/8
14-2505	1 1/2	7/16	1/8	1/8
14-2506	1 1/2	7/16	1/4	1/8
14-2507	1 1/2	7/16	3/8	1/8
14-2510	1 1/2	1/2	1/4	1/8
14-2511	1 1/2	1/2	3/8	1/8
14-2512	1 1/2	1/2	1/2	1/8
14-2600	2 1/2	1/2	1/2	3/16

Part Number	Dimensions (in.)			
	A	B	C	D
For Router Bits with 3/8" Shanks				
14-2531	1 1/2	1/2	3/8	1/8
14-2538	1 1/2	1/2	1/2	1/8
14-2539	1 1/2	1/2	5/8	1/8
14-2540	1 1/2	9/16	3/8	1/8
14-2541	1 1/2	9/16	1/2	1/8
14-2542	1 1/2	9/16	5/8	1/8
14-2893	1 1/2	5/8	3/8	1/8
14-2925	1 1/2	5/8	1/2	1/8
14-2544	1 1/2	5/8	5/8	1/8
14-2240	2 1/2	1/2	3/8	1/8
14-2632	2 1/2	1/2	1/2	1/8
14-2633	2 1/2	1/2	5/8	1/8
14-2634	2 1/2	9/16	3/8	1/8
14-2630	2 1/2	9/16	1/2	1/8
14-2635	2 1/2	9/16	5/8	1/8
14-2243	2 1/2	5/8	3/8	1/8
14-2636	2 1/2	5/8	1/2	1/8
14-2631	2 1/2	5/8	5/8	1/8

DOTCO 10-43 Series Router Template Guides

Part Number	Dimensions in Inches			For Use w/Router Bits Up To:
	A	B	C	
14-4019	5/16	3/8	3/16	1/4"
14-4020	3/8	7/16	5/16	5/16"
14-4021	9/16	5/8	3/16	1/2"

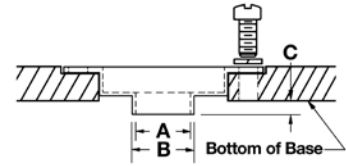

Rivet Trimmer Attachment

For use on Dotco 12-12 series front or rear exhaust collet models.

Trims "pop" or "blind" rivets up to 3/16" diameter, also suitable for shaving small welds.

Micrometer adjustment controls height of cut to .001". Runner pads minimize scratching of the work surface.

Part No.	Diameter	Shank	Length	Description	Recommended Use
Trimmer					
14-1723					
Cutters					
14-1732	3/4"	1/4"	1 7/8"	Inverted Cone, carbide	Steel Rivets
14-1332	1/2"	1/4"	1 7/8"	Cylindrical, carbide	Shaving welds



Two Handed Router Base

Use with front or rear exhaust collet models.

Two handed control for router applications.

Easy depth adjustment.

Can also be used with 10-43 template guides.

Cutters: 14-2442 (combination flush/bevel 22°)

Part Number	Series
14-1577	Dotco 12-10 Series
14-2577	Dotco 12-20 & 12-25 Series



Laminate Trimmer Attachment

Part Number	Series
14-1178	Dotco 12-10 Series
14-2178	Dotco 12-20 & 12-25 Series



DOTCO® 12-22 Series

14,000 RPM 0.6 hp (0.45 kW)

- Available in right angle or inline
- Compact and easy to use
- Excellent control and high productivity with minimum fatigue
- Easy to change blades
- Adjustable depth control



Cat. No.	Free Speed (rpm)	Configuration	Saw Blade Capacity	Maximum Depth of Cut	Type Housing	Weight	Length	Air Inlet Size
12L2240-90	14,000	Right Angle	2.5"	9/16 in	Composite	2.3 lb 1.04 kg	10.9 in 277 mm	1/4 in
12L2065-90	14,000	Inline	2.5"	9/16 in	Composite	2.1 lb 0.95 kg	8.9 in 226 mm	1/4 in

All tools performance rated @ 90 psi / 620 kPa air pressure.
Minimum Hose I.D.: 5/16 in / 7.9 mm
Standard Equipment: Applicable wrenches, oilless blades

DOTCO® 12-12 Series - Saw

2,400 - 20,000 RPM 0.3 hp (0.22 kW)

- Vacuum ready
- Compact and easy to use
- Easy to change blades
- Adjustable depth control



Cat. No.	Exhaust	Free Speed (rpm)	Saw Blade Capacity	Maximum Depth of Cut	Type Housing	Weight	Length	Air Inlet Size
12S1288-02	Rear	2,400	2.0"	7/16 in	Composite	1.6 lb 0.73 kg	8.9 in 226 mm	1/4 in
12S1289-02	Rear	3,600	2.0"	7/16 in	Composite	1.6 lb 0.73 kg	8.9 in 226 mm	1/4 in
12S1206-02	Front	12,000	2.0"	7/16 in	Composite	1.3 lb 0.59 kg	7.1 in 180 mm	1/4 in
12S1273-03	Vacuum Ready	12,000	2.0"	7/16 in	Composite	2.3 lb 1.04 kg	7.1 in 180 mm	1/4 in
12S1282-02	Rear	12,000	2.0"	7/16 in	Composite	1.3 lb 0.59 kg	7.1 in 180 mm	1/4 in
12S1207-02	Front	20,000	2.0"	7/16 in	Composite	1.3 lb 0.59 kg	7.1 in 180 mm	1/4 in
12S1274-03	Vacuum Ready	20,000	2.0"	7/16 in	Composite	2.3 lb 1.04 kg	7.1 in 180 mm	1/4 in
12S1283-02	Rear	20,000	2.0"	7/16 in	Composite	1.3 lb 0.59 kg	7.1 in 180 mm	1/4 in

All tools performance rated @ 90 psi / 620 kPa air pressure.
Minimum Hose I.D.: 1/4 in / 6.4 mm
Standard Equipment: Applicable wrenches, oilless blades

DOTCO® 12-27 Series - Saw

940 - 11,000 RPM 0.9 hp (0.67 kW)

- Compact and easy to use
- Excellent control and high productivity with minimum fatigue
- Easy to change blades



Cat. No.	Exhaust	Free Speed (rpm)	Saw Blade Capacity	Maximum Depth of Cut	Type Housing	Weight	Length	Air Inlet Size
12S2790-02	Rear	430	4 in	1 in	Composite	6.2 lb 2.81 kg	16.2 in 411 mm	1/4 in
12S2792-02	Rear	940	3.375 in	1 in	Composite	6.2 lb 2.81 kg	16.2 in 411 mm	1/4 in
12S2793-02	Rear	3,200	4 in	1 in	Composite	5.2 lb 2.36 kg	14.5 in 368 mm	1/4 in
12S2794-01	Rear	4,700	2.5 in	9/16 in	Composite	4.6 lb 2.09 kg	13.2 in 335 mm	1/4 in
12S2794-02	Rear	4,700	3.375 in	1 in	Composite	5.2 lb 2.36 kg	14.5 in 368 mm	1/4 in
12S2774-02	Vacuum Ready	7,000	3.375 in	1 in	Composite	6.5 lb 2.95 kg	14.1 in 358 mm	1/4 in
12S2775-01	Vacuum Ready	8,500	4 in	1 in	Composite	7.2 lb 3.27 kg	14.1 in 358 mm	1/4 in
12S2775-03	Vacuum Ready	8,500	4 in	1 in	Composite	6.5 lb 2.95 kg	14.1 in 358 mm	1/4 in
12S2748-01	Front	9,000	4 in	1 in	Composite	4.8 lb 2.18 kg	11.4 in 290 mm	1/4 in
12S2749-01	Front	11,000	3.375 in	1 in	Composite	4.8 lb 2.18 kg	11.4 in 290 mm	1/4 in

All tools performance rated @ 90 psi / 620 kPa air pressure.
 Minimum Hose I.D.: 5/16 in / 7.9 mm
 Standard Equipment: Applicable wrenches, oilless blades, 3/4 in Arbor adapter

DOTCO® 12-42 Series - Saw

5,800 - 8,600 RPM 1.7 hp (1.27 kW)

- Adjustable depth control
- Easy to change blades
- Compact and easy to use



Cat. No.	Exhaust	Free Speed (rpm)	Saw Blade Capacity	Maximum Depth of Cut	Type Housing	Weight	Length	Air Inlet Size
12S4216-01	Front	5,800	4.0"	1 in	Composite	7.9 lb 3.58 kg	15.5 in 394 mm	1/4 in
12S4217-01	Front	7,200	4.0"	1 in	Composite	7.9 lb 3.58 kg	15.5 in 394 mm	1/4 in
12S4225-01	Vacuum with PortaBag	8,500	4.0"	1 in	Composite	9.9 lb 4.49 kg	17.0 in 432 mm	1/4 in
12S4225-02	Vacuum with Floor Bag	8,500	4.0"	1 in	Composite	9.2 lb 4.17 kg	17.0 in 432 mm	1/4 in
12S4218-01	Front	8,600	4.0"	1 in	Composite	7.9 lb 3.58 kg	15.5 in 394 mm	1/4 in
12S4225-03	Vacuum Ready	8,500	4.0"	1 in	Composite	9.2 lb 4.17 kg	17.0 in 432 mm	1/4 in

All tools performance rated @ 90 psi / 620 kPa air pressure.
 Minimum Hose I.D.: 1/2 in / 12.7 mm
 Standard Equipment: Applicable wrenches, oilless blades, 3/4 in Arbor adapter



14-1891



14-2928



14-2700

Part Number	Diameter	Type	Maximum Depth & Width of Cut	Maximum rpm	Recommended Use (Guidelines only)
-------------	----------	------	------------------------------	-------------	-----------------------------------

Saw Blades – 1/4" arbor hole

14-1875	1 1/4"	High Speed Steel 22 Teeth	3/32" x 1/16"	12,000	Aluminum, Laminated Plastics, Pressed Board, Wood
14-0930	1 1/4"	High Speed Steel 44 Teeth	3/32" x 1/16"	12,000	Aluminum, Laminated Plastics, Pressed Board, Wood
14-1895	1 1/2"	High Speed Steel 22 Teeth	7/32" x 1/16"	12,000	Aluminum, Laminated Plastics, Pressed Board, Wood
14-1890	2"	High Speed Steel 22 Teeth	7/16" x 1/16"	12,000	Aluminum, Laminated Plastics, Pressed Board, Wood
14-1891	2"	High Speed Steel 44 Teeth	7/16" x 1/16"	12,000	Aluminum, Laminated Plastics, Pressed Board, Wood
14-1892	2"	High Speed Steel 60 Teeth	7/16" x 1/16"	12,000	Aluminum, Laminated Plastics, Pressed Board, Wood
14-1396*	1 1/2"	Carbide Chip 36/80 Grit	7/32" x 3/32"	20,000	Fiberglass, Rubber
14-1395*	2"	Carbide Chip 36/80 Grit	7/16" x 3/32"	20,000	Fiberglass, Rubber
14-1398*	1 1/2"	Diamond Chip 40/60 Grit	7/32" x 5/64"	20,000	Fiberglass, Rubber
14-1400*	2"	Diamond Chip 40/60 Grit	7/16" x 5/64"	20,000	Fiberglass, Rubber, Carbon Fiber

*CAUTION: Use only for sawing non-metallic materials.

Part Number	Diameter	Type	Maximum Depth of Cut	Use With Model	Recommended Use Up To (Guidelines only)
-------------	----------	------	----------------------	----------------	---

Saw Blades – 7/16" arbor hole

14-2147	2 1/2"	High Speed Steel 44 Teeth	9/16"	12S2794-01	1/4" Aluminum, 1/2" Plywood, 1/2" Phenolic
14-2146	2 1/2"	High Speed Steel 80 Teeth	9/16"	12S2793-01	16 Gauge Steel
14-2928	3 3/8"	High Speed Steel 60 Teeth	15/16"	12S2794-02	1/4" Aluminum, 1/2" Plywood, 1/2" Phenolic
14-2929	3 3/8"	High Speed Steel 80 Teeth	15/16"	12S2792-02	20 Gauge Steel, Paneling, Plywood
14-1887	2"	High Speed Steel 22 Teeth	7/16" x 1/16"	12S1288-04	Aluminum, Laminated Plastics, Pressed Board, Wood
14-1888	2"	High Speed Steel 44 Teeth	7/16" x 1/16"	12S1288-04	Aluminum, Laminated Plastics, Pressed Board, Wood
14-1889	2"	High Speed Steel 60 Teeth	7/16" x 1/16"	12S1288-04	Aluminum, Laminated Plastics, Pressed Board, Wood

Part Number	Diameter	Type	Maximum Depth & Width of Cut	Recommended Use (Guidelines only)
-------------	----------	------	------------------------------	-----------------------------------

Saw Blades – 3/4" arbor hole

14-2701*	4"	Carbide Chip 36/80 Grit**	1" x 1/8"	Fiberglass, Hard Rubber
14-2694*	4"	Carbide Chip 36 Grit	1" x 11/64"	Hard Rubber
14-2697*	4"	Carbide Chip 80 Grit	1" x 1/8"	Fiberglass
14-2699*	4"	Carbide Tip 20 Teeth	1" x 7/64"	Thin Fiberglass, Plastic Laminates to 1/8" thick
14-2700*	4"	Carbide Tip 20 Teeth	1" x 7/64"	Thicker Fiberglass, Plastic Laminates to 1/2" thick
14-2710	4"	Carbide Tip 20 Teeth	1" x 7/64"	Thin non-ferrous material (to approx. 1/8" thick)
14-2711	4"	Carbide Tip 12 Teeth	1" x 7/64"	Thicker non-ferrous material (to approx. 1/2" thick)
14-2690*	4"	Diamond Chip 60/80 Grit	1" x 5/64"	Fiberglass, Composite, Carbon Fiber

*CAUTION: These carbide chip and tip and diamond blades are not to be used on metallic materials.

**Slim blade for easy cutting of fiberglass, with minimum dust -36 grit on periphery and 80 grit on the sides.



14-1742

Part Number	Diameter	Type	Maximum Depth & Width of Cut	Recommended Use (Guidelines only)
Saw Blades – Dotco oscillating saws with 3/8" arbor hole				
14-1740*	2"	Carbide Chip 36/80 Grit	7/16" x 3/32"	Fiberglass
14-1741*	2"	Diamond Chip 40/60 Grit	7/16" x 5/64"	Fiberglass, Carbon Composites
14-1742	2 1/2"	Stainless Steel 124 Teeth	9/16" x 3/64"	Wood, Uncured or Cured Composites, Aluminum, Plastic
14-1746	2 1/2"	Flush Stainless 124 Teeth	9/16" x 3/64"	Wood, Uncured or Cured Composites, Aluminum, Plastic
14-1743	2 1/2"	Carbide 120 Teeth	9/16" x 1/16"	Cured Graphic Composites
14-1744	2 1/2"	Razor	9/16" x 3/64"	Cardboard, Light Plastic
14-1745	2 1/2"	Stainless Steel 120 Teeth	9/16" x 3/64"	Confined Space
14-1747	3"	Razor	9/16" x 3/64"	Cardboard, Light Plastic

*Use only for sawing non-metallic materials.



Vacuum Conversion Kits

DOTCO 12-27 series

To convert an existing Dotco front exhaust series 12-27 saw to Vacuum operation, order any of the conversion kits listed in the table. Refer to the Vacuum Ready models listed on page 101 as a guideline to selection. NOTE: When converting to vacuum, free speed of the tool will be reduced 20%.

Part Number	Converts front exhaust to this configuration
2704	Option 1 – Porta Bag
2705	Option 2 – Floor Bag
2729	Option 3 – Vacuum System Adapter

DOTCO 12-42 series

To convert an existing Dotco front exhaust series 12-42 saw to Vacuum operation, order any of the conversion kits listed in the table. Refer to the Vacuum Ready models listed on page 102 as a guideline to selection. NOTE: When converting to vacuum, free speed of the tool will be reduced 20%.

Part Number	Converts front exhaust to this configuration
4131	Option 1 – Porta Bag
4132	Option 2 – Floor Bag
4133	Option 3 – Vacuum System Adapter

Cleco® SC3A Series - Triple Scaler

- Piston Type
- For maximum material removal
- Heavy duty, rugged application



Cat. No.	Bore	Stroke	Type Housing	Blows Per Minute	Weight	Length	Air Inlet Size
SC3A	0.88 in	0.81 in	Aluminum	5,200	7.9 lb 3.58 kg	13.3 in 338 mm	3/8 in

All tools performance rated @ 90 psi / 620 kPa air pressure.
 Minimum Hose I.D.: 3/8 in / 9.6 mm
 Standard Equipment: Operating instructions & service manual

Cleco® B1 Series - Lever Start - Needle Scaler

- Built-in Chisel Retainer
- Front Exhaust
- Lever Start
- Needle Type



Cat. No.	Bore	Abrasive Capacity	Stroke	Type Housing	Blows Per Minute	Weight	Length	Air Inlet Size
B1-CNB-LT-RD	1.0 in	5" needles standard, 7" needles optional	1.1 in	Steel	4,600	6.3 lb 2.86 kg	15.0 in 381 mm	1/4 in

All tools performance rated @ 90 psi / 620 kPa air pressure.
 Minimum Hose I.D.: 5/16 in / 7.9 mm
 Standard Equipment: Operating instructions & service manual

Cleco® B1 Series - Lever Start - Needle Scaler Kit

- Kit Includes B1-CNB-LT-RD scaler, whip hose, extra set of needles, two chisels, extra chisel retainer, retainer parts and metal case.



Cat. No.	Bore	Abrasive Capacity	Stroke	Type Housing	Blows Per Minute	Weight	Length
B1-CNB-LT-RD-K	1.0 in	5" needles standard, 7" needles optional	1.1 in	Steel	4,600	6.3 lb 2.86 kg	15.0 in 381 mm

All tools performance rated @ 90 psi / 620 kPa air pressure.
 Minimum Hose I.D.: 5/16 in / 7.9 mm
 Standard Equipment: Operating instructions & service manual

Cleco® B1 Series - Push-Pull Start - Chisel Scaler

- Built-in Chisel Retainer
- Chisel Type



Cat. No.	Bore	Abrasive Capacity	Stroke	Type Housing	Blows Per Minute	Weight	Length	Air Inlet Size
B1-C-PT	1.0 in	1/2" square stock	1.1 in	Steel	4,600	4.3 lb 1.95 kg	12.0 in 305 mm	1/4 in

All tools performance rated @ 90 psi / 620 kPa air pressure.
 Minimum Hose I.D.: 5/16 in / 7.9 mm
 Standard Equipment: Operating instructions & service manual

Cleco® B Series - Lever Start - Chisel Scaler

- Built-in Chisel Retainer
- Chisel Type



Cat. No.	Bore	Abrasive Capacity	Stroke	Type Housing	Blows Per Minute	Weight	Length	Air Inlet Size
B1-C-LT	1.0 in	1/2" Square Stock	1.1 in	Steel	4,600	4.3 lb 1.95 kg	10.3 in 262 mm	1/4 in
BR-C-LT	1.0 in	5/8 round stock	1.1 in	Steel	4,200	4.3 lb 1.95 kg	10.4 in 264 mm	1/4 in

All tools performance rated @ 90 psi / 620 kPa air pressure.
 Minimum Hose I.D.: 5/16 in / 7.9 mm
 Standard Equipment: Operating instructions & service manual

Cleco® CH30 Series Chipping Hammer

- Heavy duty for rugged use
- Ring valve hard hitting hammer
- Forged steel hammer
- Heat treated cylinder & piston for reduced wear
- Replaceable bushing



Cat. No.	Bore	Abrasive Capacity	Stroke	Type Housing	Blows Per Minute	Weight	Length	Air Inlet Size
CH-30-HX	1.125 in	.580 Hex	2.5 in	Aluminum	2,200	15.0 lb 6.80 kg	17.7 in 450 mm	3/8 in
CH-30-HX-QC	1.125 in	.580 Hex	2.5 in	Aluminum	2,200	15.0 lb 6.80 kg	17.7 in 450 mm	3/8 in
CH-30-RD	1.125 in	.680 Round Shank	2.5 in	Aluminum	2,200	15.0 lb 6.80 kg	17.7 in 450 mm	3/8 in
CH-30-RD-QC	1.125 in	.680 Round Shank	2.5 in	Aluminum	2,200	15.0 lb 6.80 kg	17.7 in 450 mm	3/8 in

All tools performance rated @ 90 psi / 620 kPa air pressure.
 Minimum Hose I.D.: 1/2 in / 12.7 mm
 Standard Equipment: Operating instructions & service manual

Cleco® F Series - Round Taper Nose Riveter

- For driving 1/8"-1/4" (3-6 mm) rivets
- Standard beehive retainer
- Built-in air regulator controls power output
- Spool valve for precise speed control



Cat. No.	Bore	Abrasive Capacity	Stroke	Type Housing	Blows Per Minute	Weight	Length	Air Inlet Size
F4-PT-RT-B	0.56 in	0.401 Rivet Set Shank Diameter	4.0 in	Aluminum	1,700	3.3 lb 1.50 kg	8.7 in 221 mm	1/4 in

All tools performance rated @ 90 psi / 620 kPa air pressure.
 Minimum Hose I.D.: 1/4 in / 6.4 mm
 Standard Equipment: Operating instructions & service manual

B1 Series Chisels (Safety Retainer Type)

Type	Cutting edge		Square Stock Size		Overall Length		Code Number
	in.	mm	in.	mm	in.	mm	
Hardened Blank	—	—	1/2	12.7	7 1/2	190	839052
Hardened Blank	—	—	1/2	12.7	12	305	839053
Cold Chisel	3/4	19	1/2	12.7	7 1/2	190	839051
Cold Chisel	3/4	19	1/2	12.7	12	305	839341
Cold Chisel	3/4	19	1/2	12.7	18	457	839335
Cold Chisel	1 1/2	38	1/2	12.7	8	203	839467
Spoon Chisel	1 3/8	35	1/2	12.7	7 1/4	184	839050
Spoon Chisel	1 3/8	35	1/2	12.7	12	305	839299
Spoon Chisel	1 3/8	35	1/2	12.7	18	457	839334
Spoon Chisel	1	25	1/2	12.7	7 1/4	184	839740



BR Series Chisels (Safety Retainer Type)

Type	Cutting Edge		Round Stock Size		Overall Length		Code Number
	in.	mm	in.	mm	in.	mm	
Blank	—	—	5/8	16	7 1/2	190	829173
Long Wide Blade	1 3/4 x 3/32	44.5 x 2.4	5/8	16	7	203	829165
Cold	3/4 x 3/32	19.1 x 2.4	5/8	16	8 1/2	216	829150
Scaling	1 1/4 x 3/32	31.8 x 2.4	5/8	16	9	229	829301
Spoon	1 3/8 x 3/32	34.9 x 2.4	5/8	16	7 1/2	190	829310



Cleco® 14CF Series - Rivet Shaver with Stabilizer

- Non-Reversible
- Optional stabilizer attachment



Cat. No.	Free Speed (rpm)	Abrasive Capacity	Weight	Length
14CFS60-95	29,000	0.0005 Cutter Adjustment	2.3 lb 1.04 kg	8.2 in 208 mm
14CFS60-98	29,000	0.00025 Cutter Adjustment	2.3 lb 1.04 kg	8.2 in 208 mm
14CNL60-95	20,000	0.0005 Cutter Adjustment	4.5 lb 2.04 kg	8.9 in 226 mm

All tools performance rated @ 90 psi / 620 kPa air pressure.
 Minimum Hose I.D.: 5/16 in / 7.9 mm
 Standard Equipment: Stabilizer and choice of skirt

Cutter Diameter Inches	Carbide Cutter	Part Number										
		Skirts		1" Extended Skirt			4" Extended Skirt			6" Extended Skirt		
		Std.	Wide	Adapter	Skirt	Assembly	Adapter	Skirt	Assembly	Adapter	Skirt	Assembly
5/16	-	14-4391	14-4401	-	-	-	-	-	-	-	-	-
3/8	14-4382	14-4392	14-4402	-	-	14-4532	14-4302	14-4312	14-4512	-	14-4372	14-4572
7/16	14-4383	14-4393	14-4403	14-4323	-	14-4533	14-4303	-	14-4513	14-4363	14-4373	14-4573
1/2	14-4384	14-4394	14-4404	14-4324	14-4334	14-4534	-	-	14-4514	14-4364	14-4374	14-4574
9/16	14-4385	14-4395	14-4405	-	-	-	-	-	-	-	-	-
5/8	14-4386	14-4396	14-4406	-	-	-	14-4306	14-4316	14-4516	-	-	-
3/4	14-4387	14-4397	-	-	-	-	-	-	-	-	-	-
1	14-4422	14-4410	-	-	-	-	-	-	-	-	-	-
1-1/4	-	14-4412	-	-	-	-	-	-	-	-	-	-

Cleco® 14CF Series - Shears & Scissors

- Industrial shears suitable for a variety of general industry applications



Cat. No.	Spindle Size	Abrasive Capacity	Type Housing	Weight	Length	Air Inlet Size
14CFS93-98	Scissor Shear	18 Gauge Steel-1/16" other material	Aluminum	2.4 lb 1.09 kg	9.8 in 249 mm	1/4 in
14CFS93-99	Standard Shear	18 Gauge Steel-1/16" other material	Aluminum	2.2 lb 1.00 kg	8.0 in 203 mm	1/4 in

All tools performance rated @ 90 psi / 620 kPa air pressure.
 Minimum Hose I.D.: 5/16 in / 7.9 mm
 Standard Equipment: Shear attachment and cutter blades

DOTCO® 12-20 Series - Nibbler

- Great for tight access application
- Suitable for general industry



Cat. No.	Capacity	Speed SPM	Type Housing	Weight	Length	Air Inlet Size
12L2062-96	18 ga. Mild Steel	6	Composite	1.1 lb 0.50 kg	8.3 in 211 mm	1/4 in

All tools performance rated @ 90psi / 620 kPa air pressure.

DOTCO® 12-10 Series - Lint Picker - 300 Series Collet

- Front or Rear Exhaust
- 6" or 9" pick rod
- Ideal for textile operation



Cat. No.	Exhaust	Capacity	Free Speed (rpm)	Type Housing	Weight	Length	Air Inlet Size
12L1010-36	Front	6" or 9" Picker Rod	20,000	Composite	0.75 lb 0.34 kg	4.8 in 122 mm	1/4 in
12L1031-36	Rear	6" or 9" Picker Rod	20,000	Composite	0.8 lb 0.36 kg	5.5 in 140 mm	1/4 in

All tools performance rated @ 90 psi / 620 kPa air pressure.

Minimum Hose I.D.: 1/4 in / 6.4 mm

Standard Equipment: Applicable collet, collet wrenches, 6" / 152 mm Picker Rod 14-2181

Overhose Assemblies

For use with Dotco series rear exhaust tools:

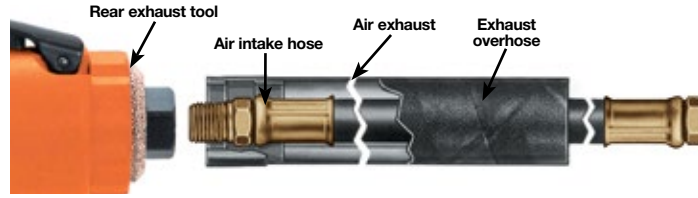

Tool Series	Overhose and Airhose	Non-Overhose to Overhose Conversion Kit	Overhose Only			Airhose Only		
			Number	Length		Number	Length	
				ft.	m		ft.	m
10-04	45-0946		45-0945	1.0	0.3	45-0948	5.0	1.5
	45-0953		45-0955	2.0	0.6	45-0948	5.0	1.5
	45-0954		45-0956	4.0	1.2	45-0948	5.0	1.5
12-03, 12-04	45-6013		45-6003	1.0	0.3	45-0948	5.0	1.5
	45-6012		45-6002	2.0	0.6	45-0948	5.0	1.5
	45-6000		45-6001	4.0	1.2	45-0948	5.0	1.5
10-10, 10-11, 10-12	45-1930		45-1904	2.0	0.6	45-1409	8.0	2.4
	45-1931		45-1901	4.0	1.2	45-1409	8.0	2.4
	45-1932		45-1902	8.0	2.4	45-1409	8.0	2.4
12-10, 12-11, 12-12		45-2783	45-2629	2.0	0.6	45-1408	8.0	2.4
12-13, 15LF, 15-14		45-2784	45-2687	4.0	1.2	45-1408	8.0	2.4
		45-2785	45-2688	8.0	2.4	45-1408	8.0	2.4
10-20, 10-21, 10-22		45-2786	45-2629	2.0	0.6	45-1508	8.0	2.4
10-25, 10-26, 10-27		45-2787	45-2687	4.0	1.2	45-1508	8.0	2.4
12-20, 12-21, 12-22		45-2788	45-2688	8.0	2.4	45-1508	8.0	2.4
12-25, 12-26, 12-27,								
12-28, 15LS, 15IN								
12-91			45-0974	4.0	1.2	01-9167	5.0	1.5
14CF			45-2687	4.0	1.2	45-1508	8.0	2.4
14CS			45-2687	2.0	0.6	45-1408	8.0	2.4
			45-2687	4.0	1.2	45-1408	8.0	2.4
			45-2688	8.0	2.4	45-1408	8.0	2.4
			45-2688	8.0	2.4	45-1408	8.0	2.4
14CN			45-2687	2.0	0.6	45-1508	8.0	2.4
			45-2687	4.0	1.2	45-1508	8.0	2.4
		1025687	45-2688	8.0	2.4	45-1508	8.0	2.4
			45-2688	8.0	2.4	45-1508	8.0	2.4

Airline Filter and Lubricator

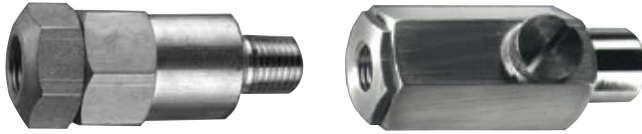

Part Number	Description	NPT in.	Air Flow		Max. Pressure	
			SCFM	m ³ /min	psig	bar
45-0211	Filter w/cartridge*	1/4	17	8.0	100	6.9
45-0212	Filter cartridge	-	-	-	-	-
45-0201	Lubricator**	1/4	22	10	100	6.9
45-0301	Lubricator**	3/8	22	10	100	6.9

GENERAL: Use where inconvenient for standard filter or lubricator.

* NOTE: Filter will not remove water.

** NOTE: One ounce reservoir good for an average eight hour shift.



Air Hoses

Part Number	Hose I.D.		Fittings (NPT)		Length	
	in.	mm	in.	mm	ft.	m
A110026	3/16	4.7	1/8	3/8-24*	6.0	1.8
A139856	3/16	4.7	1/8	1/8	6.0	1.8
45-1307	3/16	4.7	1/8	1/4	7.0	2.1
45-1408	1/4	6.4	1/4	1/4	8.0	2.4
45-1409	1/4	6.4	1/8	1/4	8.0	2.4
45-1508	5/16	7.9	1/4	1/4	8.0	2.4
45-1610	3/8	9.5	3/8	3/8	10	3.0
45-1810	1/2	12.7	3/8	1/2	10	3.0
45-1812	1/2	12.7	1/2	1/2	12	3.7
45-1825	1/2	12.7	1/2	1/2	25	7.6

GENERAL: 3/16" & 1/4" hoses have braided covers, all others have neoprene covers.

* NOTE: 3/8"-24 is a straight thread

Activeswivel

Part No.	NPT in.	Air Flow		Max. Pressure		Weight	
		SCFM	m ³ /min	psig	bar	lbs.	kg
SW-102	1/4	25	7.1	150	10.4	0.20	0.09
SW-103	3/8	45	12.7	150	10.4	0.40	0.18
SW-104	1/2	65	18.4	150	10.4	0.80	0.36
SWR-102*	1/4	25	7.1	150	10.4	0.25	0.11

* NOTE: Equipped with built-in flow regulator.



Swivel Hose Couplings

Part Number	NPT in.
A20744	1/4
A20741	3/8
A20764	1/2



Quick Disconnect Fittings

Fitting Type*	NPT in.	Nominal Size		
		1/4"	3/8"	1/2"

Coupler (male NPT)



1/8	45-0710	-	-
1/4	45-0711	45-0713	-
3/8	45-0712	-	-
1/2	-	-	45-0717

Coupler (female NPT)



1/4	-	-	-
3/8	45-0732	45-0734	45-0736

Nipple (male NPT)



1/8	45-0720	-	-
1/4	-	45-0724	-
3/8	45-0722	45-0725	45-0726
1/2	-	-	45-0727

Nipple (female NPT)



1/4	-	45-0744	-
3/8	45-0742	45-0745	45-0746
1/2	-	-	45-0747

Nipple (with hose barbs)



1/4**	45-0748	-	-
1/2**	-	-	45-0753

* NOTE: Nipples of one size will not fit couplers of another size.

** NOTE: Indicates inside diameter of hose.

NOTE: 1/4" nominal will pass 49 cfm free air @ 90 psi, but pressure drop exceeds 10 psi with air flow over 30 cfm.

3/8" nominal will pass 90 cfm free air @ 90 psi, but pressure drop exceeds 10 psi with air flow over 53 cfm.

1/2" nominal will pass 168 cfm free air @ 90 psi, but pressure drop exceeds 10 psi with air flow over 109 cfm.

Steel Handle Bushings

Part Number	Size
881276*	1/4 in. MPT x 1/4 in. FPT
841554†	1/4 in. MPT x 1/4 in. FPT
841553	3/8 in. MPT x 1/4 in. FPT
841552	3/8 in. MPT x 3/8 in. FPT

* Light duty for rotary tools

† Heavy duty for percussion tools.

Lubricants

Part Number	Size	Description	M.S.D.S. No.
Oils			
540397	1 qt. plastic	Air line oil	CPT-153
533485	1 gal. metal	Air line oil	CPT-153
536333	1 gal. metal	High film strength	CPT-154
45-0918	1 qt. plastic	Air line oil (<i>Dotco</i>)	CPT-155
45-0919	1 gal metal	Air line oil (<i>Dotco</i>)	CPT-155
539317	1 qt. plastic	Hydraulic oil (<i>Pulse</i>)	CPT-157
Greases			
513156	18 oz. can	Teflon grease	CPT-145
45-0983	2 oz. tube	Dotco gear grease	CPT-147
45-0980	2 oz. tube	Dotco gear lube	CPT-148

NOTE: Under normal conditions of use, lubrication products sold separately for or used within these tools should not cause an exposure hazard. Refer to the Material Safety Data Sheet (M.S.D.S.) for Safety and Disposal information. M.S.D.S. sheets shown in the chart are available upon request.

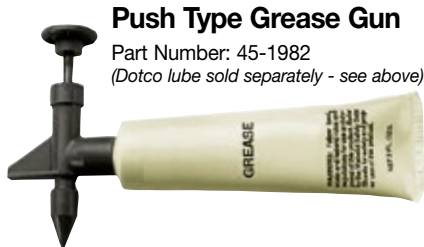

Push Type Grease Gun

Part Number: 45-1982
(*Dotco lube sold separately - see above*)

Service Tools

"T" Wrenches

Part Number	Description
1021202	3/16" Hex socket screws

To remove and replace hex socket screws in tool housings.

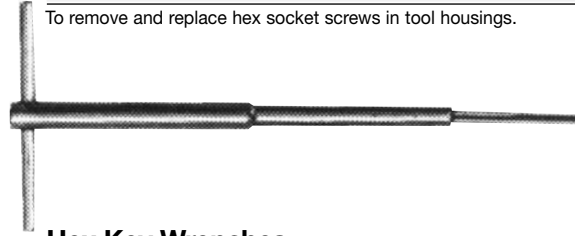

Hex Key Wrenches

Part Number	Description
1008860	1/8"
1006443	3/16"

Open End Wrenches

Part Number	Description
1006626	3/6" & 5/16"
1011691	7/16"
1014471	1/2"
1004958	9/16" & 1-33/64" Hex Box
1014472	11/16"
1010911	7/8"
1016694	1-1/8"

Snap Ring Pliers

Part Number	Description
1007488	External sizes 25 thru 87



Part Number	Description
1008702	External sizes 37 thru 93



Order Catalogs & Literature On-Line

Apex Tool Group covers a wide range of industrial markets, including aerospace, automotive, foundries, furniture, general industry, metal fabrication, petroleum, power generation, shipbuilding, and transportation. These markets have been served by Apex Tool Group's brands for many decades, by offering our customers solutions and products that meet their demanding productivity requirements.



Apex Fastener Tools

A comprehensive line of industrial quality bits, finders, sockets and extensions.

www.apexpowertools.com



Dotco/Cleco Material Removal Tools

A full line of pneumatic material removal tools including drills, sanders, and grinders.

www.apexpowertools.com



Master Power Industrial Air Tools

A complete line of industrial pneumatic tools for assembly and material removal applications.

www.apexpowertools.com



Apex Universal Joints

Industrial quality universal joints that can be custom designed for most any application.

www.apexpowertools.com



Cleco Power Motors

A comprehensive line of industrial pneumatic motors for a multitude of applications.

www.apexpowertools.com



Utica Torque Products

A full line of torque measuring products including torque screwdrivers, torque wrenches and analyzers.

www.apexpowertools.com



Cleco Pneumatic Assembly Tools

A full line of industrial pneumatic assembly tools from screwdrivers to nutrunners to impacts.

www.apexpowertools.com



Cleco D.C. Electric Assembly Tools

A complete line of industrial D.C. electric assembly tools and controllers.

www.apexpowertools.com



Airetool Tube Cleaners & Expanders

A complete line of industrial tube cleaners, expanders and installation tools.

www.apexpowertools.com

