

DPR Progressivring

für EO 24° Anschluss

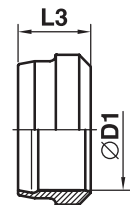

Progressivring:
DPR

| Reihe | D1 | L3 | Progressivring DPR Bestellzeichen | | PN (bar) | Gewicht g/St. |
|-------|--|---|---|--|---|---|
| | | | Edelstahl | Edelstahl SPH | | |
| | | | L | 06 08 10 12 15 18 22 28 35 42 | | |
| S | 06 08 10 12 16 20 25 30 38 | 9.0 9.0 9.5 9.8 9.5 12.5 12.5 12.5 13.0 | DPR06L71X DPR08L71X DPR10L71X DPR12L71X DPR16S71X DPR20S71X DPR25S71X DPR30S71X DPR38S71X | DPR06LSPH71X DPR08LSPH71X DPR10LSPH71X DPR12LSPH71X DPR16SSPH71X DPR20SSPH71X DPR25SSPH71X DPR30SSPH71X DPR38SSPH71X | 630 630 630 630 400 400 400 400 315 | 1.7 3.2 3.1 3.5 5.6 11.4 13.3 19.3 22.5 |

$$\frac{PN \text{ (bar)}}{10} = PN \text{ (MPa)}$$